



FOR SALE

DECEASED ESTATE - SINGLE LEVEL HOUSE WITH SEPARATE GRANNY FLAT

Built in 1960 this spacious, single level home comprises three very large built-in bedrooms, bathroom with separate bath, shower and dual flush toilet. The kitchen and breakfast bar have been upgraded, with an abundance of storage and appliance cupboards.

Main house
3 bedrooms and study
Bathroom
Separate toilet
Kitchen with breakfast bar
Dining area
Large living area

The granny flat is a completely separate building constructed in 1971 to a high standard.

Comprising
1 Bedroom
Living area
Bathroom
Kitchen
Private sun drenched patio for your morning cuppa.

This area is growing quickly so it would be wise to buy now. Just down the road is Geebung School. The area has many parks and bike trails and the house is situated in a very quiet and leafy, elevated street. City views are seen from the street.

Offers over \$600,000

Rental appraisal available.

4 BED | 2 BATH | 2 CAR

PRICE:

Offers over \$600,000

OPEN FOR INSPECTION:

N/A



Anjanette Parker

0411526490

trent.parkermail@gmail.com

www.atrealty.com.au

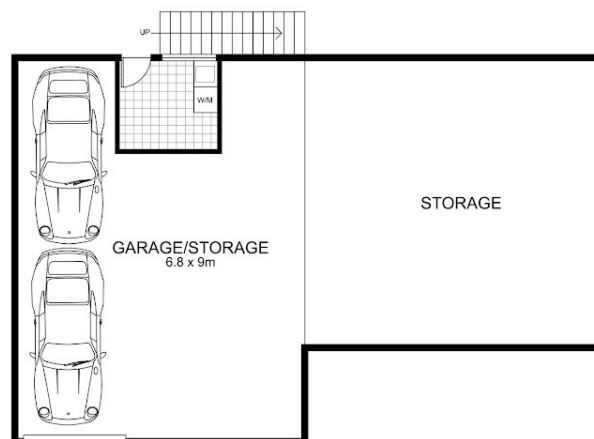

Floor plan measurements are approximate and for illustrative purposes only. Scale in metres.
Floor plan created by Rolley Photo Media. www.rolleyphotomedia.com.au

INTERNAL : 146m²
EXTERNAL : 29m²
GARAGE/STORAGE : 112m²
TOTAL AREA : 287m²



6 Lentz Street, Geebung

Disclaimer: Please note this floor plan is for marketing purposes and is to be used as a guide only. All dimensions are estimates only and may not be exact measurements.