

FOR SALE

EXCEPTIONAL VALUE BRICK VENEER HOME

"Auction Sunday 13/10/2019 @ 68 Sasses Ave Bayswater @ 1PM"

This beautifully maintained family home is situated close to Bayswater shopping precinct, schools, train station and bus routes within easy access to Knox Westfield and the Eastlink freeway, making this home perfect for the young or a growing family.

Set on approx. 730m2, this home features a huge family room to the rear with easy access to the outdoor entertaining area and back yard.

Features include; spacious lounge room, kitchen with breakfast bar, meals area and modern appliances, 3 generous bedrooms with built in robes, separate, family bathroom, laundry and toilet.

This much-loved home offers solar panels reducing energy cost, gas-ducted heating, air conditioning, ample storage, double garage, manicured gardens, fully fenced yard, off-street parking and so much more.

Hurry an inspection will delight!!

Thinking of selling now or in the future? For a free market appraisal Call Lou 0417-166-668 / Leeanne 0404-261 469 or email lou@atrealty.com.au

Statement of information will be available to inspect at the property.

Inspection times and property availability are subject to change without notice. Photo identification required at inspections. Disclaimer. All information contained herein is gathered from sources we believe to be reliable. We cannot however guarantee its accuracy and interested parties should make and rely on their own inquiries.

3 BED | 1 BATH | 2 CAR

PRICE:

Auction

OPEN FOR INSPECTION:

N/A



Lou Rinnovasi

0417166668

lou@atrealty.com.au

www.atrealty.com.au

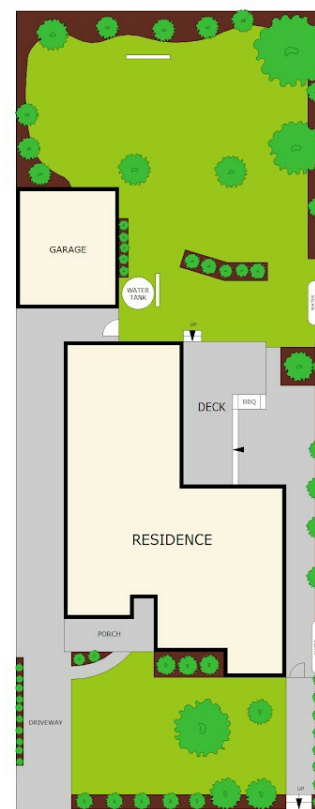
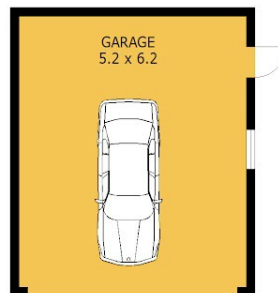

SITE PLAN

Residence	- 143 m ²
Garage	- 32 m ²
Deck	- 28 m ²
Porch	- 10 m ²
Total	- 213 m²



Scale in metres. Indicative only. Dimensions are approximate. All information contained herein is gathered from sources we believe to be reliable. However we cannot guarantee its accuracy and interested parties should rely on their own enquiries.

68 Sassas Avenue, Bayswater

Disclaimer: Please note this floor plan is for marketing purposes and is to be used as a guide only. All dimensions are estimates only and may not be exact measurements.