

SOLD

MASSIVE HOME, 4 LIVING AREAS

Contact your Local Agent Tricia 0457314206

On a generous Corner Block of 700 m2 (app) and with 2 driveways sit this versatile expansive home. Sea views peak through the trees in this restful location. Potential to build up and take advantage of panoramic views from the city to the sea. STCA

With a large lounge area on entry which leads to the enormous family room. The sun room has direct access to outside and is adjacent to the dining and bar area.

The kitchen is centrally located with a servery for your convenience.

The home comes complete with a very spacious Mastered bedroom and has specially made built in robes and dressing table. Bedrooms 2 and 3 also have BIRs and dressing table.

The family bathroom is a hop skip and a jump away and there is a second WC outside under the main roof next to a storage area.

The rumpus room has a good sized storage area well positioned with access from the rear and front of the home. If you work from home this could be a valuable space for a possible home office.

Air-conditioning, solar panels, solar hot water are just some of the many extras on offer.

Close to Marion Shopping Centre, transport and Schools

Come and let the family spread out!

3 BED | 1 BATH | 1 CAR

PRICE:
\$460,000

OPEN FOR INSPECTION:
N/A



Tricia Kernahan
0457314206
tricia@atrealty.com.au
tfkrealstate.com.au
RLA: 269823

21 Greenfield Road, Seaview Downs

Garden Shed

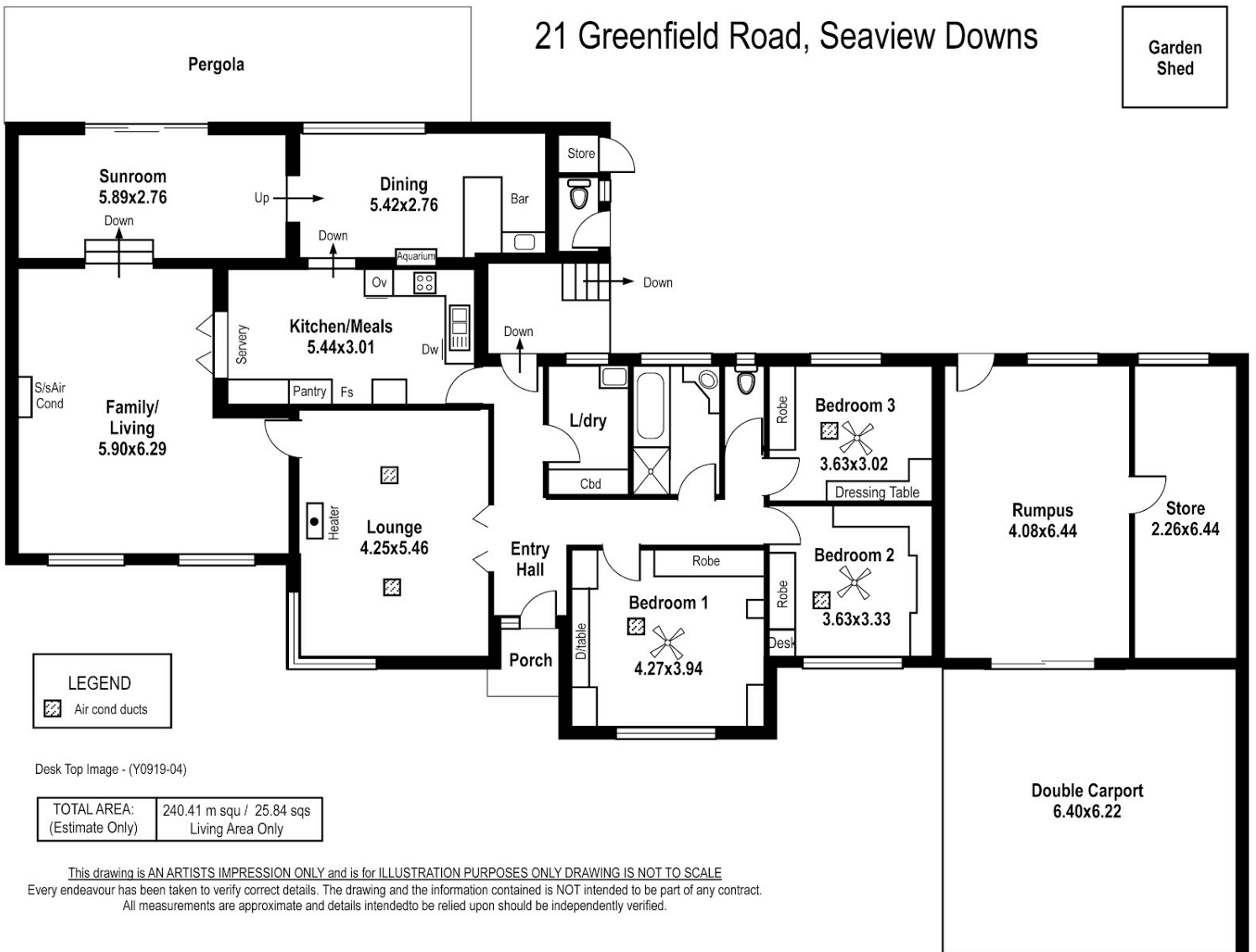

Disclaimer: Please note this floor plan is for marketing purposes and is to be used as a guide only. All dimensions are estimates only and may not be exact measurements.