



FOR SALE

ANOTHER SOLD BY GEOFF TUTT

This is a large family home built on a 700 sqm block and located just a few minutes' walk to the Pumicestone Passage where you will find the wading birds sanctuary, beach, boat ramp, barbeque facilities, children's playgrounds and more. The sunsets over Pumicestone Passage to the Glass House Mountains are something to behold!

The home has four bedrooms, open plan living/kitchen/dining, media room, children's playroom/study, office or additional living area, two bathrooms and double garage. There is also side access for a boat and trailer. Three of the bedrooms in this home are located towards the front of the home leading off the children's playroom/study. The master bedroom features double sinks with Caesar stone bench tops, double shower and large walk-in robe. There are sliding doors leading to the outdoor entertainment area.

The living area opens up to the covered outdoor entertainment area with its beautiful solar heated swimming pool and easy-care gardens. A great place to relax with family and friends after a busy day. Look at these additional features:

- Ducted air-conditioning & ceiling fans
- Security screens throughout
- Tinted windows
- Caesar stone bench tops throughout
- Walk-in linen cupboard
- 1.5 kws solar power & solar hot water
- Garden shed & water tank

Homes in this location do not last long on the market, so don't miss out, call Geoff (your local agent) on 0414 230 130 to arrange your private inspection today.

4 BED | 2 BATH | 2 CAR

PRICE:
SOLD BY GEOFF TUTT

OPEN FOR INSPECTION:
N/A



Geoff and Rose Tutt
0414230130
geoff@atrealty.com.au
www.atrealty.com.au

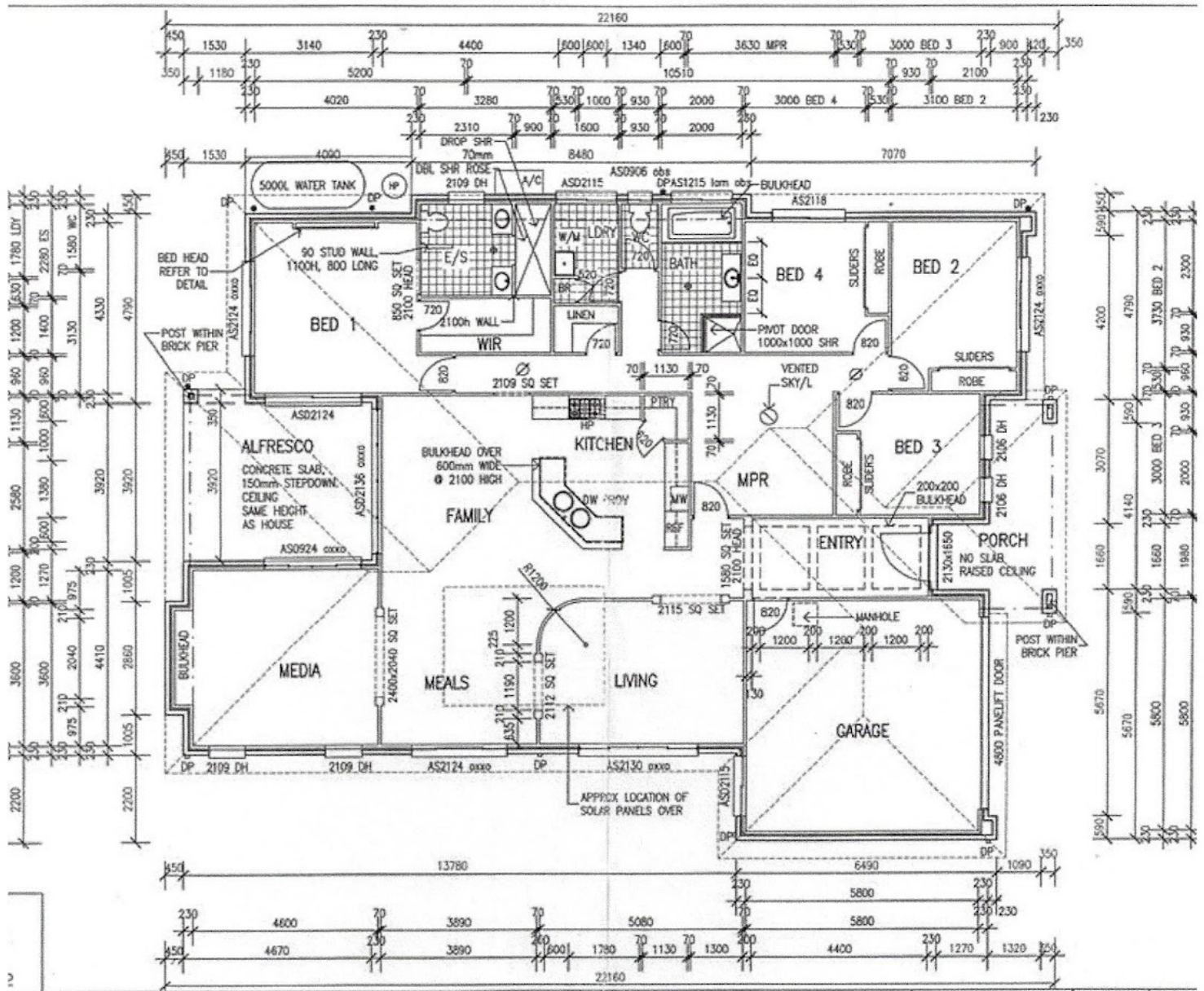

Disclaimer: Please note this floor plan is for marketing purposes and is to be used as a guide only. All dimensions are estimates only and may not be exact measurements.