



SOLD

PRIVACY AND SPACE IN SUBURBIA!

Set high amongst the treetops...
Private inspections available call or email to book yours.

This solid highset home has endless opportunities for expansion in a sought after elevated pocket with views and quality homes surrounding it. A private entry set on a 1333m2 fully fenced block, with space for additional sheds/garages, a granny flat and off street parking.

Upstairs lounge is spacious and open with lovely bushland views from all windows, including the adjoining modernised kitchen that includes ample storage, timber benchtops, induction cooktop and LG Dishwasher.

Summer entertaining is a breeze, with the generous sized rumpus room opening out to the pool, and offering a kitchenette and additional toilet for convenience.

Property features:

- 3 bedrooms all with ceiling fans
- Updated kitchen with induction cooktop, dishwasher
- electric blinds
- airconditioning for summer comfort
- Polished timber floors throughout upstairs
- inground swimming pool with insulated cover
- extra large lot with plenty of space for parking cars or to build a shed or a granny flat or extend the existing home- choice is yours
- 2 decks, main one flows from the living area and overlooks the pool area.
- separate laundry
- Security system
- Rumpus room with kitchenette and toilet
- Double carport + single garage
- Garden shed, water tank.

P.S This great entry level home has so much potential for a large or multi generational family to enjoy their privacy or spend time together. This popular location is close to the bus, shops, childcare and St Peters Catholic school and Redeemer Lutheran College. Easy access to the M1 motorway make travel to the city or the Coast a breeze.

3 BED | 1 BATH | 3 CAR

PRICE:
\$565,000

OPEN FOR INSPECTION:
N/A



Leanne Smith
0428750122

leannesmithproperty@atrealty.com.au
www.atrealty.com.au

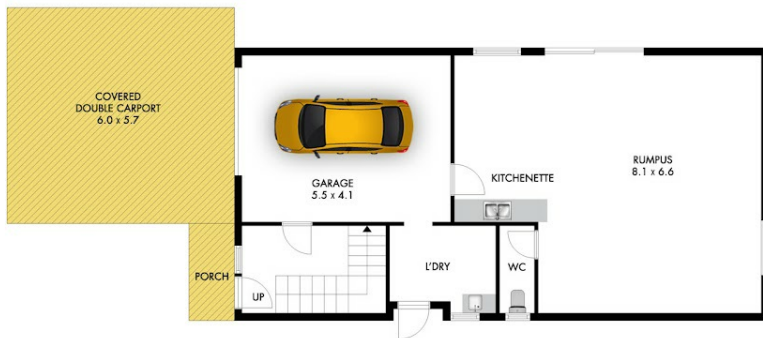

GROUND FLOOR
APPROX. FLOOR PLAN AREA IS 119M²



LIVING FLOOR
APPROX. FLOOR PLAN AREA IS 130M²



ALL MEASUREMENTS SHOWN OR IMPLIED ARE APPROXIMATE AND NO RESPONSIBILITY IS TAKEN FOR ANY ERROR, OR OMISSION, NOR IS ANY WARRANTY GIVEN. THESE PLANS ARE FOR ILLUSTRATIVE PURPOSES ONLY AND SHOULD BE USED SUCH. COPYRIGHT 2017. ALL RIGHTS RESERVED BY ABSTRACTVIEW.COM.AU

Disclaimer: Please note this floor plan is for marketing purposes and is to be used as a guide only. All dimensions are estimates only and may not be exact measurements.