



# SOLD

## FANTASTIC VALUE IN PERFECT LOCATION

This home brings style to contemporary family living. Perfectly situated on a 650sqm block, this timeless floor plan creates defined spaces for living, entertaining and sleeping. The stunning master bedroom offers peace and tranquillity, away from the bustle of the living areas. It features his & hers walk in robes, spacious en suite overlooking the resort style backyard with views over the golf course and ocean beyond.

Whether it's time to entertain or enjoy quality family time, you are spoilt for choice. There's the stunning open plan living area featuring high ceilings and glorious views, a gourmet kitchen with heaps of bench space, stainless steel appliances, butlers pantry and an adjoining laundry room, a separate spacious theatre room, all of which are decorated in modern neutral tones.

To complete the package this home also boasts a fantastic and well planned outdoor entertaining area, gardens and lawns are low key and easily maintained, the alfresco area has been carefully designed and extended to provide the perfect outdoor retreat overlooking the superb below ground swimming pool.

Other features include;

- Private walled front garden with security gate
- Gorgeous entrance hallway with shoppers access to oversized garage
- Fantastic family sized theatre room with dual access
- Spacious open plan casual living area, comprising meals, family and games areas
- Well designed kitchen with heaps of storage, oodles of bench space & stainless steel appliances inc Miele dishwasher & oven
- Separate spacious study/home office/nursery
- Gorgeous master bedroom, with his/hers walk in robes, large en-suite & views to pool area and beyond
- 3 further queen sized minor bedrooms with double built in robes to each
- Three way family bathroom with separate powder room & extra storage
- Sensational outdoor entertaining spaces, including built in bbq, under main roof alfresco & additional patio
- Below ground swimming pool with glass fencing and pool blanket
- Large grassed lawn area perfect for both kids & pets
- Ducted air conditioning throughout, gas hot water system
- Security fly screens to all doors
- Over sized double remote garage with store and rear access through roller to hardstand area
- Lawns and gardens are fully reticulated, there's even a garden shed

4 BED | 2 BATH | 2 CAR

PRICE:  
\$595,000

OPEN FOR INSPECTION:  
N/A



**Lisa Drylie**  
**0433048512**

[lisadrylie@atrealty.com.au](mailto:lisadrylie@atrealty.com.au)

[www.lisadrylierealestate.com](http://www.lisadrylierealestate.com)

# 31 Holloways Ridge SECRET HARBOUR



Block Size 650m<sup>2</sup> | 4 Bedrooms | 2 Bathrooms | 2 Car  
Internal 227.36m<sup>2</sup> | External 71.26m<sup>2</sup> | Total 298.62m<sup>2</sup>

Lisa Drylie | 0433 048 512

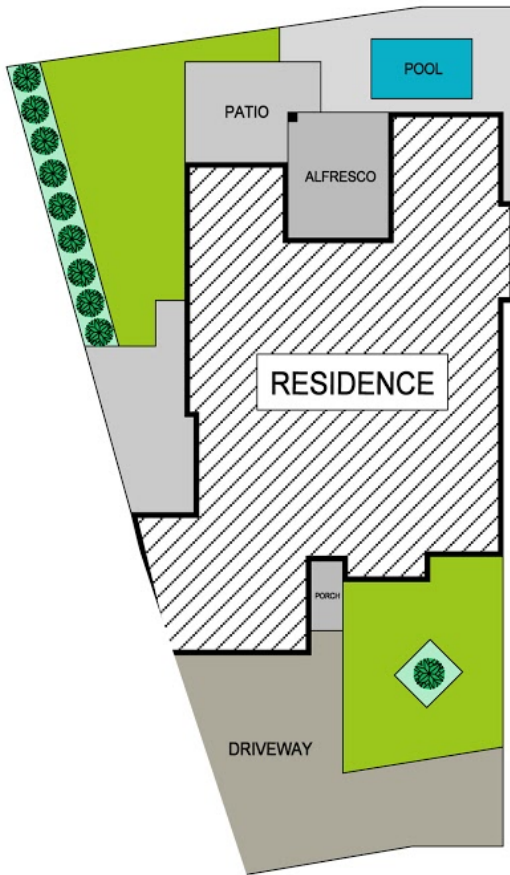

Disclaimer: Please note this floor plan is for marketing purposes and is to be used as a guide only. All dimensions are estimates only and may not be exact measurements.



REAL ESTATE FLOOR PLANS | [houseguru.com.au](http://houseguru.com.au) | © House Guru Real Estate Photography™

Whilst every attempt has been made to ensure the accuracy of the floor plan contained here, measurements of doors, windows, rooms and any other items are approximate and no responsibility is taken for error, omission or mis-statement. This plan is for illustrative purposes only and should only be used as such by any prospective purchaser. The services systems and appliances shown have not been tested and no guarantee as to their operability or efficiency can be given.

**Lisa Drylie**  
0433048512  
[lisdrylie@atrealty.com.au](mailto:lisdrylie@atrealty.com.au)  
[www.lisdrylierealestate.com](http://www.lisdrylierealestate.com)

