



SOLD

CALLING ALL HOME BUYERS - MOVE IN BEFORE EASTER

Under contract

Beautifully finished with a neutral colour scheme, you are located close to amazing restaurants, cafes, shopping as well as sporting facilities. Relax and appreciate the coolness of open plan living in this light and airy home. Designed by busy people with busy people in mind, this is a perfect home to raise your children. The air-conditioned living and dining area are open plan and filled with plenty of natural light.

The master's walk-in robe and ensuite will not disappoint. It's always nice to save time, and now you can reclaim your weekends with this low maintenance yard and garden.

- Short walk to parks, lake, private schools, public school and public transport
- Situated on a gently sloping, 375sqm corner block with colorbond fencing
- Tiled living area for easy maintenance
- 3 Large bedrooms, 1 with built-ins, ceiling fans plus carpet
- Family bathroom with separate bath and shower and floor tiles for easy maintenance
- Fully fenced and private yard with plenty of off-street parking
- Includes solar power supply
- Secure 1 car lock up garage

Words will simply not do; an inspection is a must! Call agent Mark Perera on 0417199875 or Carey Halfpapp on 0438 928 538 today to organise your private inspection!

Disclaimer: Information provided has been obtained in good faith and is to be used as a guide only. Atrealty nor the acting agent/s provide any guarantees, undertakings or warnings as to the accuracy, completeness or up-to-date nature of the information provided by the Vendor or other Persons. We urge all interested parties to undertake their own due diligence independent in determining whether or not this information is in fact accurate. The website may have filtered the property into a price bracket for website functionality purposes

3 BED | 2 BATH | 1 CAR

PRICE:
\$365,000

OPEN FOR INSPECTION:
N/A



Mark Perera
0417199875
markperera@atrealty.com.au
www.atrealty.com.au

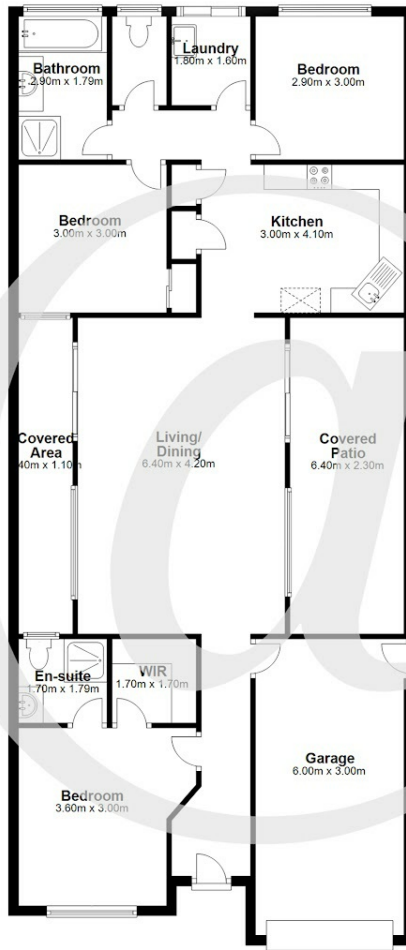

68 Jindabyne Circuit, Forest Lake, Qld 4078

Dimensions are approximate & therefore should only be used for illustrative purposes.

Total area: approx. 140.7 sq. metres

Disclaimer: Please note this floor plan is for marketing purposes and is to be used as a guide only. All dimensions are estimates only and may not be exact measurements.