



SOLD

CLOSING DATE SALE TUESDAY 3RD DEC (UNLESS SOLD PRIOR)

In a highly sought after location in the heart of Bayswater North sits this excellent family home or ideal investment property. With a spacious lounge room, dining room & family room, this property is ready to be called home.

This property is perfect for the young family or astute investor with the master bedroom featuring built in robes and ensuite with shower, hand basin and toilet, and a further 2 bedrooms which are serviced by the family bathroom with a bath, shower, hand basin, and a separate toilet. A spacious light filled lounge room, family room and dining area complete the property inside.

- * Evaporative cooling throughout
- * Double carport
- * Outdoor undercover entertainers area
- * Generous sized block of 845sqm (approx)
- * Walking distance to parks & kindergarten

Located within walking distance of Bayswater North Primary School and within close proximity of Canterbury Gardens Shopping Centre & buses

With so many features, plenty of space and an excellent location you'll need to be quick to snatch this property up. Inspect today!

3 BED | 2 BATH | 2 CAR

PRICE:
\$660,000

OPEN FOR INSPECTION:
N/A



George Shehata
0452460733
george.shehata@atrealty.com.au
www.atrealty.com.au

SHED

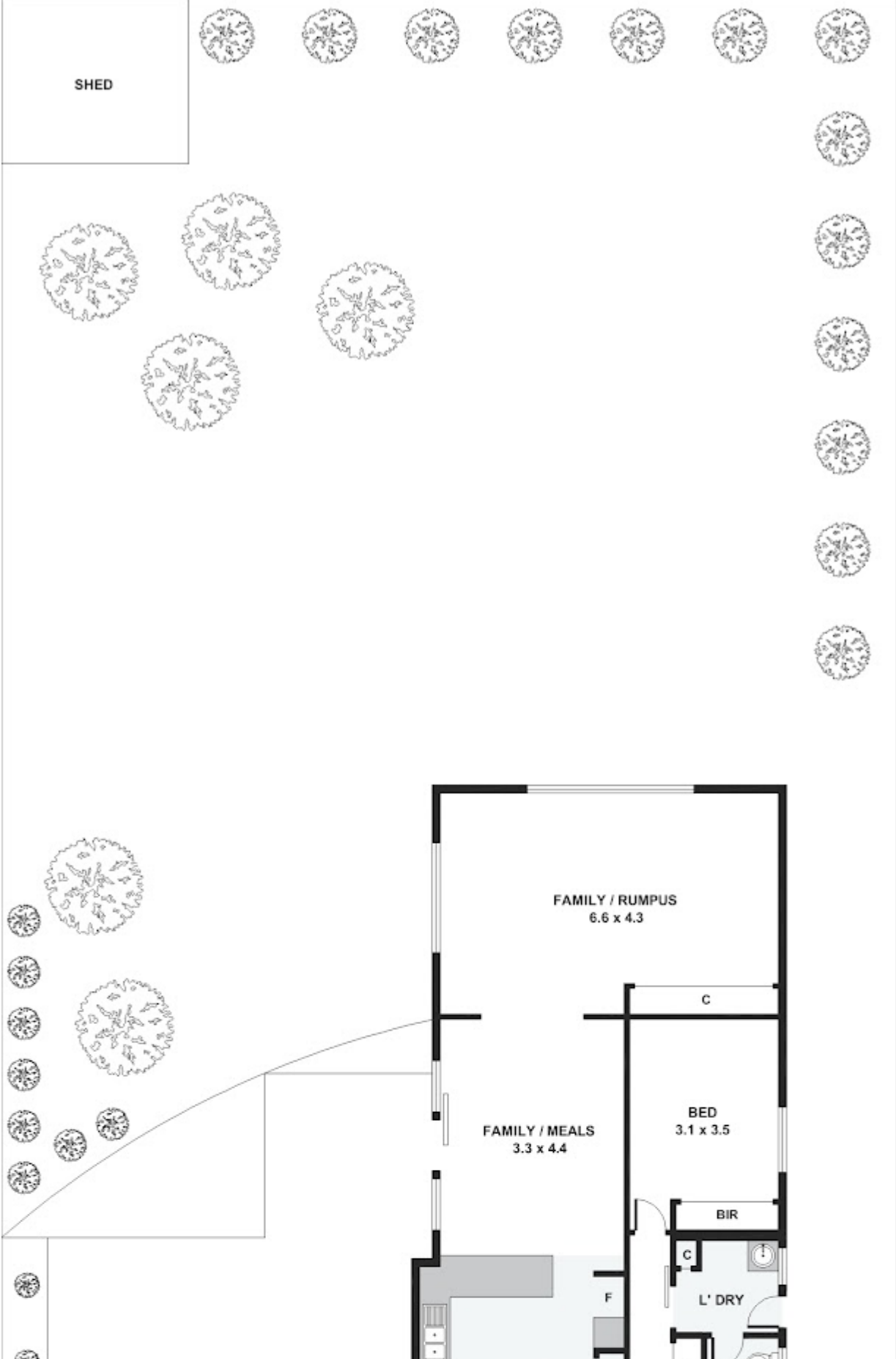

Disclaimer: Please note this floor plan is for marketing purposes and is to be used as a guide only. All dimensions are estimates only and may not be exact measurements.

George Shehata
0452460733
george.shehata@atrealty.com.au
www.atrealty.com.au

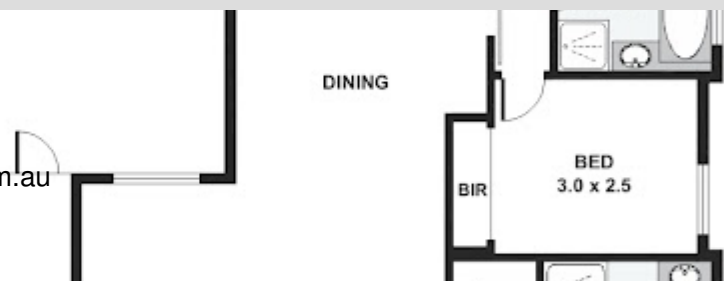

@realty

