



# SOLD

## GENEROUS FAMILY HOME IN THE PERFECT LOCATION!

Proudly presenting to the market this 4 bedroom stunning Executive home. Offering a variety of entertaining and lifestyle options, this family-friendly residence provides the perfect setting for relaxed living and effortless entertaining.

Located in the very highly sought after Springbrook Estate, Delaney's Creek this property sits on an open 3/4 acre block with side access, this executive home will be sure to tick all the boxes.

Executive features include:

- Master suite features a deluxe ensuite, with a double shower
  - Three spacious bedrooms are fitted with built-in robes
  - Sleek modern kitchen featuring a 900 Gas Cooktop, stone benchtops
  - Stylish bulkhead over the kitchen with inlaid LED colour changing lights
  - Massive laundry off the kitchen which would make a brilliant butler's pantry
  - Elegant main bathroom featuring a deep larger than normal bath tub and stone vanity top
  - Multiple living areas featuring a open plan family and dining and media room
  - Oversized double garage to effortlessly accommodate two 4WDS
  - Large powered 9m x 12m shed for all the toys
- Huge Alfresco overlooking the large yard for kids to play and grow, Be the envy of all your friends and family this Christmas!

Additional features: 2700 high-ceilings, air-conditioning, ceiling fans throughout, dishwasher, study nook, linen press, pergola off the main room, ceiling speakers, fully fenced and much more!

Things to know about Delaneys Creek:

- Family friendly estate Don't believe me... Ask the locals!
- Walking distance to Delaneys Creek Pony Club
- Walking distance to BMX tracks & playgrounds
- Stones throw to Delaneys Creek State Forrest
- 7 mins to Woodford
- 4 mins to the D'Aguilar highway
- 4 mins to Delaneys Creek State School

4 BED | 2 BATH | 5 CAR

PRICE:  
\$565,000

OPEN FOR INSPECTION:  
N/A



**Mitchell Younger**  
0488458887  
mitchell.younger@atrealty.com.au  
[www.atrealty.com.au](http://www.atrealty.com.au)

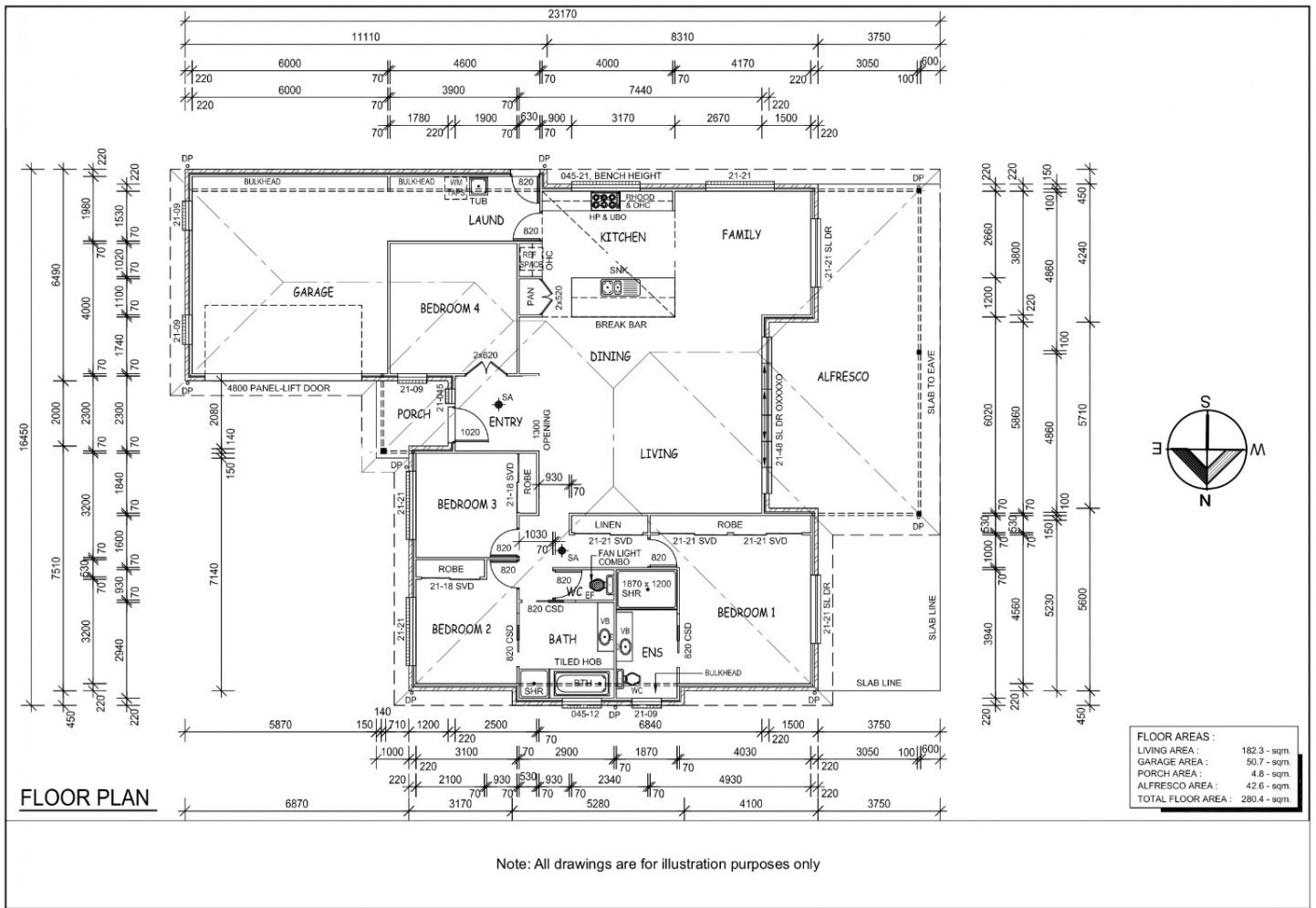

Disclaimer: Please note this floor plan is for marketing purposes and is to be used as a guide only. All dimensions are estimates only and may not be exact measurements.