



SOLD

PARADISE AWAITS

Ask anyone who lives in Port Vincent and they will tell you what a fabulous place it is. It is the Activity Centre of Yorke Peninsula. Whether you are into sailing, fishing, boating, snorkelling or swimming or just like to look at the sea and sunsets, enjoying a beverage or two, Port Vincent is for you.

With several walking trails, great main street shopping, hotel facilities and walking distance to the beach, it has become very popular for couples looking towards retirement.

This 4 bedroom, 2 bathroom much loved home is ready to move in as all the work has been done (Freshly painted inside & out)

Live with all the comforts of this Immaculate and modern home with open kitchen, living & dining opening on to the deck. Perfect home for entertaining, having friends for the weekend and socialising inside and out.

Rare opportunity to purchase this stunning home, built on a neat low maintenance block with two garages 9m x 6m with concrete flooring giving you plenty of storage room/garage or to use as studios/hobby etc.

Beautiful large tiles throughout main traffic areas giving a crisp, clean look and easy cleaning. Bedrooms are carpeted and include ceiling fans. Featuring 3 way bathroom plus en-suite in main and w.i.r.

The Vendors are willing to sell "Walk in Walk Out" (negotiable). Don't let this one slip through your fingers, enquire now.

Paula 0419 852 520 paula.sare@live.com.au
Trevor 0412 396 306 trevor@yourpricerealestate.com.au

4 BED | 2 BATH | 2 CAR

PRICE:
\$350,000

OPEN FOR INSPECTION:
N/A



Trevor Lambert
0412396306
trevor@atrealty.com.au
www.atrealty.com.au
RLA: 269823

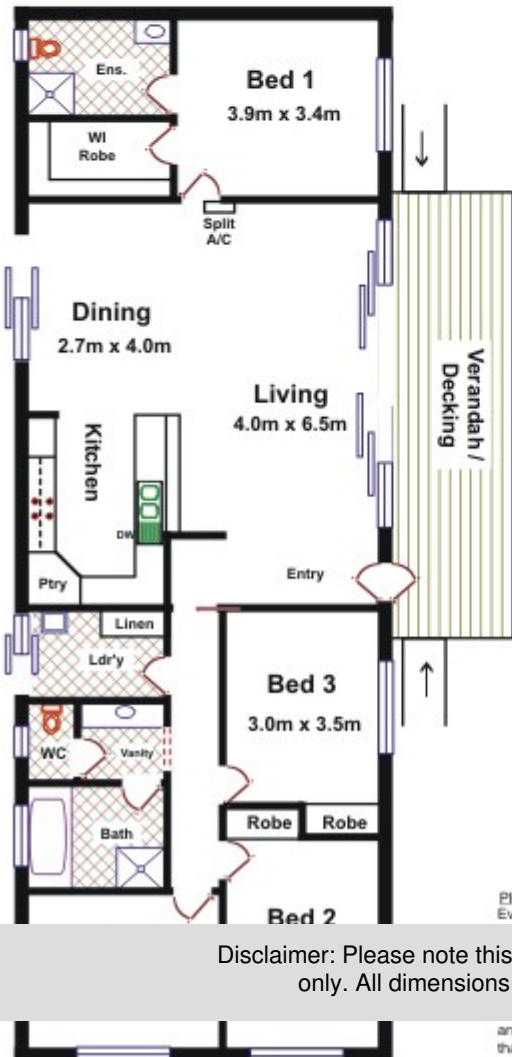
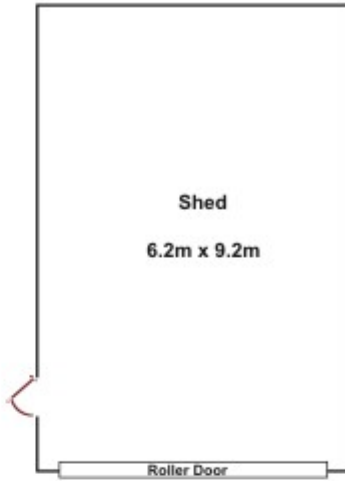
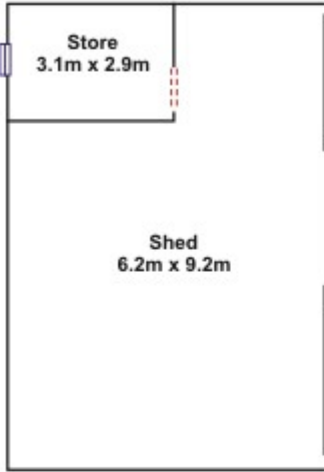

Area	M ²
Living	148.86
Verandah	20.95
Total Approx	169.81

Please Note:
Every care has been taken to verify the correctness of the areas

Disclaimer: Please note this floor plan is for marketing purposes and is to be used as a guide only. All dimensions are estimates only and may not be exact measurements.

and location of the property. Please check with local council that all structures are approved by council.