



SOLD

SUN-SOAKED WATERSIDE RETREAT

Positioned on the prestigious waterside location of Lewisham, this home offers a soothing getaway from your busy city life.

A visually dramatic living space and floorplan provides the ultimate in seamless indoor/outdoor living, designed to suit all occasions from entertaining guests to relaxing with the family after a day at work. Stainless steel appliances enhance the modern feel of the kitchen, which provides substantial bench and cupboard space. A charming sunken lounge at the front of the home is the perfect room to sit down and relax with a good book.

A generously sized multi-purpose room surrounds bedroom two, three and four has been designed to be used any way the owners might wish. The master suite has access to the deck and a streamlined and efficient ensuite with a large shower rose.

The focal point of the home is the extensive decking and entertainment areas, framed by beautifully landscaped coastal gardens. A gate leads out to the reserve, where steps lead down to the waters edge, a perfect spot to relax with a glass of wine and take in the serene and ever-changing sunsets on those hot balmy nights. Even better, grab the kayak and go for a paddle or grab your fishing rod and catch a feed of flathead!

This home really does reflect the relaxed ambience of its surroundings, so much that everyday living here will feel like a holiday!

4 BED | 2 BATH | 2 CAR

PRICE:
\$640,000

OPEN FOR INSPECTION:
N/A



Nikki Moller
0408924765
nikkimoller@atrealty.com.au
www.atrealty.com.au

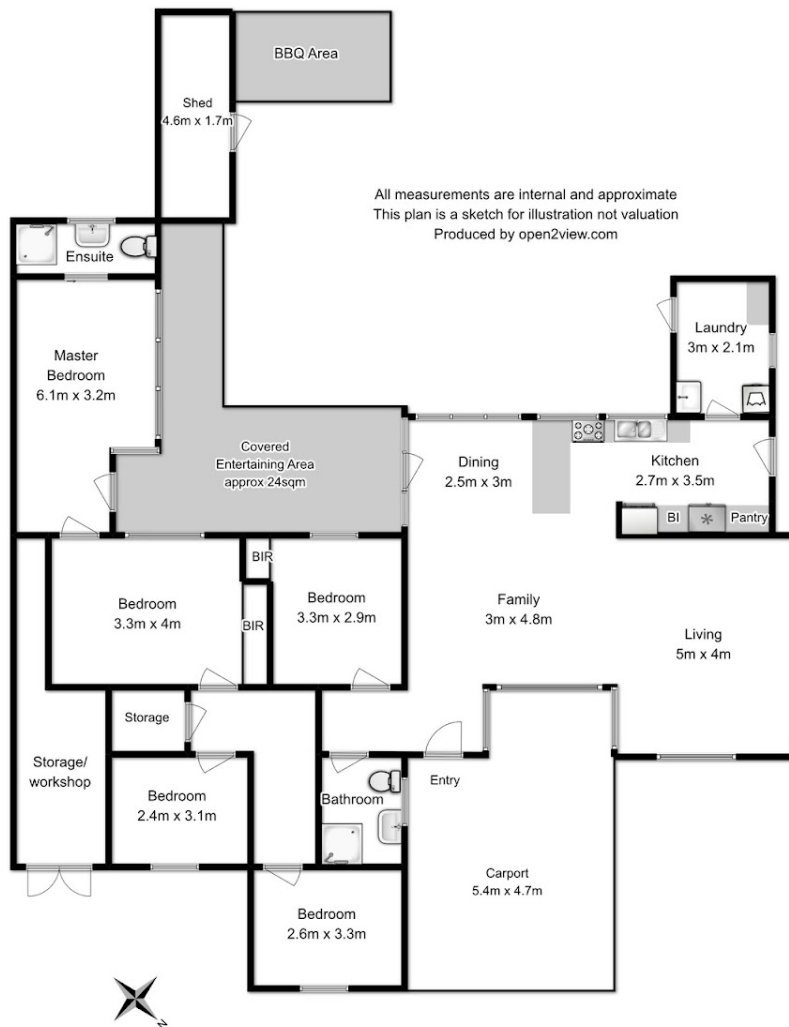

All measurements are internal and approximate
 This plan is a sketch for illustration not valuation
 Produced by open2view.com

Floor Area Approx: 168sqm

(excluding entertainment area, shed, carport & BBQ area)

Disclaimer: Please note this floor plan is for marketing purposes and is to be used as a guide only. All dimensions are estimates only and may not be exact measurements.