

19/15 SEABEACH AVENUE **MONA VALE**

Turner & Cullen



**FOR SALE**

## AFFORDABLE BEACHSIDE LIFESTYLE

A rare opportunity to buy at entry level, in a tightly held location, this light filled and beautifully presented studio apartment is perfect for the first home buyer, downsizer or investment opportunity.

In a peaceful premium beachside location, you are only a few minutes level stroll to the sparkling waves and golden sands of Mona Vale beach and basin. Enjoy the convenience of public and city transport including the B-Line bus service and the shopping hub of Mona Vale, all within easy walking distance.

- Neutral colour palette throughout
- Glass doors open to a peaceful and private balcony
- Generous bathroom
- Designated parking space within the complex
- The security complex includes a shared residence in-ground pool and BBQ area
- The complex is nestled amongst beautiful lush tropical gardens
- Within walking distance to a wide choice of cafes, restaurants or the iconic Mona Vale Hotel
- Love the presentation? No problem, fantastic opportunity to purchase furniture and finishes as a package
- Pet friendly complex

This studio won't last long - move in for Christmas

Quarterly outgoings (approx):

Strata Fees: \$834.37

Council rates: \$353.98

Water rates: \$172.07

Rental return: \$380 per week

**1 BED | 1 BATH | 1 CAR**

**PRICE:**

**\$470,000 - \$500,000**

**OPEN FOR INSPECTION:**

**N/A**



**Karen Turner**

**0424755448**

[karen@turnercullenproperty.com.au](mailto:karen@turnercullenproperty.com.au)

[turnercullenproperty.com.au](http://turnercullenproperty.com.au)

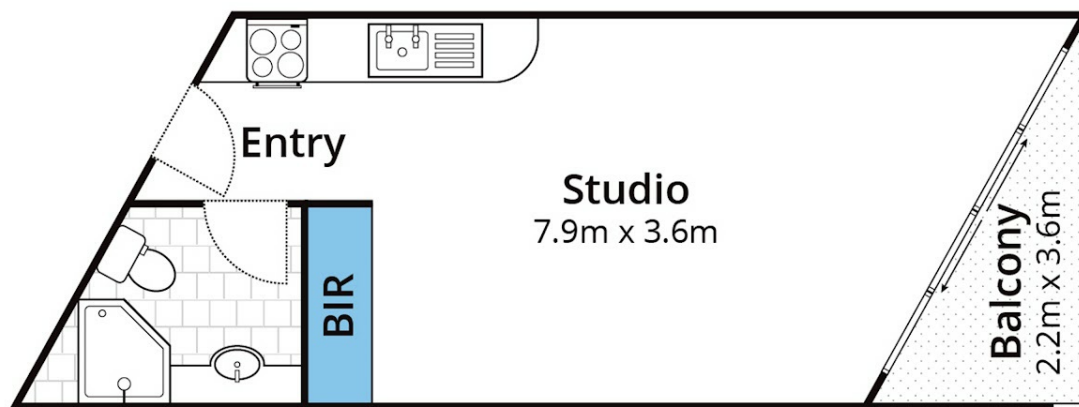

First Floor

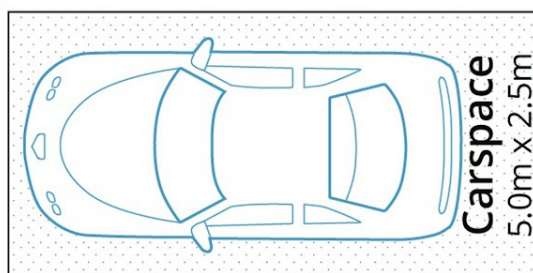

(Not In Position)

Whilst [bwrm.com.au](http://bwrm.com.au) has made every attempt to ensure the accuracy of the floor plan contained here, measurements are approximate and no responsibility is taken for any error, omission, or mis-statement. This plan is for illustrative purposes only.

**19/15 Seabeach Avenue, Mona Vale**



Disclaimer: Please note this floor plan is for marketing purposes and is to be used as a guide only. All dimensions are estimates only and may not be exact measurements.