



SOLD

YOUR NEW KINGDOM AWAITS

Proudly presenting this beautiful family home positioned home right in front of an attractive tree lined park. Solidly built and offering a chance for one lucky buyer to grab a hold of something with attributes that are very hard to find. Ideal for those seeking a 3-bedrooms with main central bathroom, master bedroom with walk-in robe. In addition to that all the bedrooms are fully carpeted.

Some of the other features include:

- 3 bedrooms - master with 2 way bathroom and walk-in robe.
- Entertainers kitchen fitted with quality stainless-steel appliances, 40mm Stone benches with glass splashback.
- A large family/meals area.
- Nicely landscaped front & back garden with plenty of space.
- Remote controlled Double garage with internal access.
- Split air conditioning & ducted heating.
- Floorboards in living areas.
- Tiles in the main walk ways.
- Fully concreted backyard.
- Outdoor window roller shutters.

Conveniently situated in the best pocket of Cranbourne – literally 2 mins drive to hunt club shopping precinct, quality schools, parks, shops and public transport.

3 BED | 2 BATH | 2 CAR

PRICE:
\$510,000

OPEN FOR INSPECTION:
N/A



Fahim Safi
0468482443
fahimsafi@atrealty.com.au
www.atrealty.com.au

45 Kingdom Dr, Cranbourne

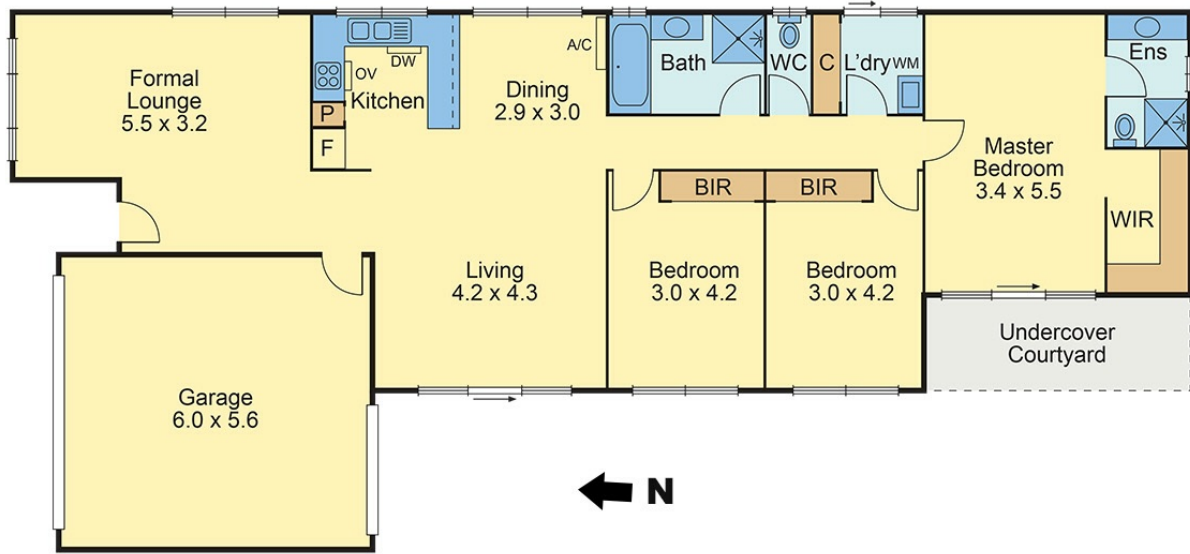

All measurements are in metres. This plan is not to scale and provided as marketing material. All measurements are approximate and for illustrative purposes only. We make no guarantee of the accuracy of the plan, and you should independently determine the suitability of the property for your requirements.

Disclaimer: Please note this floor plan is for marketing purposes and is to be used as a guide only. All dimensions are estimates only and may not be exact measurements.