



**SOLD**

## ESCAPE TO THE COUNTRY..

Have you ever dreamed of living on a few private acres with the chooks, vege patch and fruit trees a large country home all within 5kms to town. Time to stop dreaming and make your move. The beautiful block of 1.07 Ha or 2.5 acres has a gentle slope down to native forest garden and has some of the best views around.

The brick and colourbond home was built about 15 years ago and is very well laid out with two separate living rooms, two dining areas, three large bedrooms and a good size study. The main bedroom is massive with its ensuite and walk in robe.

Other features include:

- \* Double garage with internal access and a large three bay shed for the toys.
- \* Large under ground concrete tank.
- \* Covered back deck with beautiful country views.
- \* Solar power on the roof.
- \* Located at the end of a quite country lane.

It's time for your escape to the country, call Craig or Narelle to inspect this home.

NOTE: We are a local Nambucca Valley Agency with our Head office on the Gold Coast.

We make no representation or warranty as to the accuracy, reliability or completeness of the information relating to the property. Some information has been obtained from third parties and has not been independently verified. Accordingly, no warranty, representation or undertaking, whether express or implied, is made and no responsibility is accepted by us as to the accuracy of any part of this, or any further information supplied by or on behalf our behalf, whether orally or in writing.

**4 BED | 2 BATH | 5 CAR**

**PRICE:**  
\$660,000

**OPEN FOR INSPECTION:**  
N/A



**Craig Bellamy**  
0412080287  
craig.bellamy@atrealty.com.au  
[www.atrealty.com.au](http://www.atrealty.com.au)

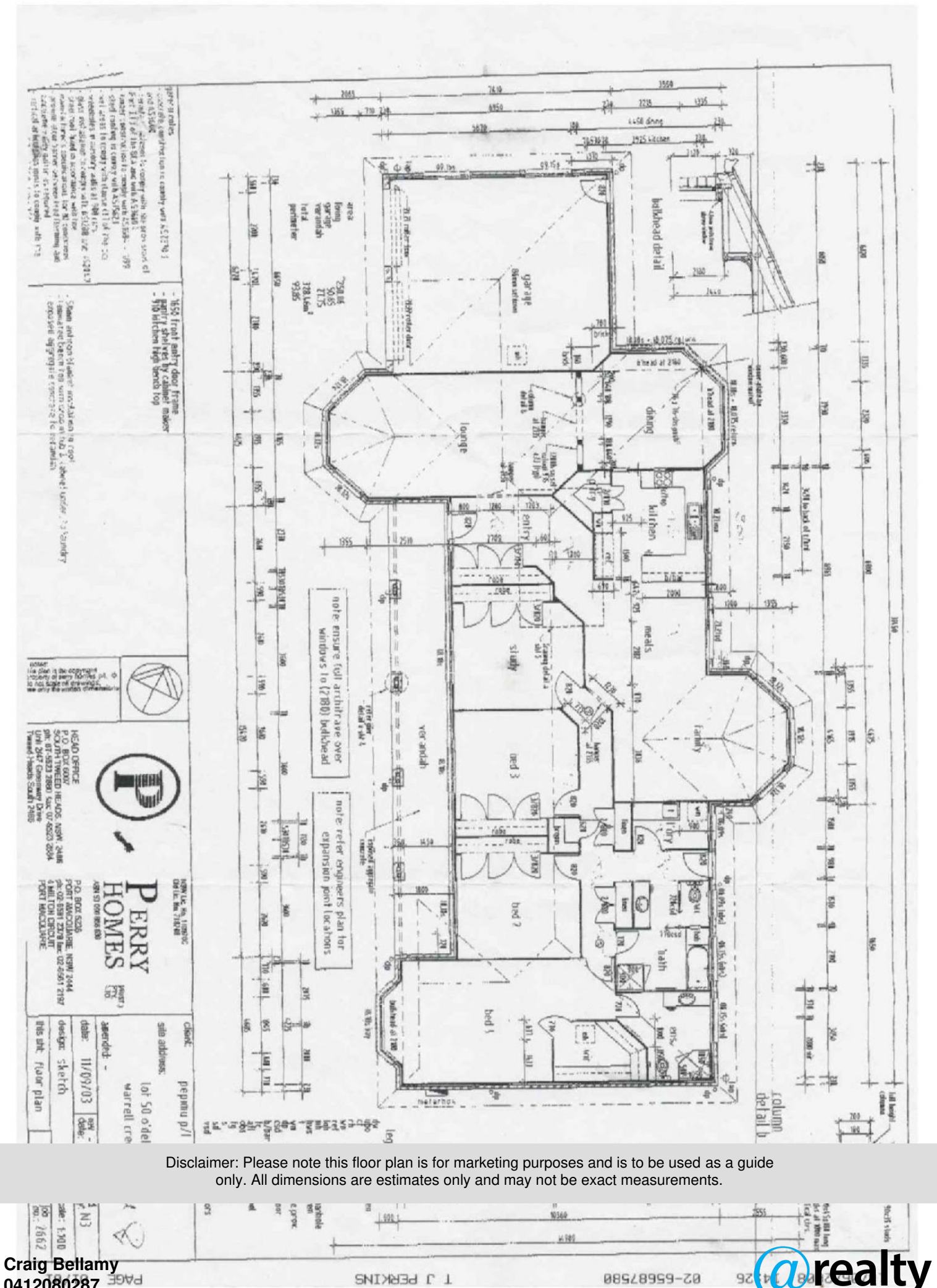

Disclaimer: Please note this floor plan is for marketing purposes and is to be used as a guide only. All dimensions are estimates only and may not be exact measurements.