



SOLD

MODERN TOWNHOME IN UPCOMING CORINDA

FAMILY HOME IN PRIVATE AND SECURE LOCATION

If you are searching for a modern quality designed three-bedroom home close to amenities and schools, you have found it right here! With lovely street appeal and your private and leafy courtyard patio, this is the perfect home walking distance to Corinda Shopping centre. You will love the clean and modern flooring throughout the living areas. The open plan design provides a relaxing feeling with a natural flow throughout the home, perfect when returning home after a busy day at work. The stylish white kitchen and covered patio area is ideal for entertaining. The kitchen features plenty of cupboard space with a white granite bench top look, quality stainless steel oven, range hood and dishwasher. The three double bedrooms are large, well separated for privacy and have modern built-in wardrobes while the generous master bedroom has its own ensuite. Perfectly positioned for both security and privacy, this wonderful home is located with close proximity to shops, train, restaurants and cafés. As an added convenience, the garage has an automatic garage door for ease of access to the home.

- Spacious open living and dining
- Large open plan gourmet kitchen with oven, range hood and dishwasher
- Large double bedrooms with built in wardrobes
- Tiled and pebbled courtyard for low maintenance
- Split system air-condition and ceiling fans
- Nice leafy outlook in an elevated position
- End of complex positioned with extra space and light
- Secure remote garage entry
- Low/reasonable BC fees
- Close to parks and amenities

Looking for a home or an investment property, this property has so much to offer.

3 BED | 2 BATH | 1 CAR

PRICE:
\$505,000

OPEN FOR INSPECTION:
N/A



Ronny Cronqvist
0449150001
ronny@atrealty.com.au
www.atrealty.com.au

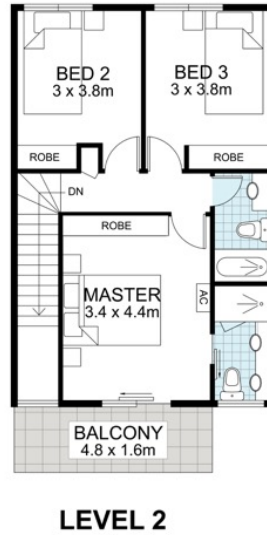

**17/1 Robbins Street,
Corinda**



FLOOR AREA SIZES

Internal 112m² | Garage 22m² | External 23m² | Total 157m²

Floor plan measurements are approximate and for illustration purposes only.
Scale in metres.

Created by Rolley Photo Media.

Disclaimer: Please note this floor plan is for marketing purposes and is to be used as a guide only. All dimensions are estimates only and may not be exact measurements.