



SOLD

AFFORDABLE LIVING IN HIGHGROVE

Refined Porter Davis beauty with rendered façade.

Be the new owner of this little gem. Perfect for first home buyers or retirees downsizing, the home has a good sized master bedroom with walk in robe and full ensuite at the front of the home.

Featuring a well-appointed central kitchen with 900mm stainless steel appliances and dishwasher with Caesar stone benchtops in a neutral décor.

The open plan meals and living areas open out to the rear deck from floor to ceiling sliding doors. A further two bedrooms with built in robes, family bathroom and second toilet complete the home.

Other features of the home include double remote garage with the convenience of internal access. Evaporative cooling, ducted heating, all add to the comforts of this home.

Perfectly situated well within a short walk or drive from multiple schools, local shopping centres such Selandra Rise, Shopping on Clyde and Cranbourne Central, parks and reserves.

Quality homes at this price are hard to find so please be quick to inspect.

3 BED | 2 BATH | 2 CAR

PRICE:
\$486,000

OPEN FOR INSPECTION:
N/A



Vincent Haupt
0409704667
vin@atrealty.com.au
www.atrealty.com.au

27 Compton Way CLYDE NORTH

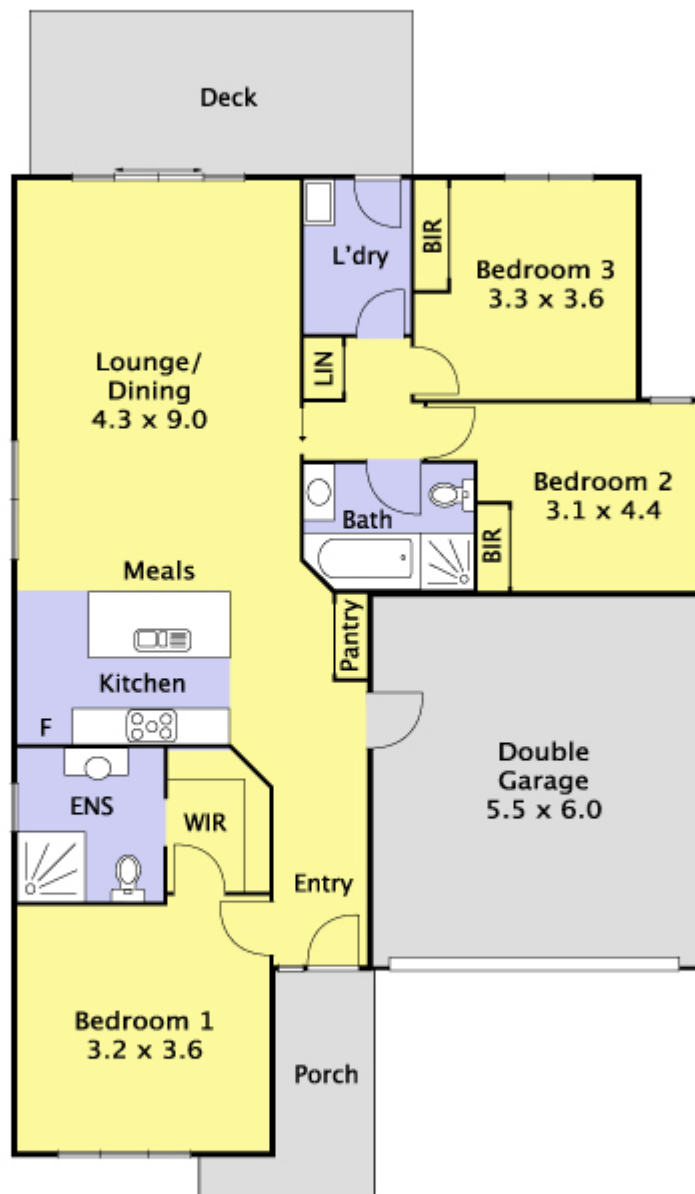

While every precaution has been taken to verify this information, it does not constitute any representation by the agent or vendor.

Disclaimer: Please note this floor plan is for marketing purposes and is to be used as a guide only. All dimensions are estimates only and may not be exact measurements.