



SOLD

A GREAT FAMILY HOME OR POTENTIAL RE-DEVELOPMENT SITE (STCC) ON A HUGE 950SQM ALLOT. (APPROX)

This one family owner built home is being offered for sale for the very first time in 58 years.

Positioned on a wide corner allotment opposite a reserve this home offers a wide entrance hall, 3 bedrooms with built-ins, functional kitchen with adjoining meals area, formal dining and lounge, built-in bar, r/c air, gas heating, 2 toilets, large rear traditional verandah great for entertaining, garden sheds for extra storage and dual driveways for secure parking of up to 5 cars.

Superbly located only 10 mins to the City and even less to Bayside Glenelg with its sandy beach, laid back pubs, cafes, boutiques, eateries and marina.

Also close to major shopping, quality schooling options and public transport.

Certainly a very rare opportunity for the astute buyer in this very popular suburb of Plympton.....Explore the possibilities !

Please call City of West Torrens for information relating to the objectives and provisions of development control that apply specifically to the zoning.

Property Information:
Zoning: Residential - Policy Area 20 - Low Density
Land Size: 950sqm approx. No Easements
Built: 1962
Council: City of West Torrens
Council Rates: \$1767 pa
SA Water Rates: \$242.00 per qtr

All information provided including, but not limited to, the property's land size, floorplan, floor size, building age and general property description has been obtained from sources deemed reliable. However, the agent and the vendor cannot guarantee the information is accurate and the

3 BED | 1 BATH | 6 CAR

PRICE:
\$760,000

OPEN FOR INSPECTION:
N/A



Robert Urbancic
0407606798
robertu@atrealty.com.au
www.atrealty.com.au
RLA: 269823

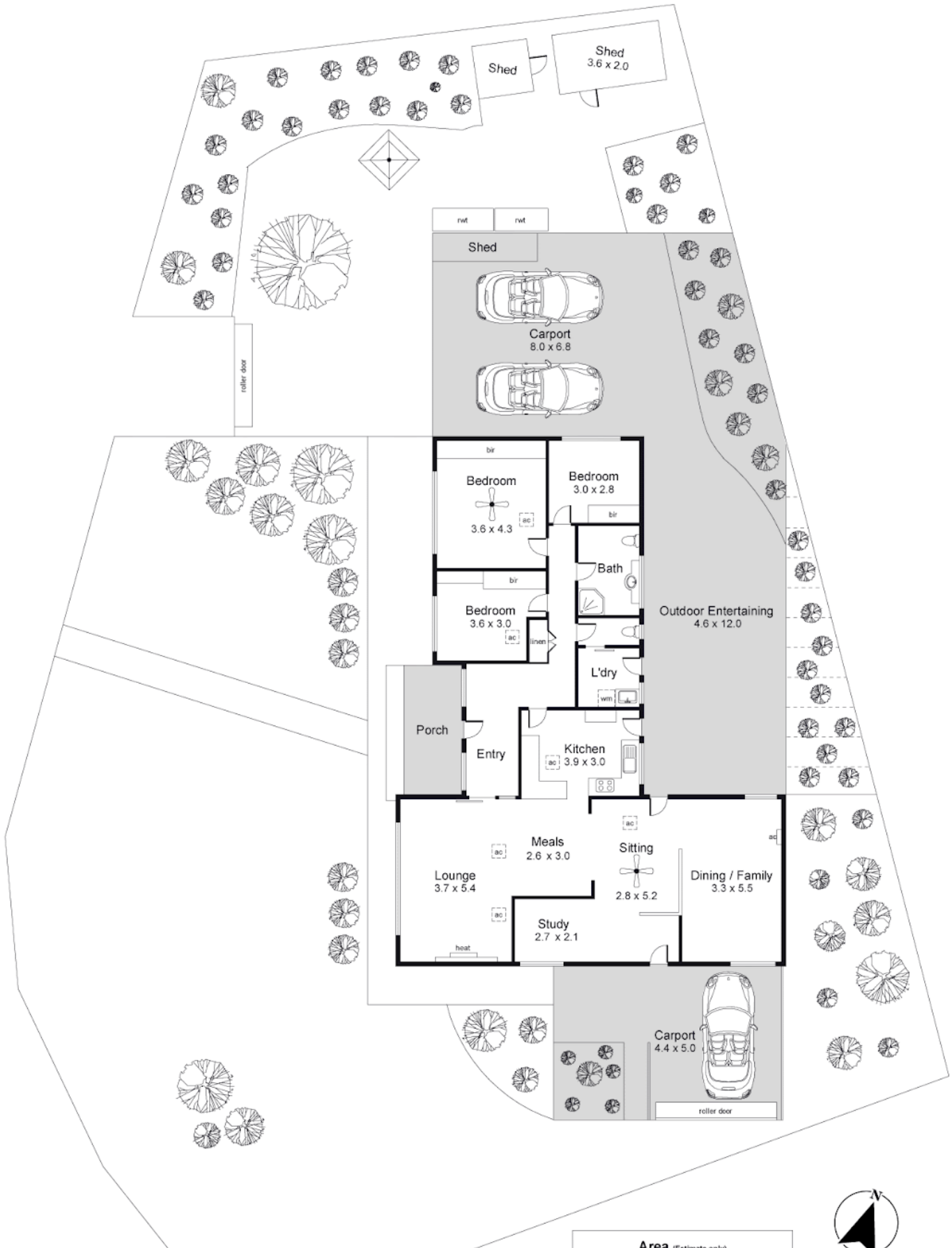

Area (Estimate only)

Disclaimer: Please note this floor plan is for marketing purposes and is to be used as a guide only. All dimensions are estimates only and may not be exact measurements.

Porch	11.0 m ²
Shed	16.5 m ²
Total	327.6 m²

For illustrative purposes only.
All measurements are approximate

Robert Urbancic
0407606798
 robertu@atrealty.com.au
www.atrealty.com.au

