



## FOR SALE

### SPACE WITH GRACE.

Contact your local agent Tricia 0457314206

Surprisingly generous is what you will find. This is a perfect family home with flexible floor plan and the opportunity for dual family living. Comprising of 4 spacious bedrooms. 3 have built-in robes and the master bedroom with en-suite and walk-in robe. Carpet and tiles throughout the home in timeless modern colors. A centrally located stylish second bathroom that is all class with a free-standing claw bath. A bonus lounge room on entry and the sparkling modern kitchen with island bench, stainless steel appliances, dishwasher and pure tap, overlooking the open-plan family room with direct access to the undercover deck with roll-down blinds. Entertain your friends in style and watch the kids play in a great size rear yard. Ducted heating and cooling and ceiling fans for year-round comfort. Wide hallways. Internal access from the garage, rain water tank, are just some of the many extras on offer.

Reside or rent out this value-packed home on a 390 m2 app block.

4 BED | 2 BATH | 1 CAR

#### PRICE:

\$359,000-379,000

#### OPEN FOR INSPECTION:

N/A



**Tricia Kernahan**

**0457314206**

[tricia@atrealty.com.au](mailto:tricia@atrealty.com.au)

[tfkrealestate.com.au](http://tfkrealestate.com.au)

RLA: 269823

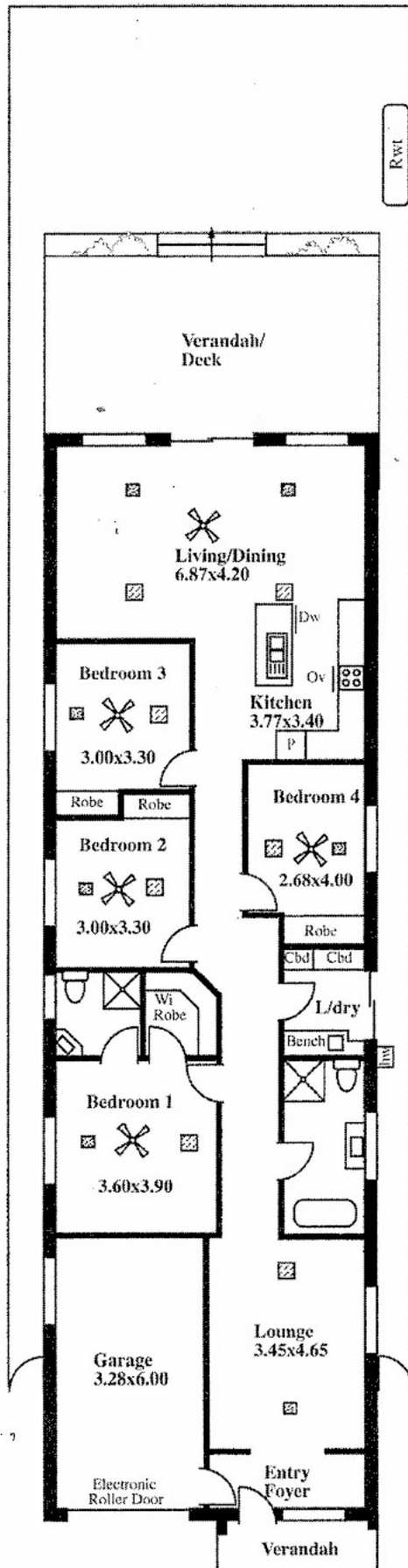

## 17a Wigham Road, Aldinga Beach

### LEGEND

- Air cond ducts
- Heat ducts

This drawing is for illustration purposes only  
(Drawing is not to scale)  
The drawing and the information contained is  
not intended to be part of any contract. All  
measurements are approximate and details intended  
to be relied upon should be independently verified.

ESTIMATE OF AREA  
176.91 Square metres/ 19.01 Squares  
(Including Garage)

Desk Top Image - (Y1113-20)

Disclaimer: Please note this floor plan is for marketing purposes and is to be used as a guide only. All dimensions are estimates only and may not be exact measurements.