



SOLD

YOU WON'T OUTGROW THIS HOME

A wise Realtor once said...

"If you buy a home that is too big for you then you will find a way to use that space. Buy a home that is too small for you then that's a problem which unlike the home will only grow"
6 Mercury Way is a deceptively large home, importantly its dimensions are all in the right places. It comes with an extra-large kitchen featuring stone bench tops and loads of overhead cupboards, dishwasher and SMEG appliances, there's a very generous sized family living area, plus a separate and again large theatre room with a designated spot for a bar.

The master bedroom features a walk through "his and hers" robe that leads into a generous sized en-suite complete with double shower, bath and separate toilet. Visitors will benefit from the powder room and the three other bedrooms have a family bathroom with a second bath.

Keeping with the extra space theme, there is a good-sized activity area off the main hallway which could serve as an office, computer room or play area.

Completing the picture is an outdoor alfresco area.

Built in 2017 by Plunket Homes this home sits on a corner block which gives you flexibility with access. There is room to park a substantial boat or caravan and right opposite is a large park where you can take the kids to fly the kite on a windy day or perhaps kick the footy about.

The rear/side yard is enclosed which provides a safe and convenient pet space or play area which can be seen from the living room and kitchen.

That same wise Realtor also said "The trick to creating a big home is to make it feel spacious and not cavernous, if it echoes in there, don't buy it, because that's room which will only ever be good for cleaning"

Here in lies the beauty of this property, perfectly proportioned so that every bit of space is rewarding and useful, yet feels inviting.

This is a long-term proposition with room to grow, great location and no neighbour's opposite. There's a lot to like about this home!

To arrange your personal viewing call Lorraine Stevenson on 0417 183 688

THINGS YOU SHOULD KNOW:

- *Quality 2017 built Plunkett home
- *Spacious, large and bright kitchen with quality appliances, stone bench tops and extra storage
- *Open plan living and entertaining area leading through to the alfresco and enclosed backyard
- *Reverse cycle air-conditioner in the living & entertaining area
- *Generous separate theatre room with a recessed space for a bar
- *Private King size master with his and hers walk in robes, en-suite with large bath and dual

4 BED | 2 BATH | 2 CAR

PRICE:
\$405,000

OPEN FOR INSPECTION:
N/A



Lorraine Stevenson
0417183688

lorraine.stevenson@atrealty.com.au

www.atrealty.com.au

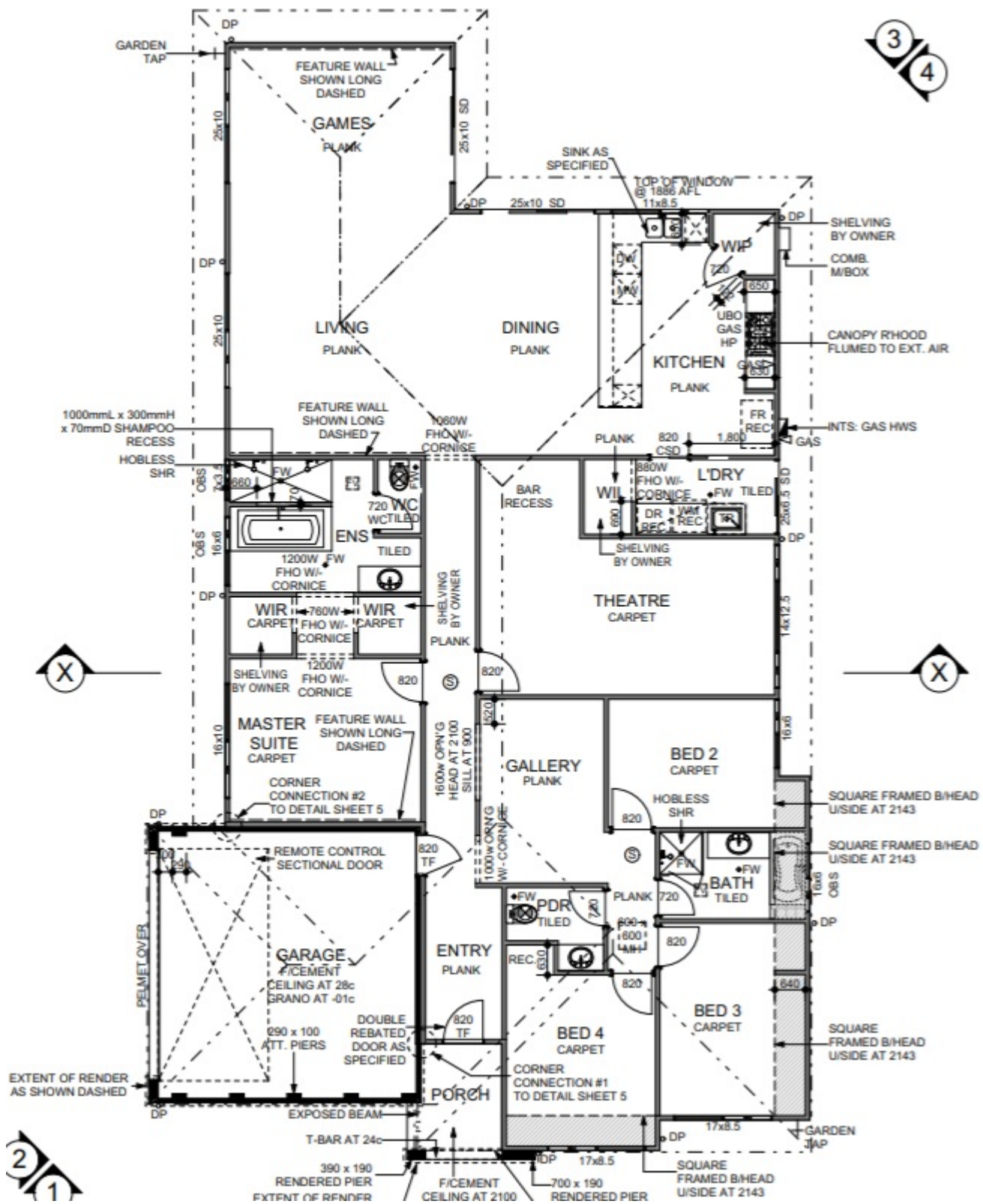

Disclaimer: Please note this floor plan is for marketing purposes and is to be used as a guide only. All dimensions are estimates only and may not be exact measurements.