



# FOR SALE

\*\*\*\*UNDER CONTRACT\*\*\*\*

Occupying a significant allotment of 703sqm (approx), this unique home is ready for the magic to begin - capitalising on spectacular views. Transform the original home which is cleverly divided into 2 separate wings ideal for extended families or investment options, with a ground floor featuring a living/dining area, kitchen, bedroom and bathroom. The upper-level offers lounge and dining rooms, sunroom, kitchen, 2 further robed bedrooms and bathroom. Complete with gas heater, reverse-cycle AC and double garage, there's plenty to retain to create a stunning renovation, or it's a fabulous opportunity to rebuild or redevelop (STCA). Perfectly located with its Viewbank College zoning, and close to local shops, cafes, restaurants and Heidelberg and Rosanna train stations.

3 BED | 2 BATH | 0 CAR

PRICE:  
Contact Agent

OPEN FOR INSPECTION:  
N/A

@realty

**Bobby Cvetkovic**  
**0423495479**  
bobby.cvetkovic@atrealty.com.au  
[www.atrealty.com.au](http://www.atrealty.com.au)

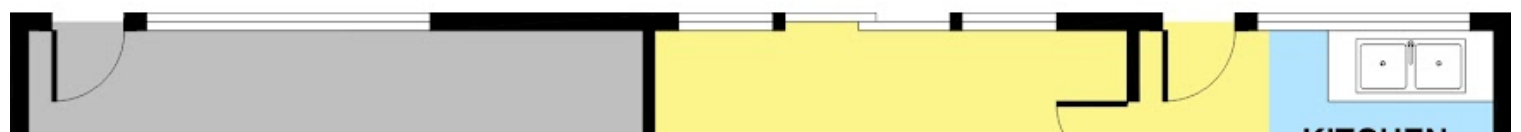

Disclaimer: Please note this floor plan is for marketing purposes and is to be used as a guide only. All dimensions are estimates only and may not be exact measurements.

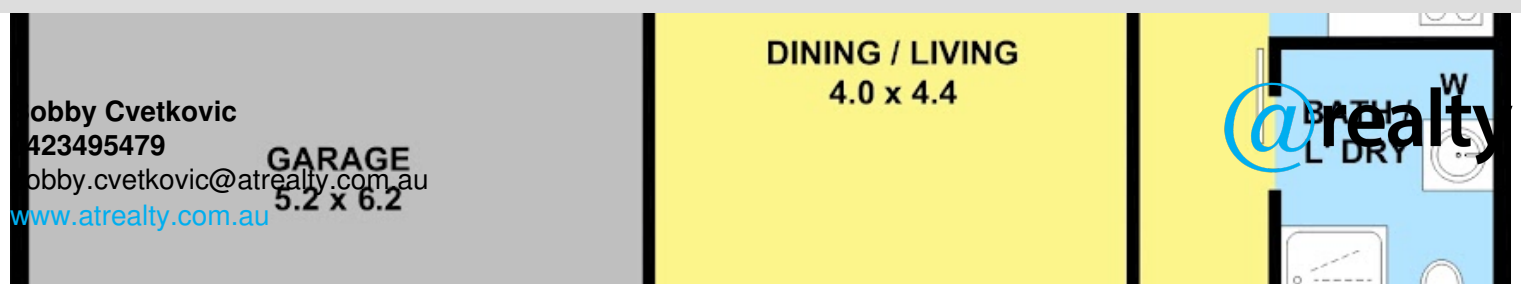

Robby Cvetkovic  
 423495479  
 robb.cvetkovic@atrealty.com.au  
[www.atrealty.com.au](http://www.atrealty.com.au)

