



FOR SALE

PERFECT FAMILY HOME

THIS WOULD MAKE THE PERFECT FAMILY HOME. LOCATED CLOSE TO PARKS AND SCHOOLS THE HOME CONSISTS OF 4 BEDROOMS THE MAIN HAVING WALK IN ROBE AND ENSUITE.
A LARGE FORMAL LOUNGE WOULD BE A GREAT PLACE TO RELAX.
THE OPEN KITCHEN MEALS FAMILY ROOM IS LARGE, A GREAT PLACE FOR THE FAMILY TO ENJOY.
JUST OFF THIS SPACE IS A HUGE COVERED PATIO GREAT PLACE FOR GATHERINGS WITH FAMILY AND FRIENDS.
CENTRAL GAS HEATING KEEPS THE HOME WARM IN THOSE WINTER MONTHS.
DOUBLE GARAGE UNDER THE MAIN ROOF WITH INSIDE ACCESS PLUS REAR ROLLER DOOR FOR BACKYARD ACCESS, THE REAR YARD IS LARGE AND PRIVATE IDEAL FOR CHILDREN ANIMALS OR MORE SHEDDING.
INSPECTION RECOMMENDED.

4 BED | 2 BATH | 2 CAR

PRICE:
\$355,000

OPEN FOR INSPECTION:
N/A



Peter Dempsey
0418854393
peterdempsey@atrealty.com.au
peterdempseyatrealty.com
RLA: 269823

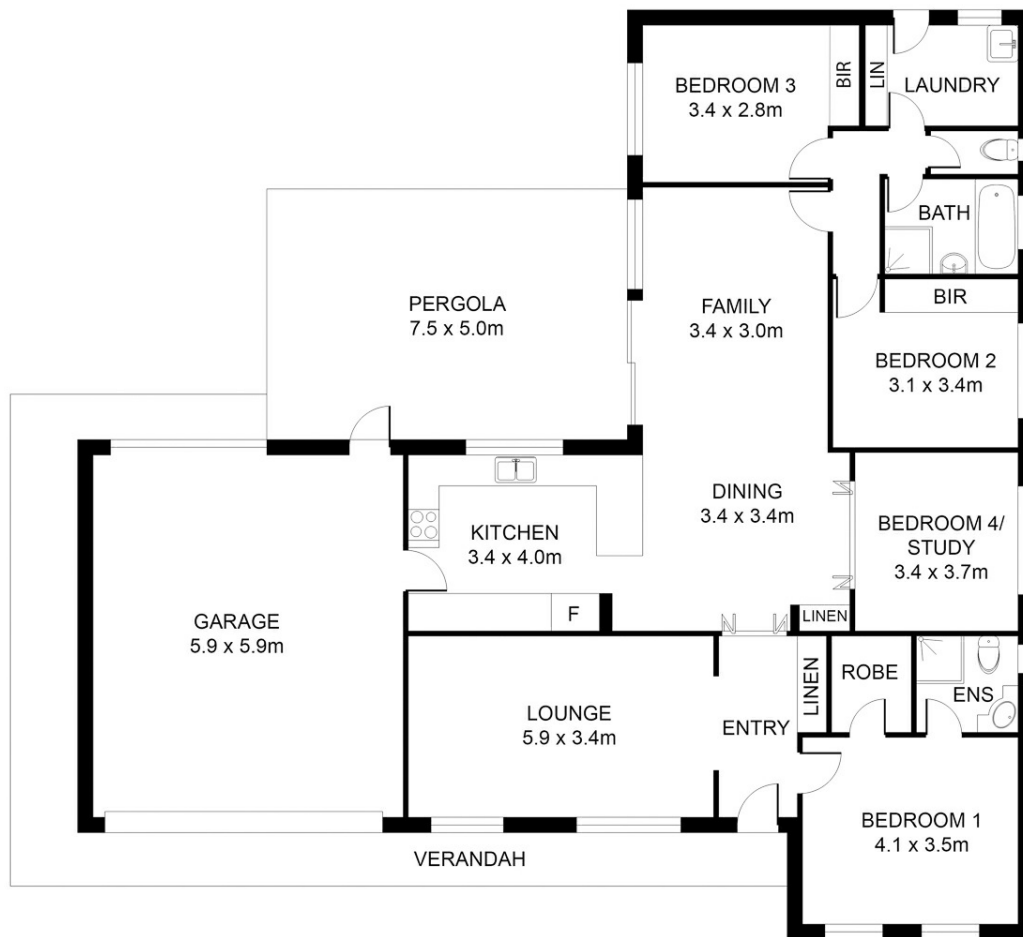

Disclaimer: Floor Plan measurements are approximate and are for illustrative purposes only. While we do not doubt the floor plans accuracy, we make no guarantee, warranty or representation as to the accuracy and completeness of the floor plan

Disclaimer: Please note this floor plan is for marketing purposes and is to be used as a guide only. All dimensions are estimates only and may not be exact measurements.