

## FOR SALE

### EFFORTLESS LIVING IN A COVETED LOCALE!

Inspect by Appointment.

You'll love the easy lifestyle that comes with this appealing stand alone, single-level villa, boasting it's own street frontage and providing the ultimate in relaxed, contemporary living. Beautifully maintained and exceptionally located in a secure Semi-Gated Community in one of Pakenham's finest estates, "Heritage Springs", it's sure to be a front runner amongst savvy investors, busy professionals, retirees and first home buyers alike.

Accommodation comprises: both formal and informal living areas, 3 generous bedrooms with large built in robes and serviced by the central bathroom with separate shower, bath and vanity. The stunning kitchen features Caesar stone bench tops, stainless steel cooktop, oven, dishwasher and ample storage while overlooking the informal living area with direct access to the north facing courtyard.

Other extras include: quality carpets, tiling and fittings, split air-conditioning, ducted heating, oversized auto garage with internal access, landscaped gardens and water tank.

Also, being located within walking distance of all amenities only adds further to the appeal of this first-class opportunity!

3 BED | 1 BATH | 1 CAR

PRICE:

\$420,000 - \$460,000

OPEN FOR INSPECTION:

N/A



**Craig Taylor**

**0412566800**

[craig@atrealty.com.au](mailto:craig@atrealty.com.au)

[www.atrealty.com.au/craigtaylor](http://www.atrealty.com.au/craigtaylor)

# 26/3 Manor View, Pakenham

Craig Taylor 0412 566 800

[craig@atrealty.com.au](mailto:craig@atrealty.com.au)

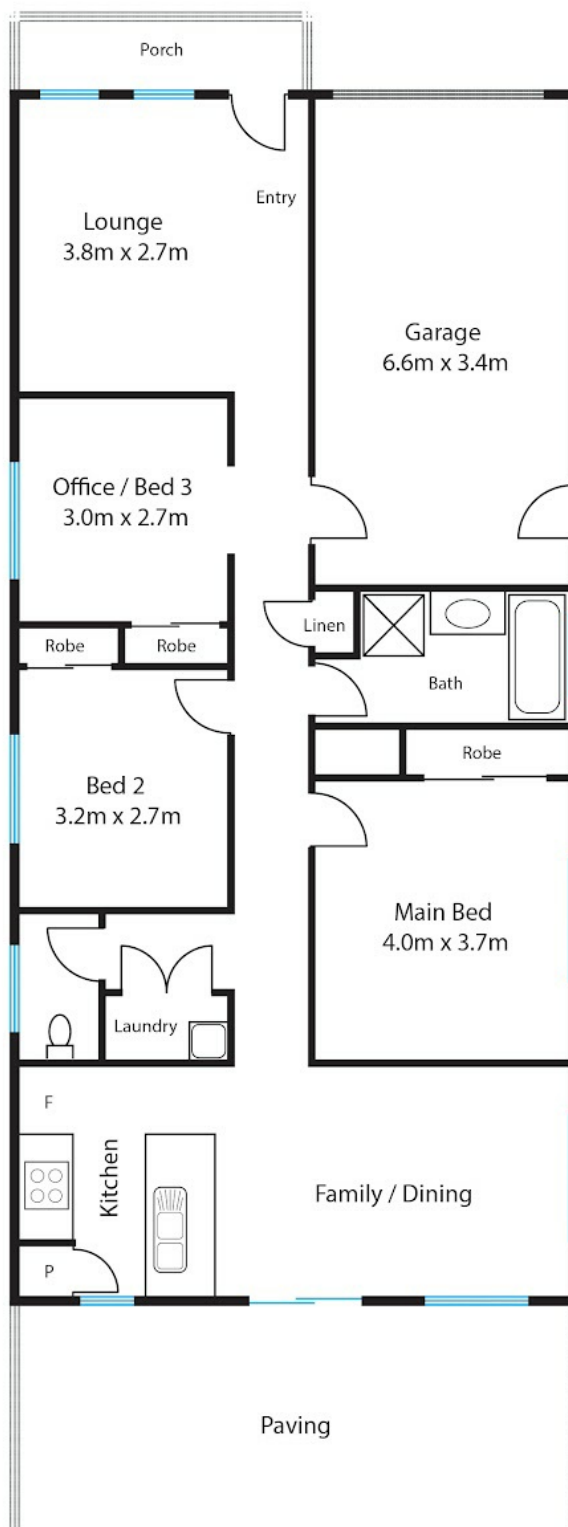

Disclaimer: Please note this floor plan is for marketing purposes and is to be used as a guide only. All dimensions are estimates only and may not be exact measurements.

Please note: All dimensions give are approximate and for illustrative purposes only.

Craig Taylor  
0412566800

[craig@atrealty.com.au](mailto:craig@atrealty.com.au)

[www.atrealty.com.au/craigtaylor](http://www.atrealty.com.au/craigtaylor)

[www.odigdesigns.com.au](http://www.odigdesigns.com.au) - LOGOS • FLOORPLAN/SITEPLAN REDRAWS • IMAGE ENHANCEMENTS

