



SOLD

PRIVATE INSPECTIONS WELCOME

CLOSING DATE SALE MONDAY 20TH APRIL AT 5.00PM (UNLESS SOLD PRIOR)

Peacefully positioned in a leafy pocket of Mitcham, step inside the front gate and experience the enchanting landscaped garden where you'll feel as though you've been transported to your own private sanctuary.

Beyond the colonial inspired exterior, this solid two bedroom residence offers a brilliant interplay of natural light and neutral tones, creating a warm and welcoming interior. A large bay window in the lounge overlooks the lush garden while polished floorboards introduce an organic look.

The fully functional kitchen features electric cooking and ample cupboard space, in addition to incorporating the meals area which sets the scene for intimate dining with friends and family. The laundry is conveniently located and is enhanced with generous storage.

Overlooking the lawn and garden, the master bedroom is spacious with double built-in robes and the 2nd bedroom is light and bright and also has double built-in robes. The central bathroom comprises bath, rain shower and adjoining separate toilet.

Fully fenced, both outdoor areas provide abundant space for dining and outdoor entertaining, providing a hide-away retreat where you'll feel instantly calm and content. Additional highlights of the property include; split system heating and cooling (approx. 2 years old), freshly painted inside and out, linen cupboard, two sheds and single car accommodation.

Positioned only a short stroll to the bus stop, Halliday Park with barbeque area and playground, Mitcham Primary School, Mullauna College, as well as offering momentary access to Mitcham Railway Station, Mitcham Shopping Centre, St. John's Primary School, Donvale Primary School, Heatherwood School, Mitcham Private Hospital and the EastLink freeway.

This beautiful unit offers a classic departure from ordinary.

Private Inspections Welcome.

Photo identification required at inspections.

2 BED | 1 BATH | 1 CAR

PRICE:
\$612,000

OPEN FOR INSPECTION:
N/A



Maree Slade
0419519282

maree.slade@atrealty.com.au

www.atrealty.com.au

carport
(actual position not shown to scale)



0 1 2 3 4



approx. scale (m)

This plan is a sketch, and all data shown is general only.

NB: All stated dimensions are approximate only & should not be taken as definite.

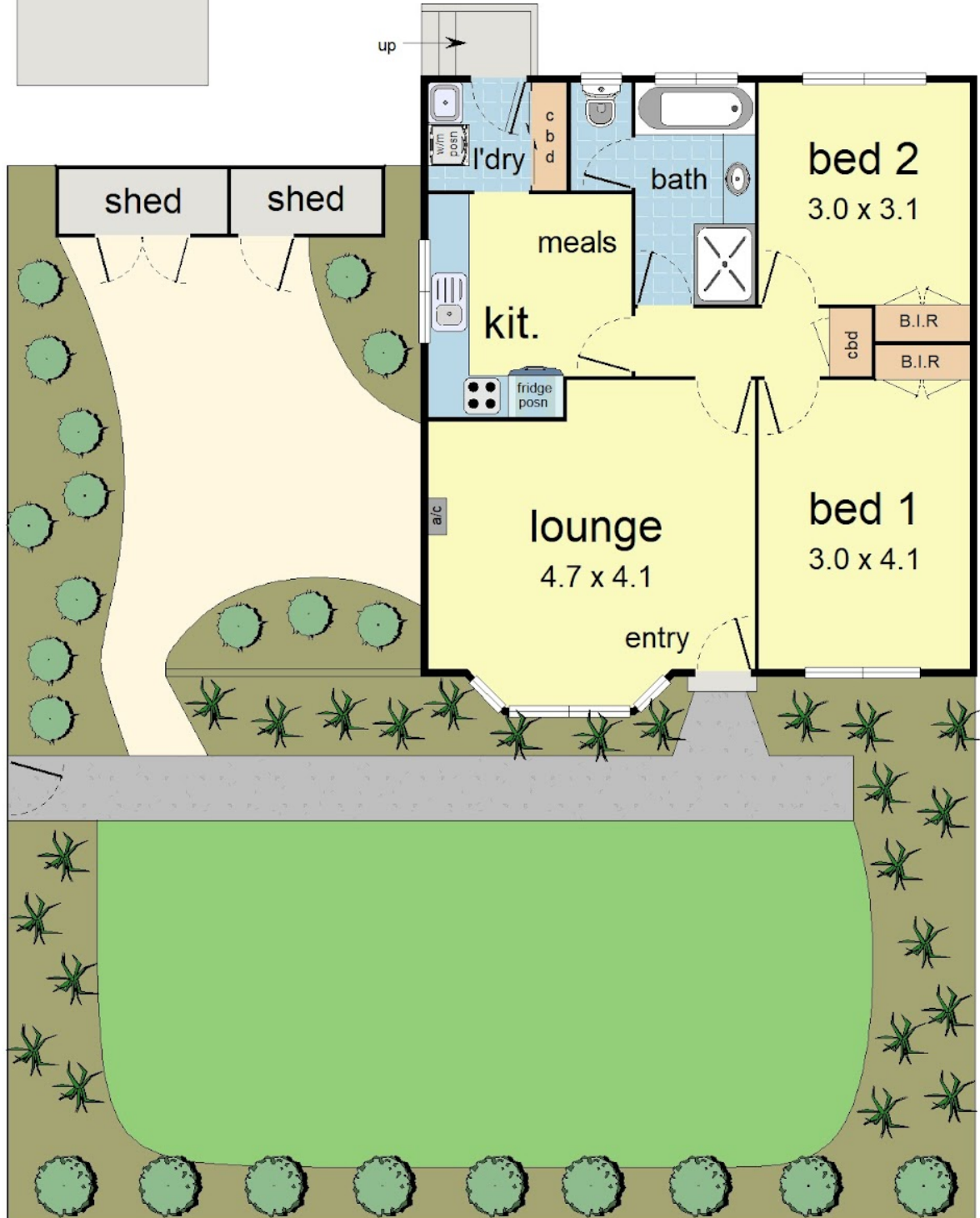

Disclaimer: Please note this floor plan is for marketing purposes and is to be used as a guide only. All dimensions are estimates only and may not be exact measurements.