



# SOLD

## UNDER CONTRACT - STUNNING SPACIOUS 155M2 APARTMENT

### UNDER CONTRACT

You will be impressed with the design of this spacious 155m2 open plan apartment located near the Tweed River. The design of the apartment was created around space, natural tones, an abundance of natural light, with elevated views from the 2nd floor.

#### Features Include:

Internal lift to all levels

Attractive foyer within the apartment

Spacious air-conditioned lounge room opening to the under-cover balcony to enjoy day or night.

Dining room or alternatively 2nd sitting area that opens to the balcony with floor to ceiling glass doors

The balcony is a generous size, 3.4m x 4.7m with a stone feature wall, a water feature and night lighting

The kitchen is designed around a stone island breakfast bar. Offering a combination of a cooking appliances, with a gas cook-top and an electric oven. Near new dishwasher, double door fridge, 1.1/2 sink and plenty of cupboard space. The entire kitchen opens to the living and dining areas.

The master suite is in neutral tones, with a walk in wardrobe and an ensuite.

2nd bedroom is also spacious with built-in wardrobes

Study suitable for home office

Main bathroom with vanity, bath and shower

Separate laundry

Air conditioned lounge-room

Fans are in the living area and both bedrooms

Underground secure car parking with 2 tandem car spaces

Lockable private storage cage measuring 2.2m x 1.8m

No common walls to another apartment

All this in a very attractive small boutique apartment located approx. 100m to the Tweed River, the local boat ramp. Proximity to the general shops, park and only 2.5km to Coolangatta and Kirra Beaches.

Don't miss this exciting opportunity to secure this apartment

2 BED | 2 BATH | 2 CAR

#### PRICE:

\$580,000

#### OPEN FOR INSPECTION:

N/A



**Michelle Topper**

**0400362639**

michelle.topper@atrealty.com.au

[www.atrealty.com.au](http://www.atrealty.com.au)

# 6/7 Margaret Street, Tweed Heads

2 2 2

internal: 139 m<sup>2</sup> | external: 16 m<sup>2</sup> | total: 155 m<sup>2</sup>

@realty

Michelle Topper 0400 362 639

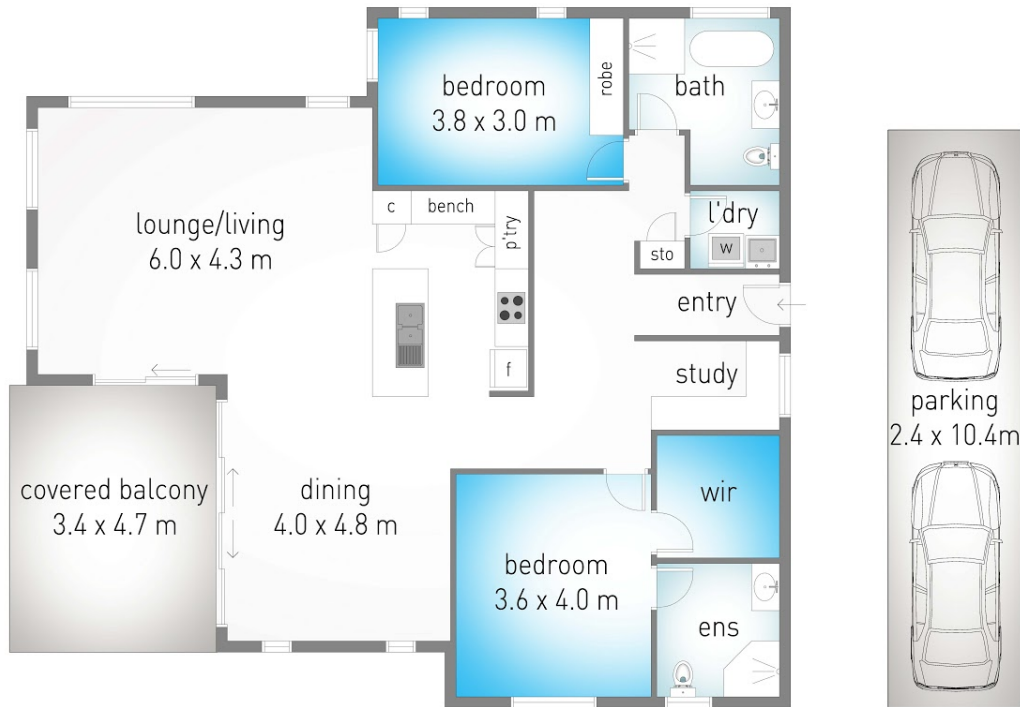

Dimensions are approximate. All information contained herein is gathered from sources we believe to be reliable. However we cannot guarantee its accuracy and interested persons should rely on their own enquiries. north

Disclaimer: Please note this floor plan is for marketing purposes and is to be used as a guide only. All dimensions are estimates only and may not be exact measurements.

Michelle Topper  
0400362639  
michelle.topper@atrealty.com.au  
[www.atrealty.com.au](http://www.atrealty.com.au)

@realty