



## FOR SALE

### FABULOUS VIEWS OF SEA AND SUBURBS, HIGH SIDE OF THE ROAD, CHARMING 'RETRO' CHARACTER!!!

Occupying a commanding elevated position, this immaculate and stylish home offers elegant living, beautiful views down the coast and delightful outdoor areas.

The home consists of 2 bedrooms and a study, stunning modern kitchen, separate dining room, formal lounge room, enclosed balcony/sunroom and a very large garage workshop (with the potential to convert some to extra living space).

The view can be enjoyed from the main bedroom, living areas and the sunroom. Whether you are still in bed, sitting in your favourite lounge chair or soaking up the winter sun in the sunroom, you will never tire of overlooking the beautiful sights below.

The block is approximately 840 sq m of gently sloping land and has been meticulously established. It boasts stone retaining walls, thriving garden, covered outdoor entertaining area, rear lane access and more.

Whilst Marino is away from the hustle and bustle, the bus and train are just minutes away and you'll find walking trails, the beach, Kingston House and cafes within easy reach.

A unique property - not to be missed.  
RLA 269823

2 BED | 1 BATH | 2 CAR

PRICE:  
\$660,000 - \$700,000

OPEN FOR INSPECTION:  
N/A



**Simon Tait**  
**0419853945**  
simon@taitre.com.au

RLA: 269823

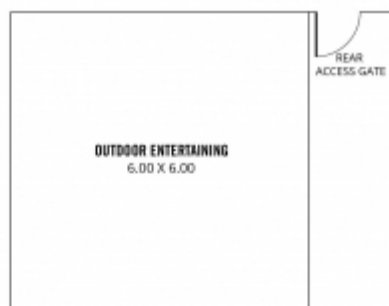

UPPER LEVEL

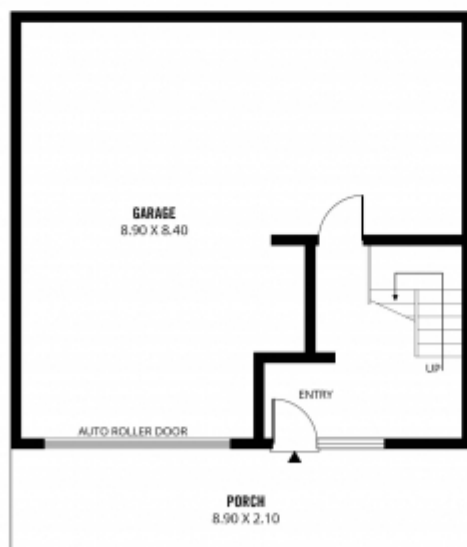

LOWER LEVEL



Scale in metres. This drawing is for illustration purposes only. All measurements are approximate and details intended to be relied upon should be independently verified.

Produced by The FotoBase Group

Disclaimer: Please note this floor plan is for marketing purposes and is to be used as a guide only. All dimensions are estimates only and may not be exact measurements.