



**SOLD**

## BEST VALUE TOWN-UNITS IN THE ULTIMATE LIFESTYLE MECCA

Real Estate locals, Andrew Emms and Mark Roemermann present ...

- \* First Home Buyers can apply for the 15k First Home Owners" Grant
- \* Investors and right-sizers should check the options too
- \* Construction is nearing completion
- \* Value-packed brand-new residences
- \* Small complex of only five home units
- \* 1 x single level ground floor with courtyard
- \* 4 x double storey apartments with dedicated master suites
  - with luxurious two sink vanity in the ensuite
  - and a walk-in wardrobe
- \* Sleek modern kitchen, stone bench tops & stainless-steel appliances
  - Bonus customised kitchen and dining island bench
- \* Airy and light filled open-plan living, inviting timber look plank flooring
- \* Internal living areas expand out to generous entertainment spaces
- \* Year round comfort, reverse cycle split system Air-conditioning
- \* Leafy residential street and tranquil balcony views

Moments from a myriad of shopping, dining and entertainment options:

- \* Toombul Shopping Centre and its new dining and entertainment precinct, "Upstairs"
- \* Clayfield shopping and dining offerings
- \* Nundah Village has quality bars, cafes and boutique shops
- \* Skygate offers even more shopping including a 24hr supermarket
- \* Portside, Racecourse Village and Racecourse Road are nearby too

Let's tick some more boxes ...

- \* Ceiling fans, block out blinds and security screens
- \* Single undercover car park and off-street visitor parking
- \* Main bathroom and laundry
- \* Intercom security

2 BED | 2 BATH | 1 CAR

PRICE:

\$0

OPEN FOR INSPECTION:

N/A



**Andrew Emms**

**0427734743**

[andrew.emms@atrealty.com.au](mailto:andrew.emms@atrealty.com.au)

[www.atrealty.com.au](http://www.atrealty.com.au)

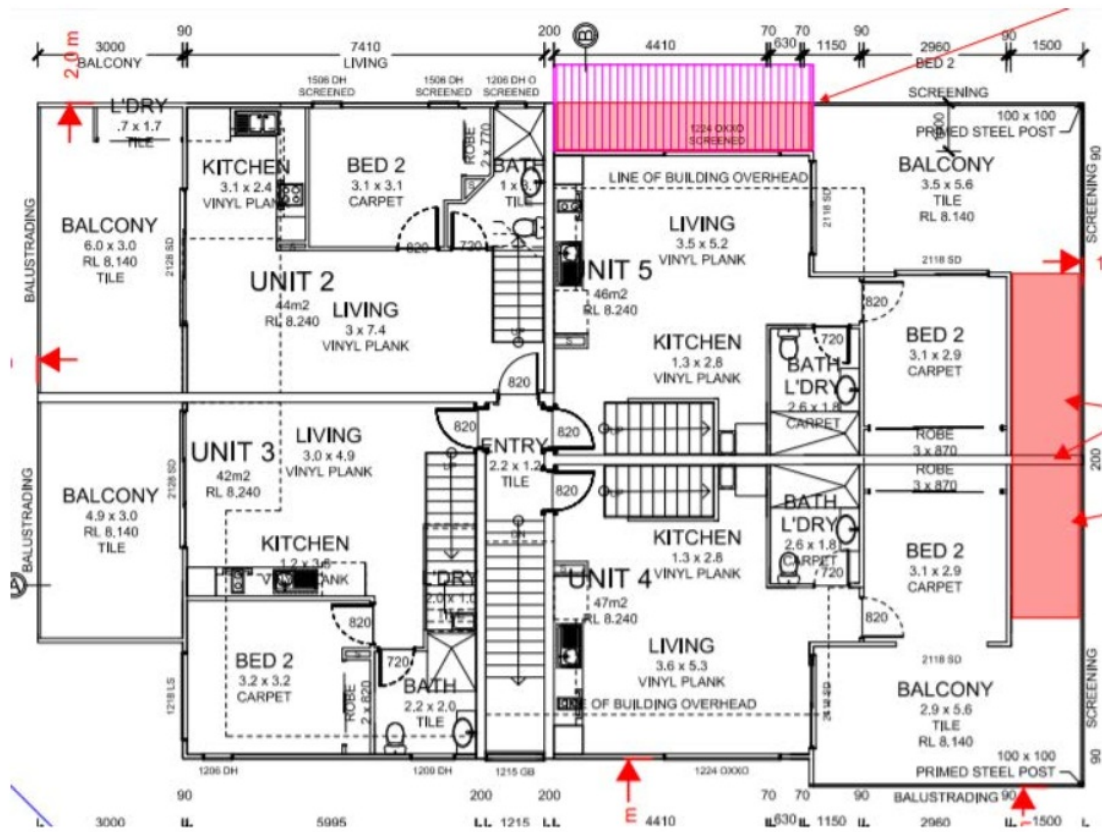

Disclaimer: Please note this floor plan is for marketing purposes and is to be used as a guide only. All dimensions are estimates only and may not be exact measurements.