



FOR SALE

THE PERFECT HOME OR INVESTMENT OPPORTUNITY!!!

INSPECTIONS BY PRIVATE APPOINTMENT ONLY -
Please contact our listing agent to make an appointment.

If you are looking for a great home to live in, this beautifully 2 bedroom unit is perfectly located for a lifestyle of convenience and relaxation. Situated in a lovely court location and offering easy access to schools, shops and public transport, this home presents immaculately and is perfect for a small family, first home buyer or someone looking to downsize.

For the astute investor looking for all tax and depreciation claims available, this is your next best buy in the real estate market. We currently have high demand for units for rent in Hampton Park with this location, providing you with a secure & high rental return.

Some of the many features included in this unit are:

- Single Lock Up Garage
- Beautiful private courtyard
- Built in robes
- Spacious kitchen with gas appliances

This unique opportunity wont last.

Disclaimer: We have in preparing this document used our best endeavours to ensure that the information contained in this document is true and accurate, but accept no responsibility and disclaim all liability in respect to any errors, omissions, inaccuracies or misstatements in this document. Prospective purchasers should make their own enquiries to verify the information contained in this document. Purchasers should make their own enquiries and refer to the due diligence check-list provided by Consumer Affairs. Click on the link for a copy of the due diligence check-list from Consumer Affairs.<http://www.consumer.vic.gov.au/duediligencechecklist>.

We will be asking attendees to:

Contact the Agent to book a private appointment

Not enter the property if:

- You have returned from overseas in the past two weeks
- You are unwell or have a fever

2 BED | 1 BATH | 1 CAR

PRICE:
\$345,000 - \$375,000

OPEN FOR INSPECTION:
N/A



Fahim Safi
0468482443
fahimsafi@atrealty.com.au
www.atrealty.com.au

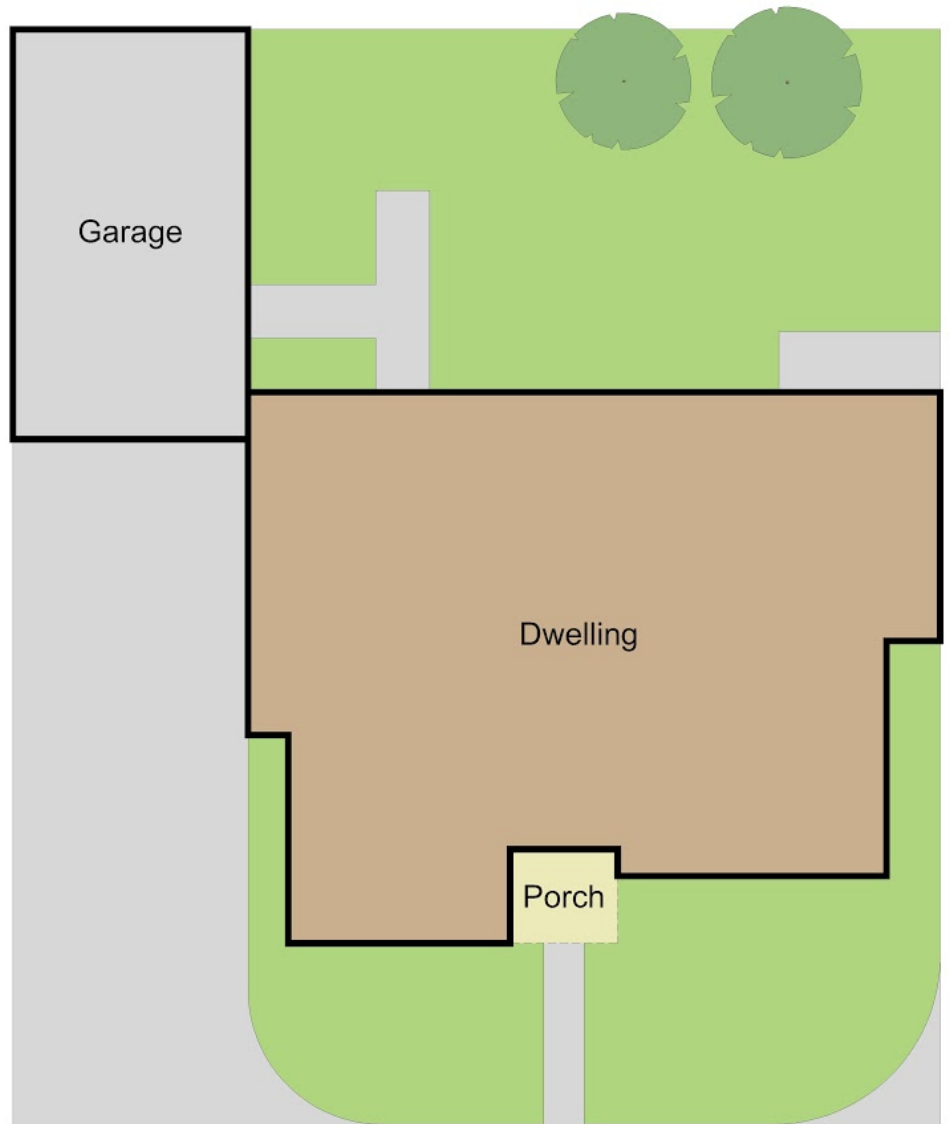

SITE PLAN

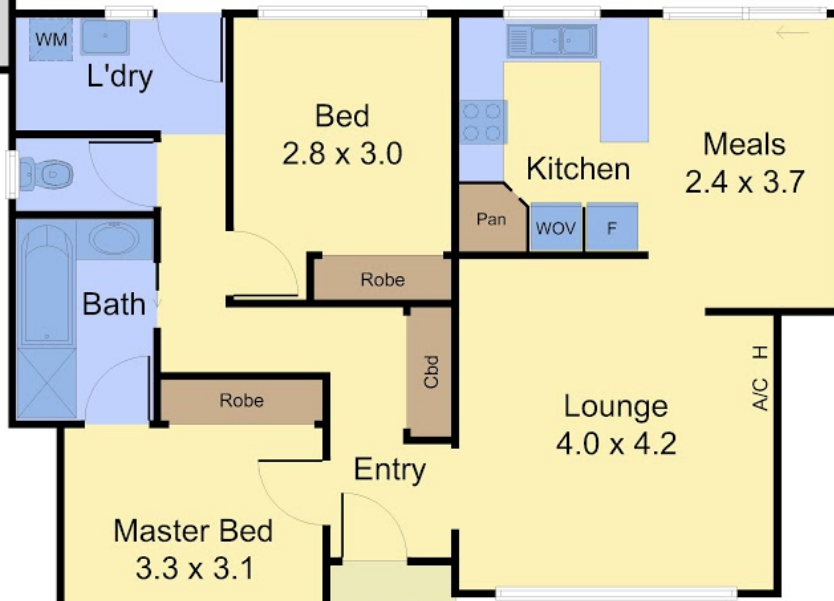
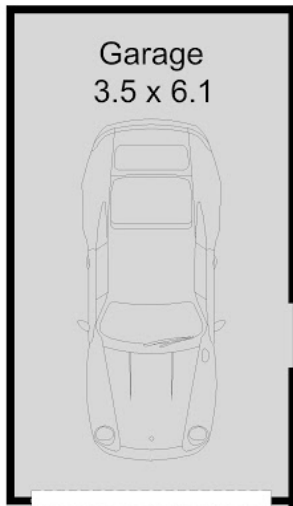

Disclaimer: Please note this floor plan is for marketing purposes and is to be used as a guide only. All dimensions are estimates only and may not be exact measurements.

FLOOR PLAN

Fahim Safi

0468482443

fahimsafi@atrealty.com.au

www.atrealty.com.au



Dimensions are approximate measurements; we cannot guarantee its accuracy. No liability will be accepted for any misinformation.