

3 FRENCH ISLAND CLOSE, CORINELLA, VIC, 3984



**SOLD**

## CHARISMATIC LIVING AND ENTERTAINING IN AN ULTRA-DESIRABLE LOCALE, STATE OF THE ART COASTAL LIVING

A sanctuary of high – end style on an extensive 1000m2 block, this unique home balances a bold architectural signature with the very best of family focused design.

Boasting a prized north-facing rear aspect, it enjoys a whisper quiet setting with views of Western Port Bay and French Island in Victoria.

So spacious and free-flowing across this split-level property, the principal floor plan offers a superior standard of flexibility for active modern living. Glamorous entertaining Balcony, showcasing a striking layout throughout the home.

It truly has that first impression, “wow” factor upon entry and you have to see more ... from the notable front door into the home to the superb full glass feature walls in both the living area and master bedroom. A few of the superior features of this architecturally designed home are the 4 spacious bedrooms, a chef’s galley kitchen that also offers panoramic views of Western Port Bay, and flows through to open plan dining and living area.

The home offers 2 living areas, the additional lower level living area has huge picture windows with access to an outdoor covered entertaining deck giving that sense of indoor-outdoor living feel. There are 2 bathrooms, a powder room. With a host of additional features including remote large double garage, outstanding storage solutions under the home, fernery, and a state of the art Solar system.

Situated in a very easy to access to all of Corinella beach life, this fabulous property offers incredible lifestyle opportunity. When you’re not being occupied at home, this wonderful address puts you only moments from, Wineries, World Famous GP Track, Parks, Penguin Parade, Surf Beaches, and a whole lot more in the heart of Bass Coast.

NOTE- CORONAVIRUS PRECAUTION: If you are unwell or displaying any flu like symptoms, please do not attend our open for inspection.

Contact Daniel or Tamara Leskie to arrange your private inspection or live streamed virtual inspection

4 BED | 2 BATH | 4 CAR

PRICE:  
\$10,000,000

OPEN FOR INSPECTION:  
N/A



**Tamara Leskie**  
0448809458

tamara.leskie@atrealty.com.au  
[www.atrealtypropertyexperts.com.au](http://www.atrealtypropertyexperts.com.au)



3 French Island Close, Corinella VIC, Australia, 3984  
 TOTAL APPROX. FLOOR AREA 265 SQ.M

Whilst every attempt has been made to ensure the accuracy of the floor plan contained here, measurements of doors, windows, rooms and any other items are approximate and no responsibility is taken for any error, omission, or misstatement. This plan is for illustrative purposes only and should be used as such by any prospective purchaser.

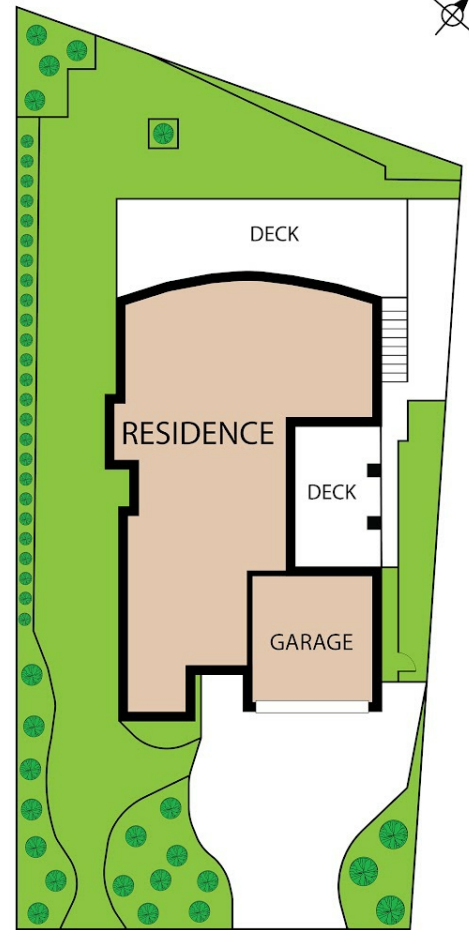

Disclaimer: Please note this floor plan is for marketing purposes and is to be used as a guide only. All dimensions are estimates only and may not be exact measurements.