



FOR SALE

FAMILY HOME IN A DESIRABLE LOCATION

The level of sophistication is evident as soon as you enter this tastefully designed home, encompassing a lifestyle only one can imagine and showcasing an array of modern inclusions tailored to your level of comfort. The use of space has been maximised, spread over an impressive floor plan cleverly pieced together with family living in mind. What a wonderful opportunity to secure a family home in a desirable location.

Features Include:

- Four generously proportioned bedrooms with built in robes
- Master bedroom includes a walk in robe & ensuite featuring a double shower head
- Spacious open plan living & dining room
- Well appointed kitchen filled with natural light
- Ample cupboard & bench space
- Gas cooking
- Dishwasher
- Pantry
- Breakfast bar overlooking living areas
- Media room
- Main bathroom includes luxurious freestanding bathtub & floor to ceiling tiling
- Internal laundry
- Ducted air conditioning
- Gas connection
- Plantation shutters
- LED downlights
- 2x Linen closets
- Alfresco entertaining with timber decking
- Low maintenance backyard
- Single garage with remote & internal access
- 367sqm block

This exquisite home is located in the popular and family friendly suburb of Elderslie and only a short distance from local shops, bus stops, local schools, child friendly parks, reserves, the popular shopping destination at Narellan Town Centre, Camden Golf Club and easy access to the Camden Bypass. This home is one to put at the top of your inspection list.

4 BED | 2 BATH | 1 CAR

PRICE:

\$690,000 - \$720,000

OPEN FOR INSPECTION:

N/A



Bobby Reynolds

0432173566

bobby.reynolds@atrealty.com.au

agencycentralwilton.com.au

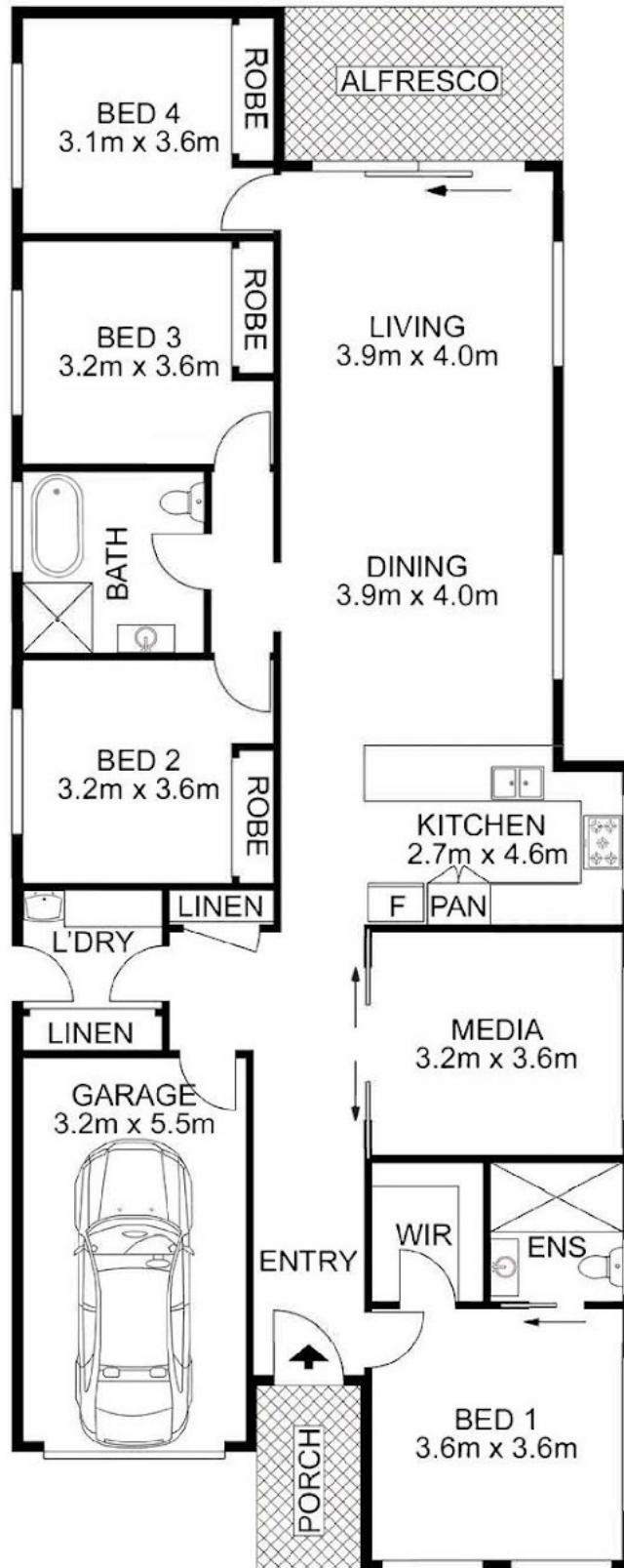

AGENCY

Disclaimer: Please note this floor plan is for marketing purposes and is to be used as a guide only. All dimensions are estimates only and may not be exact measurements.

2 Clowes Street, Elderslie

Bobby Reynolds All measurements are approximate • Drawn for marketing purposes only

0432173566

bobby.reynolds@atrealty.com.au

agencycentralwilton.com.au

