



FOR SALE

SEPARATE DUAL LIVING – HEATED POOL AND SHED

Presenting to the market this fabulous lowset family home situated on a massive 1,978m² block offering a multitude of separate living spaces, modern kitchen, expansive entertaining areas, sparkling heated inground swimming pool AND a Granny Flat/Studio/Home Business with separate entrance AND a 6 x 3m Shed all with a bushland aspect at the end of a quiet cul-de-sac in the Greenwoods Estate. Get your wish list out and get ready to tick it off... this property is bang for your buck!

Upon arrival the first things you will notice are the quiet cul-de-sac position, bushland backdrop, privacy being set back from the street and double side gate access with a concrete driveway leading you down to the shed at the rear of the property perfect for the tradie, boat accommodation or just the hobbyist who "needs" a shed!

The Main Home offers:

Four bedrooms + Study ++

- Bedroom one is the home's spacious master bedroom and features carpeted flooring, ducted air, ceiling fan, walk in robe and ensuite with spa bath.
- Bedrooms two, three and four all feature carpeted flooring, ducted air, ceiling fans and large built in robes.

Modern Kitchen/Dining/Family Room

The chef of the family will love cooking up a storm in this kitchen. Features include:

- Granite Benchtops
- Breakfast Bar with Timber Feature Benchtop
- Abundance of bench space and storage
- Large Fridge Cavity
- Dual Sink
- 6 Burner Gas Cooktop
- 900mm Oven
- Miele Dishwasher
- Large Pantry
- Filtered Water

5 BED | 3 BATH | 3 CAR

PRICE:

Low \$900,000's

OPEN FOR INSPECTION:

N/A



Natalie Johnston

0419689309

natalie@atrealty.com.au

Natalieatrealty

Total House area: 220 sqm
Total Granny Flat area: 50 sqm

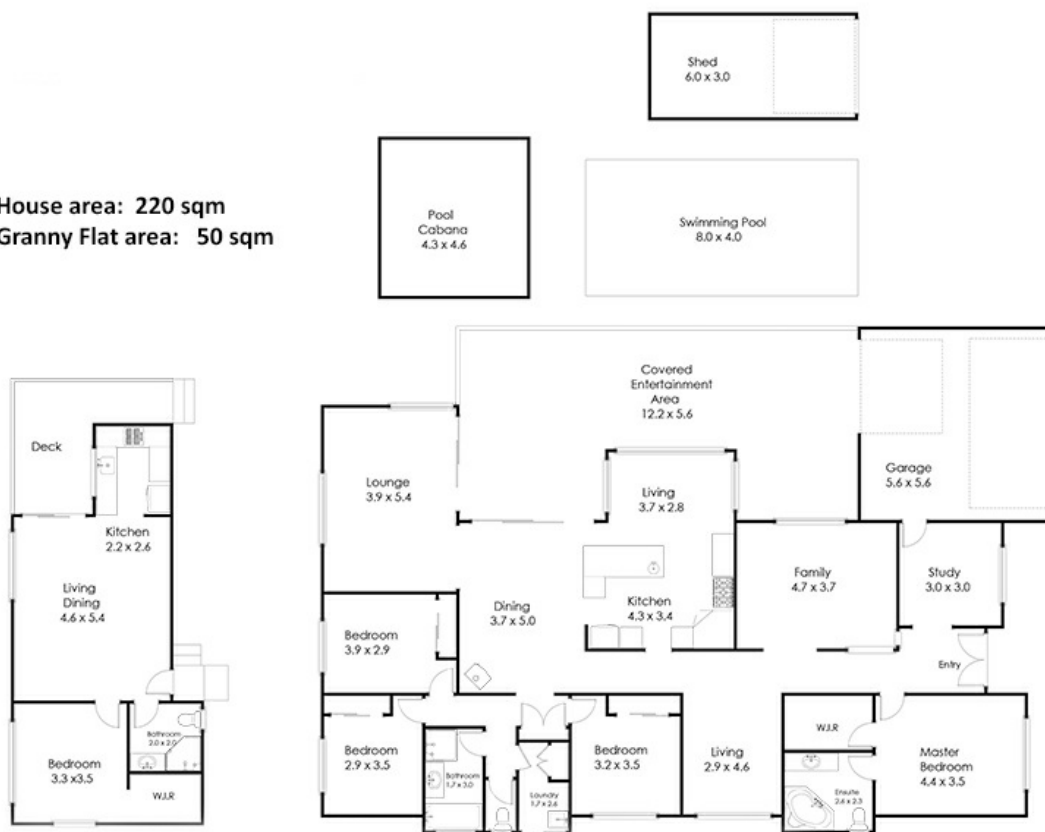

19 Grandis Court Cashmere 4500

Whilst every attempt has been made to ensure the accuracy of the floor plan contained here, measurements of doors, windows rooms and any other items and structures are approximate and no responsibility is taken for any error, omission or mis-statement. Bathroom and kitchen fittings, cupboards and door types and laundry appliances and windows are tokens and approximate the actual fitting installed.
This plan is for illustrative purposes and should be used as such by any prospective buyer.
Plan drawn by Eagle Eye Photography Service, www.eagleeyehq.com.au Copyright 2020.
All rights reserved.
No reproduction without licence, contact photographer for more information.

@realty

Disclaimer: Please note this floor plan is for marketing purposes and is to be used as a guide only. All dimensions are estimates only and may not be exact measurements.