



FOR SALE

CLASSICALLY SIMPLE

Classic style and a treasured position makes this property deserving of the top position of your preferred properties' list. If you are considering the enviable position of owning your own property and maintaining control of your future lifestyle, then this strata titled property offers you that flexibility. This property provides excellent value for the home buyer or investor.

The unit is well appointed with quality finishes throughout and fits the bill perfectly for those seeking convenience, location and style. Prepare to be delighted as you step into the spacious and light-filled open-plan living and dining room with its soothing neutral palette and glistening tiled flooring all flowing seamlessly into the modern kitchen. The kitchen will be sure to impress you with its bench space and storage, pantry, glass ceramic cooktop & oven and breakfast bench.

A Glass sliding door opens out to the entertaining area; the ideal spot to enjoy the aromas of your morning coffee. With the early morning sunshine and the dappled afternoon sunlight ... well this is the perfect spot to unwind. At the end of your day enjoy your evening drink with the backdrop of a privacy screen of well established garden trees and shrubs.

The bedrooms are positioned at either end of the home, allowing for separation of living and providing exceptional privacy.

The elevated position of the unit affords relaxing views from each room.

The bedrooms are serviced by a sparkling and sleek family bathroom, complete with its own shower, bath tub and a separate toilet suite. The laundry is also included within the garage and has good storage cabinetry. A single lock up garage has a remote controlled roller door. There is also a second car park located at the front of the unit.

Features of 2/23 Bond Drive:
 2 Bedrooms with Built-in-Robes
 Open Plan Lounge, Dining, Kitchen
 Well Appointed Kitchen inc Dishwasher
 Split System Air-Conditioning
 Bathroom with Shower and Bath Tub
 Separate Toilet
 Laundry and Storage Area
 Lockup Garage with Remote Controller

2 BED | 1 BATH | 2 CAR

PRICE:
\$248,950 MOVE NOW!

OPEN FOR INSPECTION:
 N/A



Ian and Janelle Pye
0437778111
 ianpye@atrealty.com.au
www.atrealty.com.au

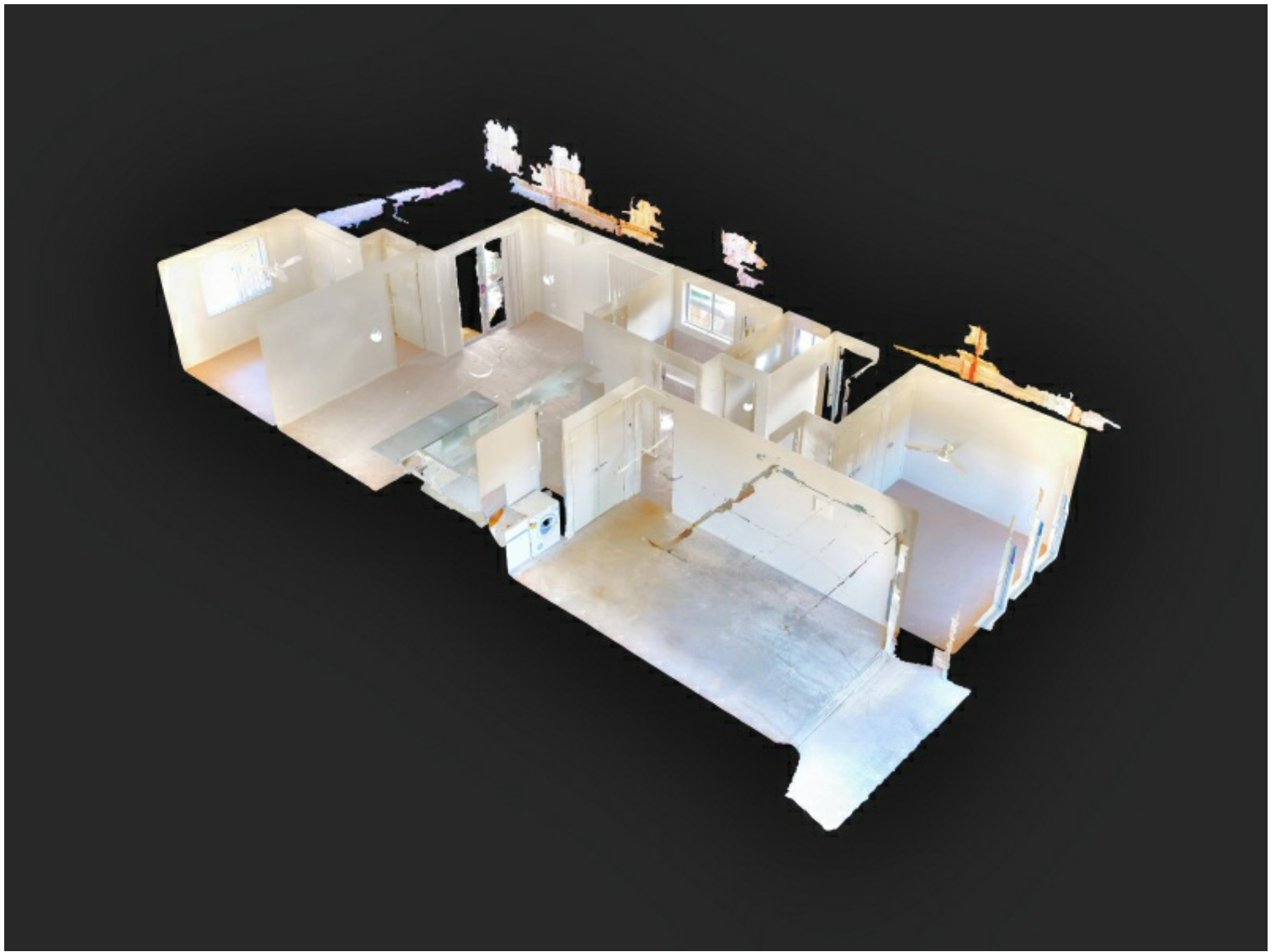

Disclaimer: Please note this floor plan is for marketing purposes and is to be used as a guide only. All dimensions are estimates only and may not be exact measurements.