



SOLD

RAINFOREST TRANQUILITY ON MORE THAN ¼ OF AN ACRE!

SELLERS COMMITTED ELSEWHERE - ALL REASONABLE OFFERS CONSIDERED.
Presenting to the market a fabulous opportunity to purchase this four bedroom extremely well maintained brick home situated on a lush 1,250m2 fully fenced corner block in Cashmere.

Situated with a north easterly aspect this home is welcoming from the moment you arrive at the door, with modern flooring to welcome you through the entry to the air-conditioned open plan living, dining and kitchen which flows seamlessly to the fantastically appointed deck that overlooks a plethora of low maintenance, rainforest like trees and plants. Entertaining out here will be a breeze, there is enough room for everyone and the Barbeque or just sit on an oversized outdoor lounge of a morning with your cuppa or late afternoon with a wine and relax and watch the amazing bird life that this yard attracts!

Back inside there is three generous size bedrooms all with built in robes, the master offering a sliding door to that gorgeous deck area as well as walk through robe to the main bathroom.

Downstairs is a recently converted one bedroom, one bathroom, separate living area residence that was used as an AirBnB, what better way to help pay off your mortgage than have someone else do it for you? Or is this the perfect space for a grandparent or adult child offering complete privacy with separate front door entry and entertaining area?

Properties in this price range, on this size block in Cashmere do not last and are as rare as hen's teeth – don't miss out, don't delay call Natalie today on 0419689309.

At a glance:
Fully Fenced 1,250m2 Block
Dual Living Option/AirBnB
Bushland Aspect
Air-Conditioning
New Carpets in Bedrooms
Solar 6.6KW
6,000L Water Tank
Termite Barrier

4 BED | 2 BATH | 2 CAR

PRICE:
\$651,500

OPEN FOR INSPECTION:
N/A



Natalie Johnston
0419689309
natalie@atrealty.com.au
[Natalieatrealty](#)

Ground Level



Total Living Area 14 sq mtr

Top Level

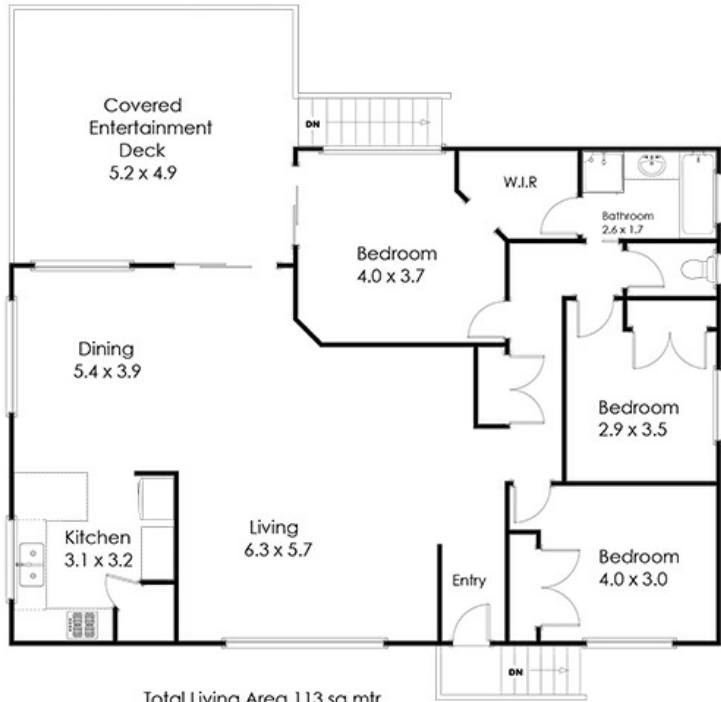

Total Living Area 113 sq mtr

1 Whip Bird Court Cashmere 4500

Whilst every attempt has been made to ensure the accuracy of the floor plan contained here, measurements of doors, windows rooms and any other items and structures are approximate and no responsibility is taken for any error, omission or mis-statement. Bathroom and kitchen fittings, cupboards and door types and laundry appliances and windows are tokens and approximate the actual fitting installed.
 This plan is for illustrative purposes and should be used as such by any prospective buyer.
 Plan drawn by Eagle Eye Photography Service, www.eagleeyehq.com.au Copyright 2020.
 All rights reserved.
 No reproduction without license, contact photographer for more information.



Disclaimer: Please note this floor plan is for marketing purposes and is to be used as a guide only. All dimensions are estimates only and may not be exact measurements.