

190 SOLDIERS ROAD, BASS, VIC, 3991



SOLD

PICTURESQUE COUNTRY ESCAPE – EXCEPTIONAL FAMILY LIFESTYLE HOBBY FARM

Located in the beautiful surroundings of Bass Coast, and set on approx. 77 acres of flat land that is well-established pasture and offering 10 paddocks and tree lines strategically planted to offer shelter to livestock without compromising the paddock space all with outstanding fencing, providing a perfect balance for any hobby farm. There is a large 90x45 industrial machinery shed and workshop that offers separate road access from the property, stockyards. 3 large water tanks, bore water system set up to fill all the water troughs on the property.

The charming home offers pristine farmhouse views from every window and features a large deck where you can imagine yourselves entertaining family and friends or simply just soaking up the rural lifestyle.

Interior added features include, polished timber floorboards, open plan kitchen with quality appliances, butler's pantry, and dining area with all the amazing views. 4 spacious bedrooms built-in robes, master with ensuite and WIR.

2 x reverse cycle split systems, double garage, and shed that would easily accommodate boats or caravans.

The homestead has been crafted to capture postcard-worthy nature outlooks and is located in a well sort after zoning of Bass.

A classic coast and country lifestyle awaits with this superb 77 acres and within close proximity to beaches, local shopping centers, and the hills that are scattered with boutique-style vineyards and produce suppliers.

NOTE- CORONAVIRUS PRECAUTION: If you are unwell or displaying any flu like symptoms, please do not attend our open for inspection.

Contact Daniel or Tamara Leskie to arrange your private inspection or live streamed virtual inspection

4 BED | 2 BATH | 4 CAR

PRICE:
\$1,450,000

OPEN FOR INSPECTION:
N/A



Tamara Leskie
0448809458
tamara.leskie@atrealty.com.au
www.atrealtypropertyexperts.com.au

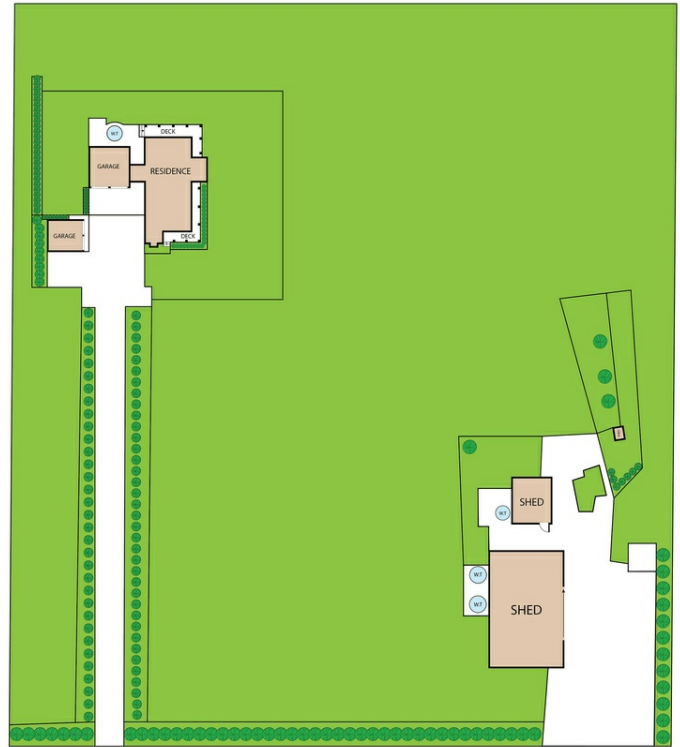

190 Soldiers Road, Bass VIC, Australia, 399

TOTAL APPROX. FLOOR AREA 296 SQ.M

Whilst every attempt has been made to ensure the accuracy of the floor plan contained here, measurements of doors, windows, rooms and any other items are approximate and no responsibility is taken for any error, omission, or misstatement. This plan is for illustrative purposes only and should be used as such by any prospective purchaser.

Disclaimer: Please note this floor plan is for marketing purposes and is to be used as a guide only. All dimensions are estimates only and may not be exact measurements.