

SOLD

RARE OPPORTUNITY

Found in the beautiful Genesis estate Coomera, this outstanding 5 bedroom, 3 bathroom home featuring 6 Kw of solar is perfect for the larger family who not only require space but also crave that ever important separation in living.

Upstairs you will find the master suite with a parents retreat, featuring a stylish dual basin en suite, a large walk in robe and air conditioning. Downstairs you will find the second master bedroom featuring dual basin en suite and walk in robe, large media room, open plan dining and living, kitchen with quality stainless steel appliances including a 900mm 5 burner cook top and oven, internal laundry, main bathroom, 3 remaining bedrooms and multiple storage options.

The covered entertaining area leads out to your fully fenced, secure backyard that boasts double gate side access, established gardens, vegetable gardens and fruit vines, 5,000ltr water tank as well as a good size garden shed and kids cubby sitting on a reinforced concrete slab.

Features include;

- * 5 x Bedrooms
- * 3 x Bathrooms
- * Double lock up garage with shelving and storage
- * Media room
- * Open plan dining and living
- * 6 kw Solar
- * Key less front door entry
- * Alarmed
- * 5,000 ltr water tank
- * Tiled living areas
- * Internal laundry
- * Quality stainless steel appliances including dishwasher and range hood
- * 900mm stainless steel 5 burner cook top and oven
- * 604m2 fully fenced secure block

* Located only 280m from the property is the \$3.5 million Genesis Residents' Club will be the hub for residents of all ages, providing an access point for recreation business and education. The Genesis Resident – Gymnasium - Business centre - Cinema room - Multi-purpose indoor/outdoor function area - Resort-style swimming pool and facilities - Onsite community

5 BED | 3 BATH | 4 CAR

PRICE:
\$640,000

OPEN FOR INSPECTION:
N/A



Scott Stonnell
0412224557

s.stonnell@atrealty.com.au
www.atrealty.com.au



Ground Floor

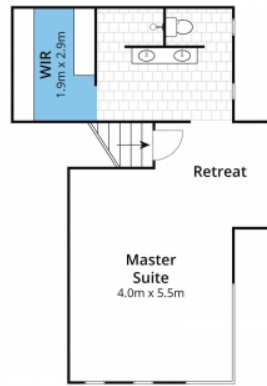

First Floor



Site Plan

Approx House Area 273m²
Approx Land Area 604m²

Whilst bwr.com.au has made every attempt to ensure the accuracy of the floor plan contained here, measurements are approximate and no responsibility is taken for any error, omission, or mis-statement. This plan is for illustrative purposes only.

23 Scenic Crescent, Coomera



Disclaimer: Please note this floor plan is for marketing purposes and is to be used as a guide only. All dimensions are estimates only and may not be exact measurements.

Scott Stonnell
0412224557
s.stonnell@atrealty.com.au
www.atrealty.com.au

