



**SOLD**

## FANTASTICALLY LARGE PRIVATE REAR BALCONY

Positioned at the rear of the Sphere complex, in the pet friendly Casuarina building, this private 1st floor unit backs onto the treed Musgrave Parklands park and reserve. Both bedrooms and the living area open out to a large balcony, perfect for entertaining. The well equipped kitchen has stone benches, gas hob, microwave, insinkerator, and a double draw dishwasher. Both the living room and the master bedroom have split system air conditioning units. You won't need a gym membership with the complex having resort style facilities, fantastic recreational areas, a 25m lap pool, spa, sauna and steam rooms, BBQ area. An elevator in the building gives lift access to your unit and the basement garage, no stairs to climb! Bonus of 2 car parking spaces and a lockable storage cage, for extra storage.

2 bedrooms, master with ensuite and mirrored walk thru robe

Large additional bathroom

Separate laundry with dryer included

Air conditioned and ceiling fans

2 study nooks, 1 in the master bedroom

Large balcony

Expected rental return approx. \$450 per week.

A short 15 minute stroll to Griffith University, both the Gold Coast Private Hospital and the Gold Coast University Hospital, and the Light Rail. Sharks Football Club and Woolworths Supermarket are only a 10 minute walk. Harbour Town and Westfield, and the Helensvale Railway Station and M1 are only a 10 minute drive. Gold Coast beaches only a 15 minute dr.

Give me a call to make Casuarina Sphere your new home.

**2 BED | 2 BATH | 2 CAR**

**PRICE:**  
\$385,000

**OPEN FOR INSPECTION:**  
N/A



**Chris Murray**

**0416068420**

[chrismurray@atrealty.com.au](mailto:chrismurray@atrealty.com.au)

[www.atrealty.com.au](http://www.atrealty.com.au)

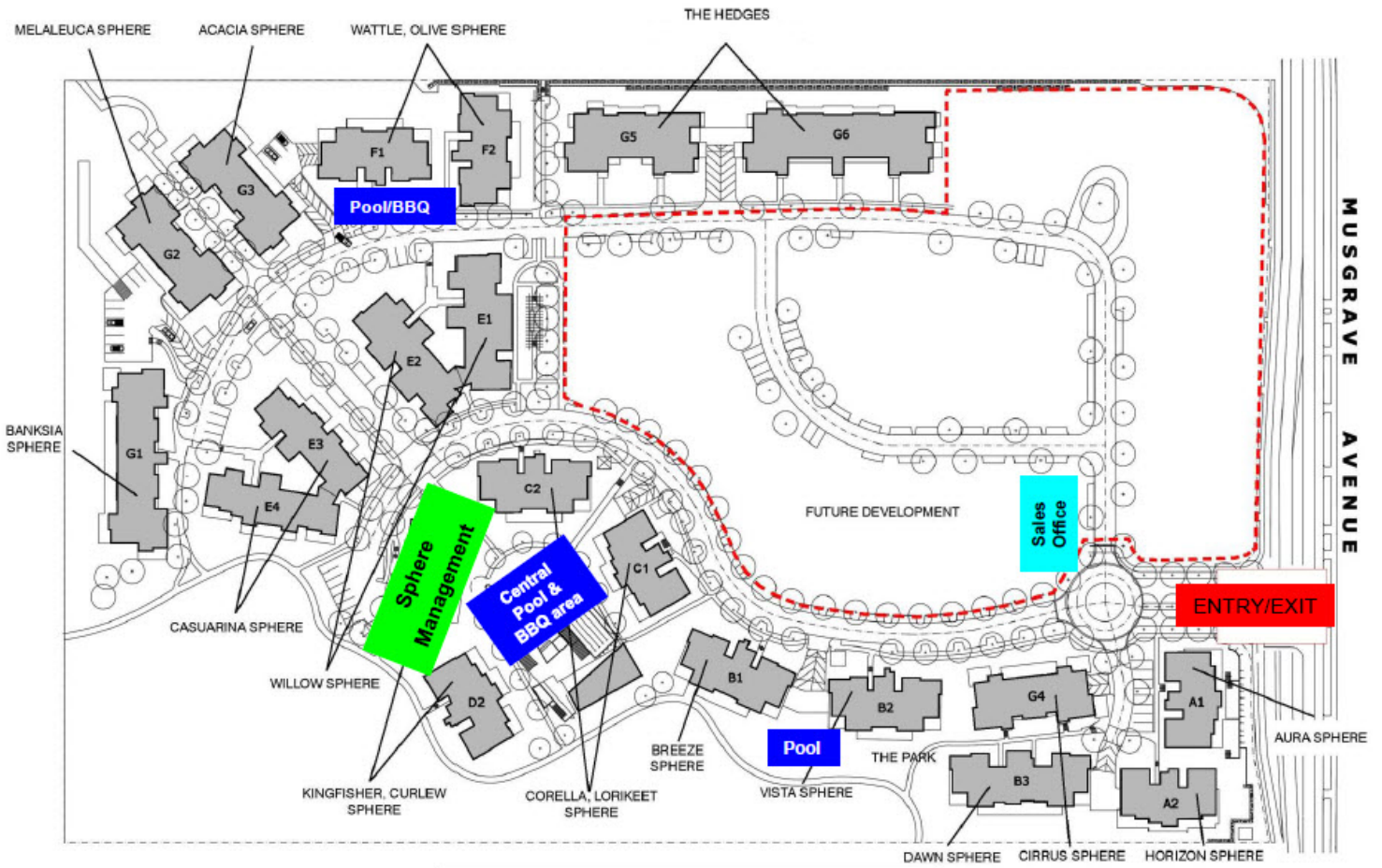

Disclaimer: Please note this floor plan is for marketing purposes and is to be used as a guide only. All dimensions are estimates only and may not be exact measurements.