



# FOR SALE

## COMFORT & PRACTICALITY FOR THE WHOLE FAMILY

This tastefully designed family home exudes comfort & practicality from entry to exit. Spread over an impressive easy flow floor plan, the natural aesthetics of the home are complemented by its vibrant, modern features that can be adorned at every turn. It's use of space has been maximised encompassing family living with each family member's own space within the home. The location is enviable and the home's superb setting is to be admired, having been built by Wisdom Homes, you know the quality will not disappoint.

### Features Include:

- Boasting four generously proportioned bedrooms with built in robes & ceiling fans
- The master suite includes an ensuite with dual basins, a walk in robe & ceiling fan
- Separate study or home office with built in cabinetry
- Media room
- Games room / teenagers retreat
- Spacious family room with ceiling fan
- Dining room
- Practical kitchen with ample cupboard & bench space
- Soft closing cupboards
- Pantry
- 900ml Stainless steel gas cooktop & oven
- Stone benchtops
- Breakfast bar overlooking the dining room
- Main bathroom includes a bath tub & separate toilet
- Internal laundry
- Tiled throughout the main living areas
- Ducted air conditioning with 2x zones
- Alarm system
- Undercover alfresco with timber decking, LED downlights & ceiling fans
- Semi enclosed front yard
- Front porch with a sunny disposition
- Double remote garage with internal access
- Fantastic sized backyard
- Established gardens with a water irrigation system to front & backyard

4 BED | 2 BATH | 2 CAR

### PRICE:

\$760,000 - \$780,000

### OPEN FOR INSPECTION:

N/A



**Bobby Reynolds**

**0432173566**

bobby.reynolds@atrealty.com.au

[agencycentralwilton.com.au](http://agencycentralwilton.com.au)

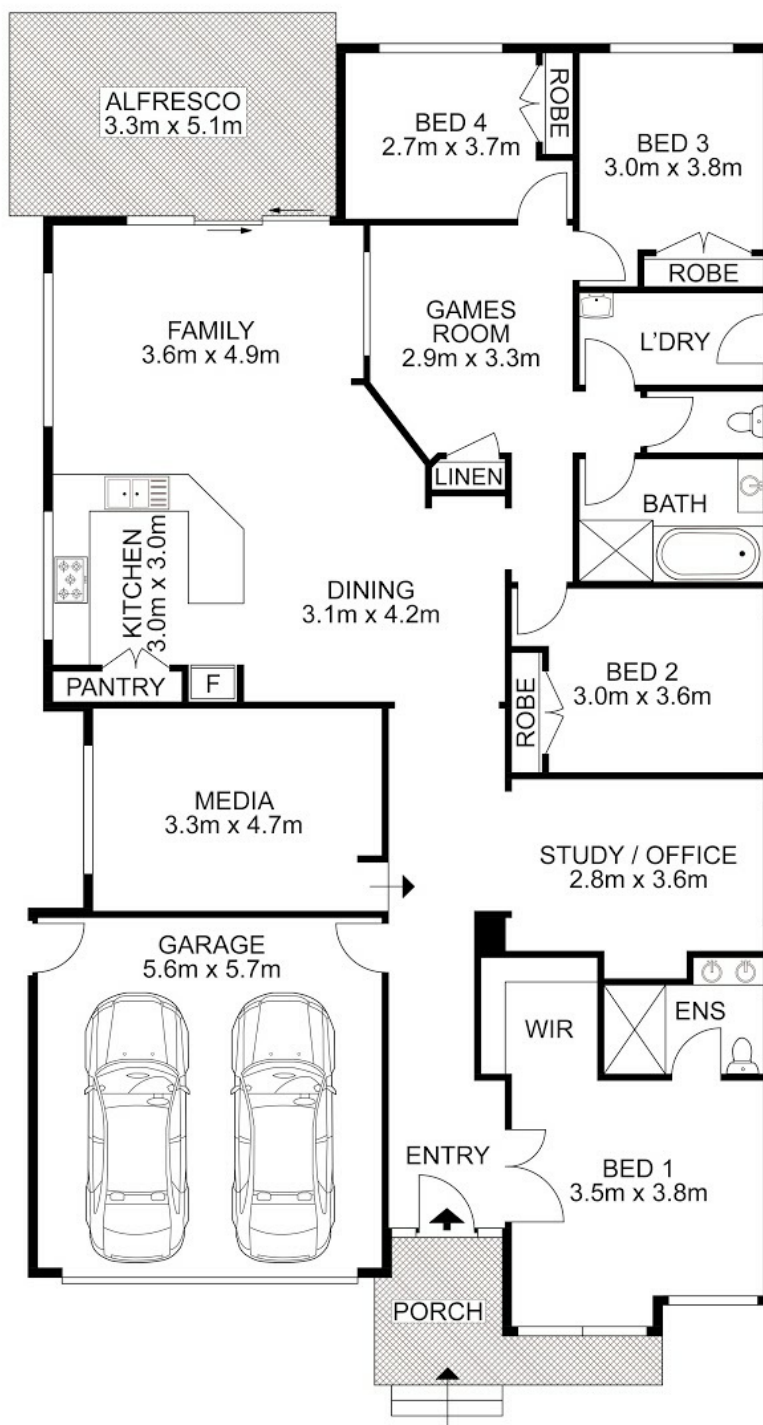

**AGENCY**

Disclaimer: Please note this floor plan is for marketing purposes and is to be used as a guide only. All dimensions are estimates only and may not be exact measurements.

**34 Greenbridge Drive, Wilton**

**Bobby Reynolds** All measurements are approximate • Drawn for marketing purposes only

**0432173566**

bobby.reynolds@atrealty.com.au

agencycentralwilton.com.au

