

Approx House Area 227m<sup>2</sup>  
 Approx Land Area 608m<sup>2</sup>  
 Whilst [bwrn.com.au](http://bwrn.com.au) has made every attempt to ensure the accuracy of the floor plan contained here, measurements are approximate and no responsibility is taken for any error, omission, or mis-statement. This plan is for illustrative purposes only.

**57 Azure Way, Pimpama**



**SOLD**

**DUAL KITCHENS, DUAL BATHROOMS, DUAL LOUNGES, DUAL LIVING**

An outstanding dual living opportunity presents itself in the highly sought-after Pacific Cove Estate.

Sitting on a 608m<sup>2</sup> block this immaculately presented family home offers a totally unique floor plan featuring 5 bedrooms, 3 bathrooms, 2 kitchens, multiple living areas, butler's pantry, internal laundry, office, BBQ area, solar and much much more...

A walk through is an absolute must to experience, feel and see exactly what 57 Azure Way Pimpama really has to offer.

Some of the many features include;

- \* 5 Bedrooms all air conditioned with build in robes
- \* Master Bedroom with dual basin en suite and walk in robe
- \* Kitchens features Cesar stone bench tops, 2 pak soft close cabinetry
- \* 900mm stainless steel 6 burner cook top, oven, range hood and dishwasher
- \* 3 Bathrooms
- \* Internal Laundry
- \* Office
- \* 6.5 kW Solar
- \* 2 x Covered Entertaining areas
- \* Courtyard
- \* Pizza oven & BBQ
- \* Fully fenced secure yard

Contact agent to receive your copy of the property information kit

**5 BED | 3 BATH | 4 CAR**

**PRICE:**  
**\$680,000**

**OPEN FOR INSPECTION:**  
 N/A



**Scott Stonnell**  
**0412224557**  
 s.stonnell@atrealty.com.au  
[www.atrealty.com.au](http://www.atrealty.com.au)

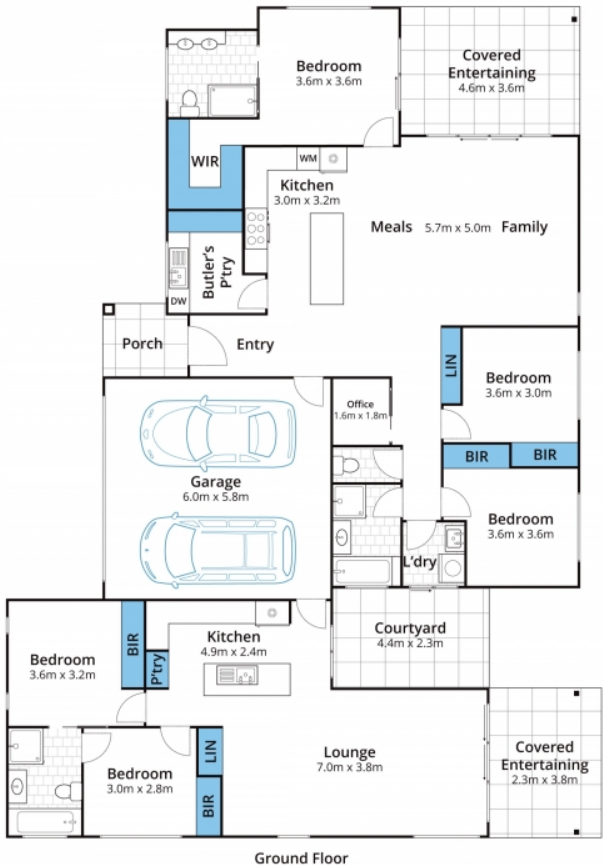

Ground Floor

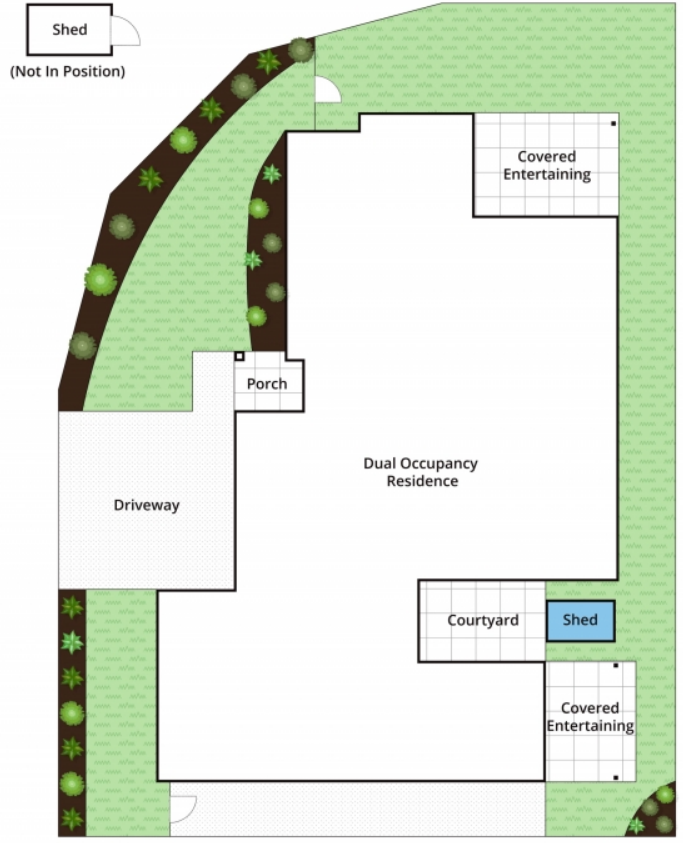

Site Plan

Approx House Area 227m<sup>2</sup>  
Approx Land Area 608m<sup>2</sup>

Whilst [bwrn.com.au](http://bwrn.com.au) has made every attempt to ensure the accuracy of the floor plan contained here, measurements are approximate and no responsibility is taken for any error, omission, or mis-statement. This plan is for illustrative purposes only.

## 57 Azure Way, Pimpama



Disclaimer: Please note this floor plan is for marketing purposes and is to be used as a guide only. All dimensions are estimates only and may not be exact measurements.

Scott Stonnell  
0412224557  
s.stonnell@atrealty.com.au  
[www.atrealty.com.au](http://www.atrealty.com.au)

