

4/47-49 TWEED STREET COOLANGATT

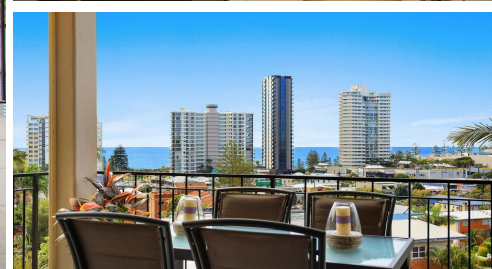

MICHELLE TOPPER
REAL ESTATE



FOR SALE

NORTH / EAST FACING 144M2 BOUTIQUE
APARTMENT WITH VIEWS OF COOLANGATTA

TBA

2 BED | 2 BATH | 2 CAR

PRICE:
\$810,000

OPEN FOR INSPECTION:
N/A



Michelle Topper
0400362639
michelle.topper@atrealty.com.au
www.atrealty.com.au

4/47 Tweed Street, Coolangatta

2 2 2

internal: 125 m² | external: 22 m² | garage: 36 m² | total: 183 m²

MICHELLE TOPPER
REAL ESTATE
0400 362 639

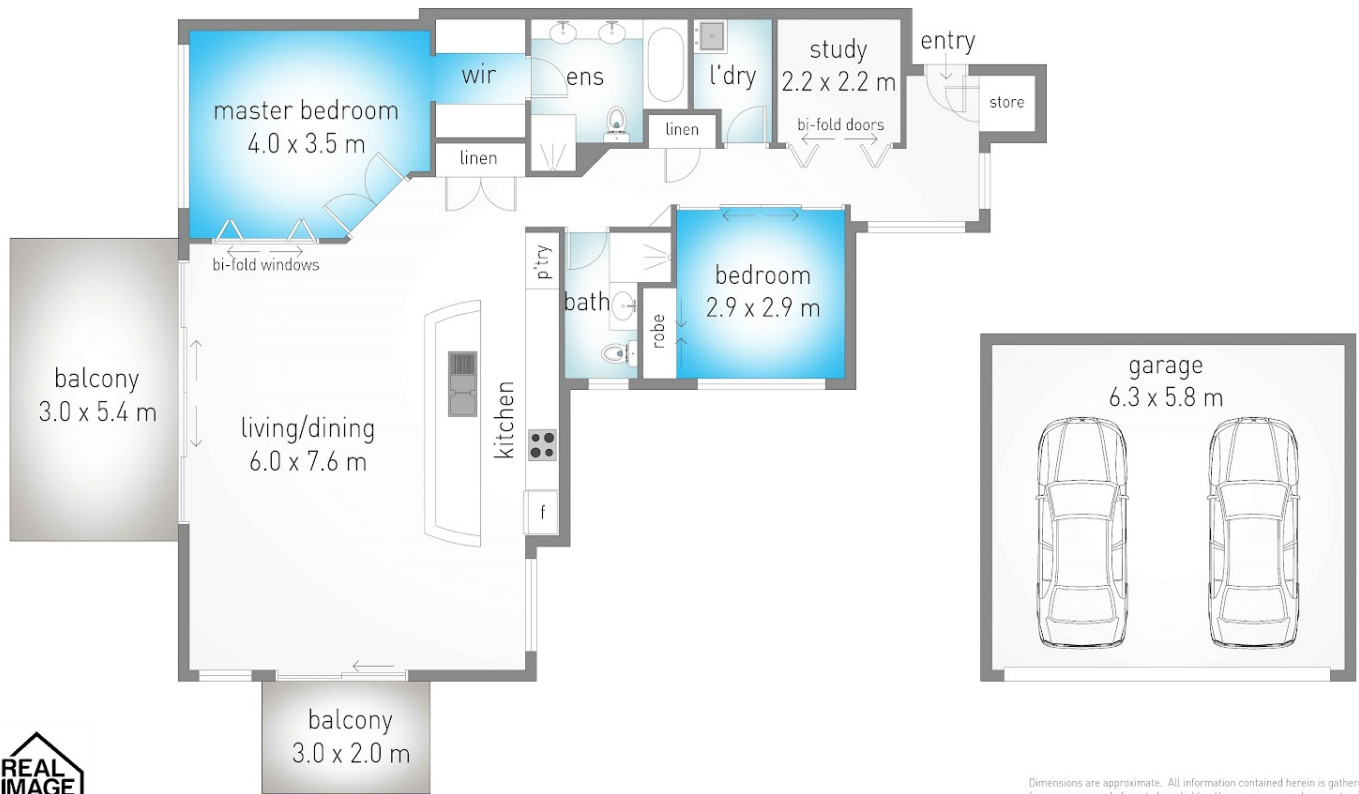

Dimensions are approximate. All information contained herein is gathered from sources we believe to be reliable. However we cannot guarantee its accuracy and interested persons should rely on their own enquiries.

Disclaimer: Please note this floor plan is for marketing purposes and is to be used as a guide only. All dimensions are estimates only and may not be exact measurements.