

SOLD

BLURRED LINES: URBAN LOCATION, COUNTRY FEEL!

Have you been dreaming of waking up each day in your own private sanctuary? Would you believe me if I told you it's possible to live that dream AND be just minutes away from everything you'll ever need?

Make a move and live your dream at 669a Maudsland Road.

The 2 bedroom, 1 bathroom home currently here may fulfil that dream for some. If your needs are surplus to what's on offer, you can run wild with your imagination and build yourself a castle - the choice is yours.

The current owner says "the reason I fell in love with this property is because of what Mother Nature has provided... the gentle slope of the block provides a wonderful outlook from every corner and I've often caught myself just staring for long periods of time, totally caught up in the beauty of this place."

Despite loving it so much, the seller's committed to another opportunity and must see this one sold ASAP.

PROPERTY INFRASTRUCTURE:

- Generous 8,050m² parcel of land
- 2 generous sized bedrooms
- Quality bathroom and laundry
- Kitchen with stainless steel appliances
- Double bay shed approx. 6m x 9m
- Split system, reverse cycle air-conditioning
- Water tank
- Live in as is or great opportunity to create a truly unique home
- Currently rented for \$430per week

LOCATION & INFRASTRUCTURE:

- 5 minutes to local shops
- 5 minutes to Petrol Station

2 BED | 1 BATH | 2 CAR

PRICE:
\$500,000

OPEN FOR INSPECTION:
N/A



Jayson Edwards
0423763830
jaysonedwards@atrealty.com.au
www.atrealty.com.au

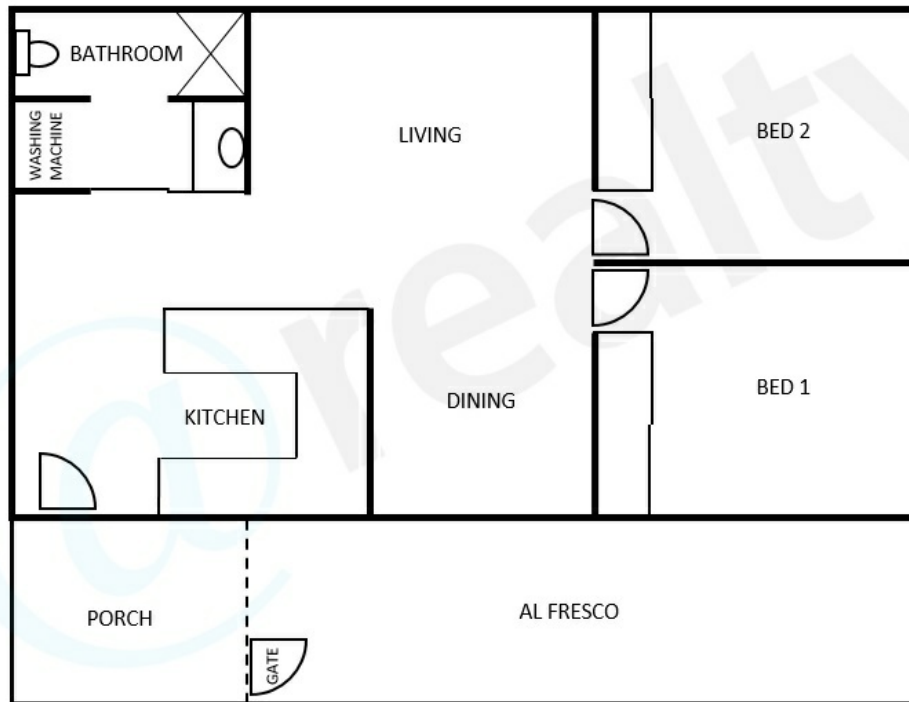

Disclaimer: Please note this floor plan is for marketing purposes and is to be used as a guide only. All dimensions are estimates only and may not be exact measurements.