

20 NYMBOIDA CRESCENT RUSE



FOR SALE

FANTASTIC HOME ON GREAT SIZE CORNER BLOCK

This well presented family home is situated on a 568sqm corner block in one of Ruse's leafy, quiet & enviable pockets. Spread over a busy and impressive floorplan it is packed with wonderful features and inclusions found at every turn. Never short of space, there is enough room for the whole family to come together.

Features Include:

- Front porch overlooking the front yard
- Four generously proportioned bedrooms
- Master suite includes a built in robe, ensuite & ceiling fan
- Spacious living room
- Built in bar area
- Galley style kitchen with ample cupboard & bench space
- Stainless steel dishwasher
- Pantry
- Meals area off kitchen
- Main bathroom includes bathtub
- Separate toilet
- Internal laundry
- Ducted air conditioning
- Timber floorboards
- Solar panels
- Internal storage throughout
- Enclosed Queenslander room with air conditioning
- Enclosed entertaining alfresco with timber decking
- Enclosed in-ground swimming pool
- Low maintenance backyard
- Single lock up garage with internal access
- Workshop in garage
- Manicured gardens
- 568sqm block

This fantastic home is located in the family friendly suburb of Ruse. Within close proximity are

4 BED | 2 BATH | 2 CAR

PRICE:

Just Listed

OPEN FOR INSPECTION:

N/A



Huss Al Salemi

0411699419

huss@atrealty.com.au

www.agencycentral.com.au

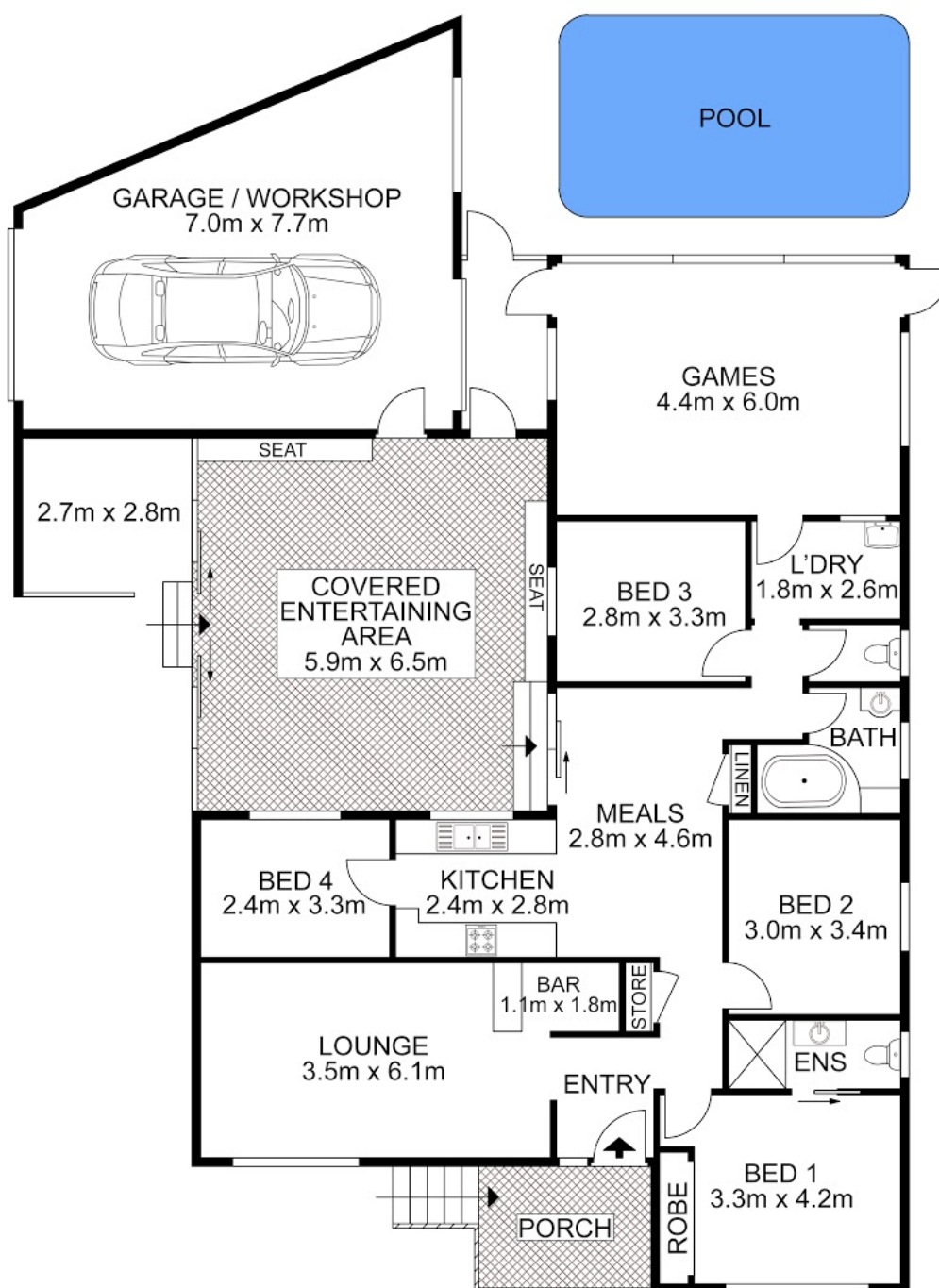

AGENCY

Disclaimer: Please note this floor plan is for marketing purposes and is to be used as a guide only. All dimensions are estimates only and may not be exact measurements.

20 Nymboida Crescent, Ruse

Huss Al Salemi • All measurements are approximate • Drawn for marketing purposes only

0411699419

huss@atrealty.com.au

www.agencycentral.com.au

