



## FOR SALE

### 3 LARGE LIVING AREAS

Follow this link for the property video on YouTube - <https://youtu.be/KqsEmEbTmCo>

Remember to follow us on Facebook for more - [www.facebook.com/babetbrothersrealestate](http://www.facebook.com/babetbrothersrealestate)

This property has it all! Do not miss out on this fantastic opportunity!

As they say LOCATION LOCATION LOCATION!

Within easy walk to Hampton park shops, Hallam train station and local parks and walking tracks. Less than a five minute drive to Hampton Park Secondary College, Hampton Park Primary School, Westfield Fountain Gate and Narre warren train station. The Monash Freeway, Princess Highway and South Gippsland Hwy are literally minutes away.

This home has amazing real polished hard wood floors through the main living areas, and beautiful slate flooring in the kitchen and meals area.

- 4 generous bedrooms, master with large ensuite and walk in wardrobe; other bedrooms have double built in robes.

- Beautiful kitchen in the heart of the home with top of the range finishes, stainless steel appliances, dishwasher and ample storage.

- THREE LIVING AREAS! Including formal lounge with two separate family areas and meals area.

- Beautifully renovated bathroom with top of the range fixtures and fittings, large laundry with lot of storage space.

- Enjoy an impressive lifestyle with the ease of a massive low maintenance yard offering plenty of privacy.

- Ducted heating & evaporative cooling throughout the house, also accompanied by a roaring fire

4 BED | 2 BATH | 4 CAR

PRICE:

\$580,000 - \$620,000

OPEN FOR INSPECTION:

N/A



**Matt Babet**

**0401861185**

[mattbabet@atrealty.com.au](mailto:mattbabet@atrealty.com.au)

[www.atrealty.com.au](http://www.atrealty.com.au)

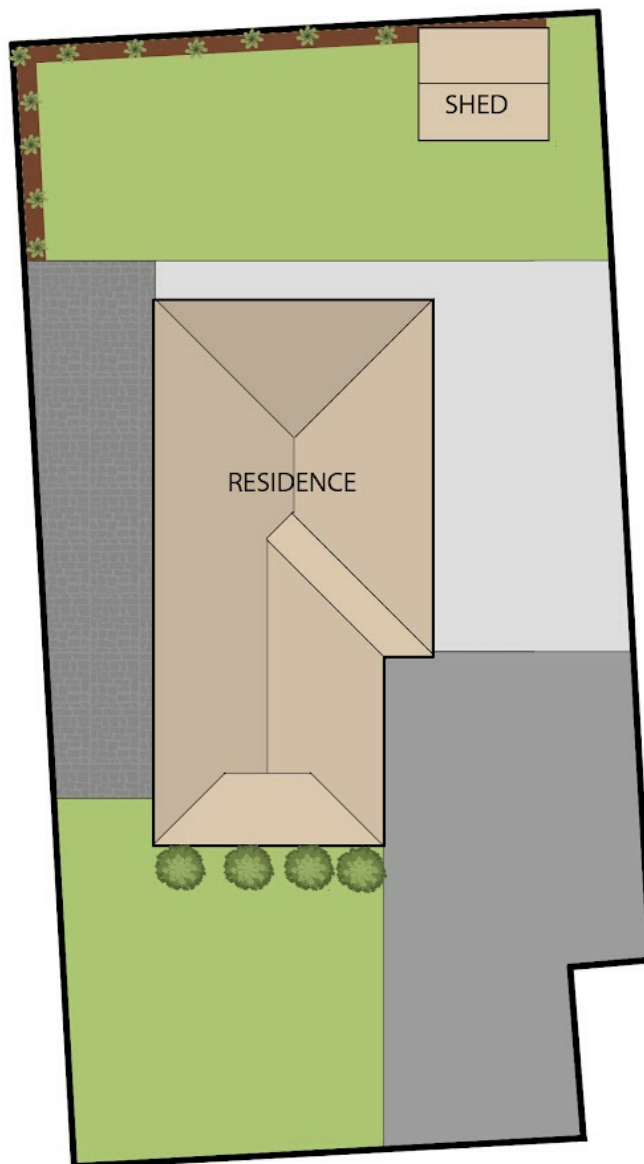
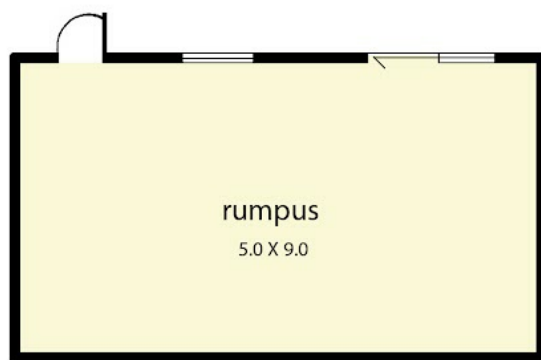

Disclaimer: Please note this floor plan is for marketing purposes and is to be used as a guide only. All dimensions are estimates only and may not be exact measurements.

## 14 Cotham Square, Hampton Park

Produced by DND Floor Plans.

**Matt Babet**

0401861185

mattbabet@atrealty.com.au

[www.atrealty.com.au](http://www.atrealty.com.au)

