



SOLD

LARGE 5 BEDROOM QUEENSLANDER @ NORTH IPSWICH

Positioned on a comfortable 506m² block in the historical suburb of North Ipswich, you will find "YULUWIRREE" (aboriginal for rainbow). The house was built by Frank Porter in 1890 and proudly handed down through the generations. This is a great property, the perfect family home.

NEW carpet, NEWLY painted inside, NEW vinyl, Free from flooding, you will find this special property still on the Heritage trail of Ipswich and proudly has previously been awarded the Awards for Excellence in Design & Heritage Conservation, Certificate of Merit for 1992, awarded by Ipswich City Council Mayor, Bill Hayden.

Being only the third time the house has been up for sale, it is now a great opportunity for someone to give this house its next generation of memories. Families that come to this house and area tend stay long term and I'm sure yours will too.

All the characteristics you would expect from a property built in this era, from the three-sided bull nose verandah, T&G walls with picture rails, floor boards to the majority of the house, to the ornate fretwork pieces above internal doors to the majestic stained glass windows and stained glass French doors leading to the verandah.

The house itself comprises of 5 bedrooms, 4 of which have stained glass French doors that open onto the verandah. The family/dining room, located to the rear of the property was originally the back verandah, and is now an expansive family room with an air conditioning unit and two fans.

5 BED | 1 BATH | 2 CAR

PRICE:
\$395,000

OPEN FOR INSPECTION:
N/A



Giles Gargan
0403258037
giles@atrealty.com.au
gilesgargan.com.au

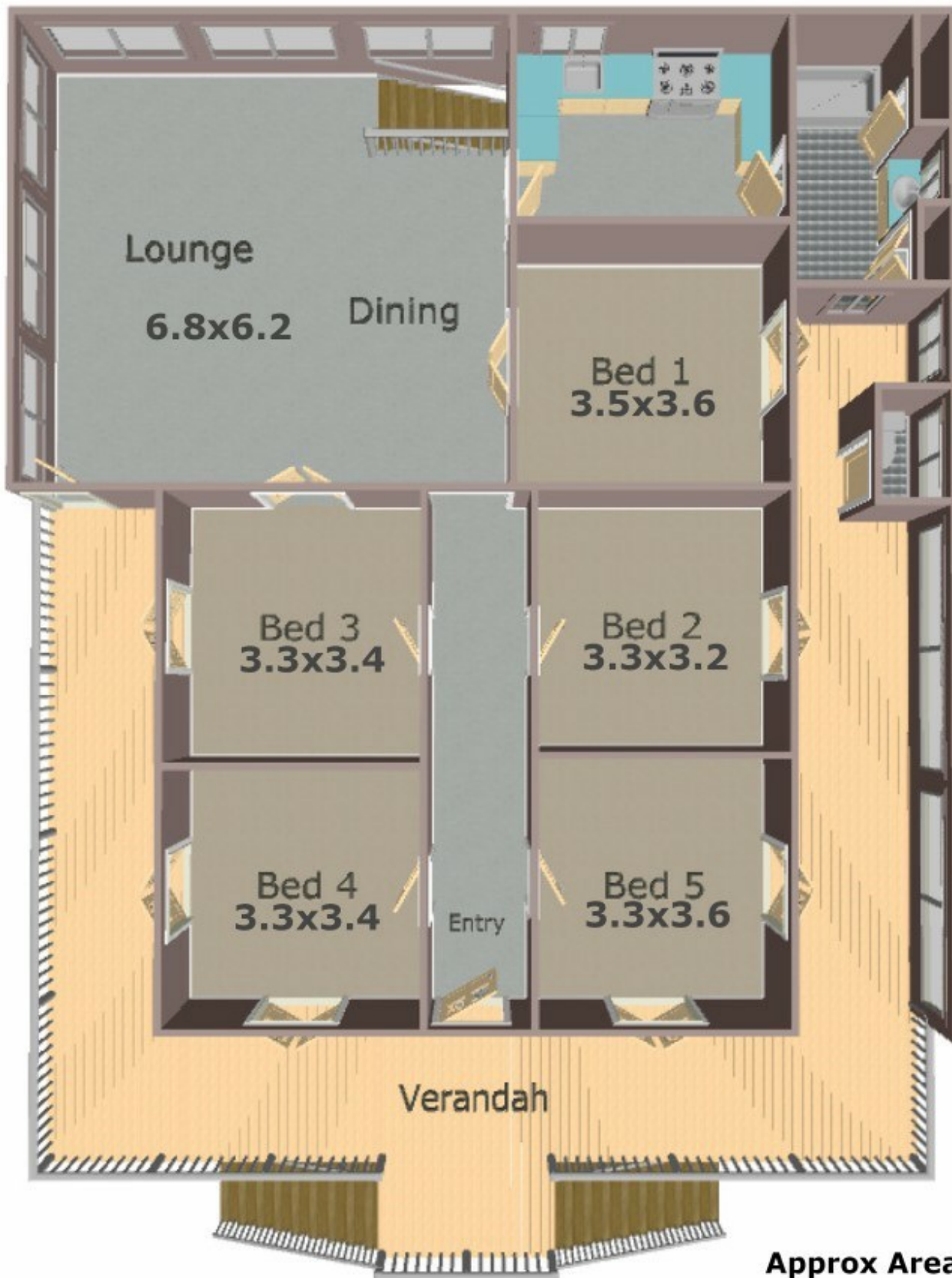

Approx Areas:

Internal 135 sq m
Verandah 70sq m

Disclaimer: Please note this floor plan is for marketing purposes and is to be used as a guide only. All dimensions are estimates only and may not be exact measurements.