



**SOLD**

## LUXURY LIVING IN BRISBANE SOUTH STATE SECONDARY COLLEGE CATCHMENT

Enjoy a spacious living and low maintenance lifestyle in this boutique complex. This beautifully presented 209 sqm townhome ticks all the boxes for accommodation, location and only a short walk to Fairfield Gardens with a choice of train, bus and abundant café culture.

- \* North facing, open plan living with natural light & cooling breezes
- \* Contemporary kitchen features stone bench tops, gas cooktop & built in microwave
- \* Choices of 3 outdoor living areas – 2 balconies and a courtyard
- \* 2.7 m ceiling, fully ducted air-conditioning & ceiling fans
- \* Elegant fully tiled bathrooms with shaving cabinet, beautiful timber stairs & square set cornices
- \* Generous bedrooms with mirror built-in robe, master bedroom with ensuite
- \* Study & epoxy garage flooring
- \* Boutique complex of 7 townhouses
- \* Body corporate levy \$715 per qtr
- \* Close to Fairfield Gardens, train, bus, parklands, sporting facilities, popular cafes & restaurants
- \* Brisbane (Inner City) South State Secondary College catchment

Be quick, join in the exciting Fairfield lifestyle and view this exception modern townhome now!

**3 BED | 2 BATH | 2 CAR**

**PRICE:**  
\$646,000

**OPEN FOR INSPECTION:**  
N/A



**Danson Kwok**  
**0434675557**  
dansonkwok@atrealty.com.au  
[www.atrealty.com.au](http://www.atrealty.com.au)

SECOND FLOOR  
(CEILING HEIGHT 2.7m)

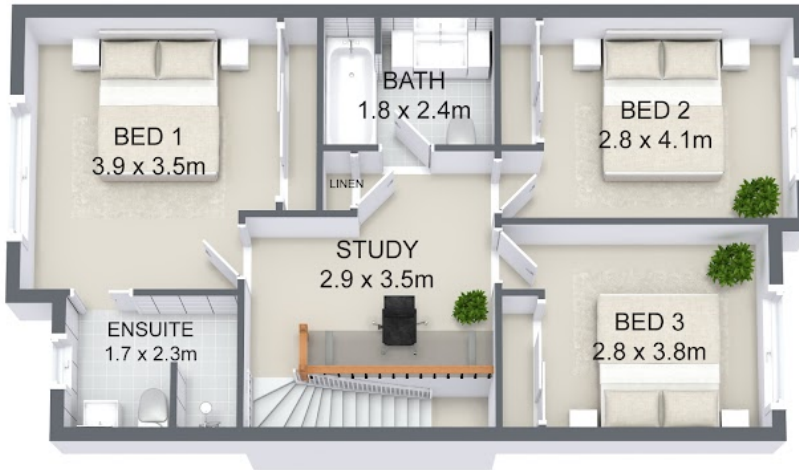

FIRST FLOOR  
(CEILING HEIGHT 2.7m)



GROUND FLOOR  
(CEILING HEIGHT 2.4m)

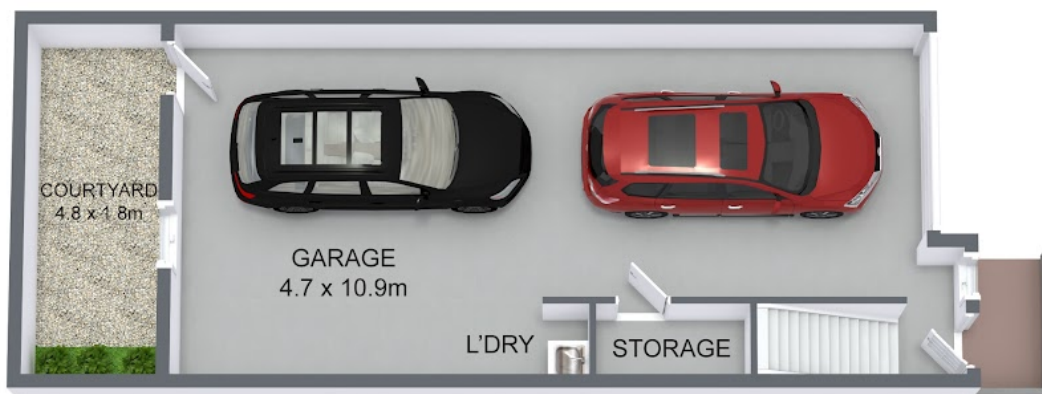

Floor Area (Approx.)  
Internal: 171 sqm  
Balcony: 26 sqm  
Courtyard: 12 sqm



Disclaimer: Please note this floor plan is for marketing purposes and is to be used as a guide only. All dimensions are estimates only and may not be exact measurements.

should not be used as a sole and accurate reference. Interested parties should make their own inquiries using independent sources.

2/91 Mildmay Street, Fairfield

Danson Kwok  
0434675557  
dansonkwok@atrealty.com.au  
[www.atrealty.com.au](http://www.atrealty.com.au)

Plan by capturerealty.com.au

