



SOLD

SOLD BY KRIS SUTCLIFFE & AMANDA ROBERTS

Live LARGE in the Riverbanks Estate.

Situated in the popular Riverbanks Estate, in Caboolture's South is this gorgeous family style home.

Built by coral homes approximately 4 years ago, it is clear a lot of thought, time and money was put into the design, features and finishes of this one!

Featuring a modern kitchen with island bench, 900mm gas cooktop and electric oven, stainless steel appliances, overhead cupboards and large stone benches.

The stone continues through to the main bathroom, en-suite and even the laundry!

Living is second to none thanks to a large open plan living and dining plus a separate media and a good size alfresco living (under roof).

The home features 4 good sized bedrooms, all with built in robes plus a very handy study nook with built in bench, data points and concertina doors to hide the mess when guests come to visit.

The master suite is fit for a king and generally a really nice place to be. Featuring a handy "walk around" wardrobe with plenty of hanging + full length shelves, and an en-suite bathroom to die for. With a floating vanity, his and hers sinks, extra large shower, full sized bath and tiles to the ceiling. A clever separate toilet design gives the element of privacy, without detracting from the overall space.

Approximately 235sqm under roof, this plan is far from small!

All set on a large 511sqm block, fully fenced and landscaped, just minutes walk from local parks and a short drive to local shops and the Bruce Highway for daily commuters.

Features at a glance:

- 4 good sized bedrooms all with built in robes
- Master bedroom with walk around robe, luxurious en-suite bathroom and sliding doors to the

4 BED | 2 BATH | 2 CAR

PRICE:
\$425,000

OPEN FOR INSPECTION:
N/A



Kris Sutcliffe
0437338665

kris.sutcliffe@atrealty.com.au
www.atrealty.com.au

STEEL FRAME AND TRUSSES.
 WINDFORCE:
 DIRECTION 1 : 63.6KN
 DIRECTION 2 : 23.4KN
 ULW : 5100
 RLW : 5827

N2.
 ELEVATIONS
 AVOCA 25

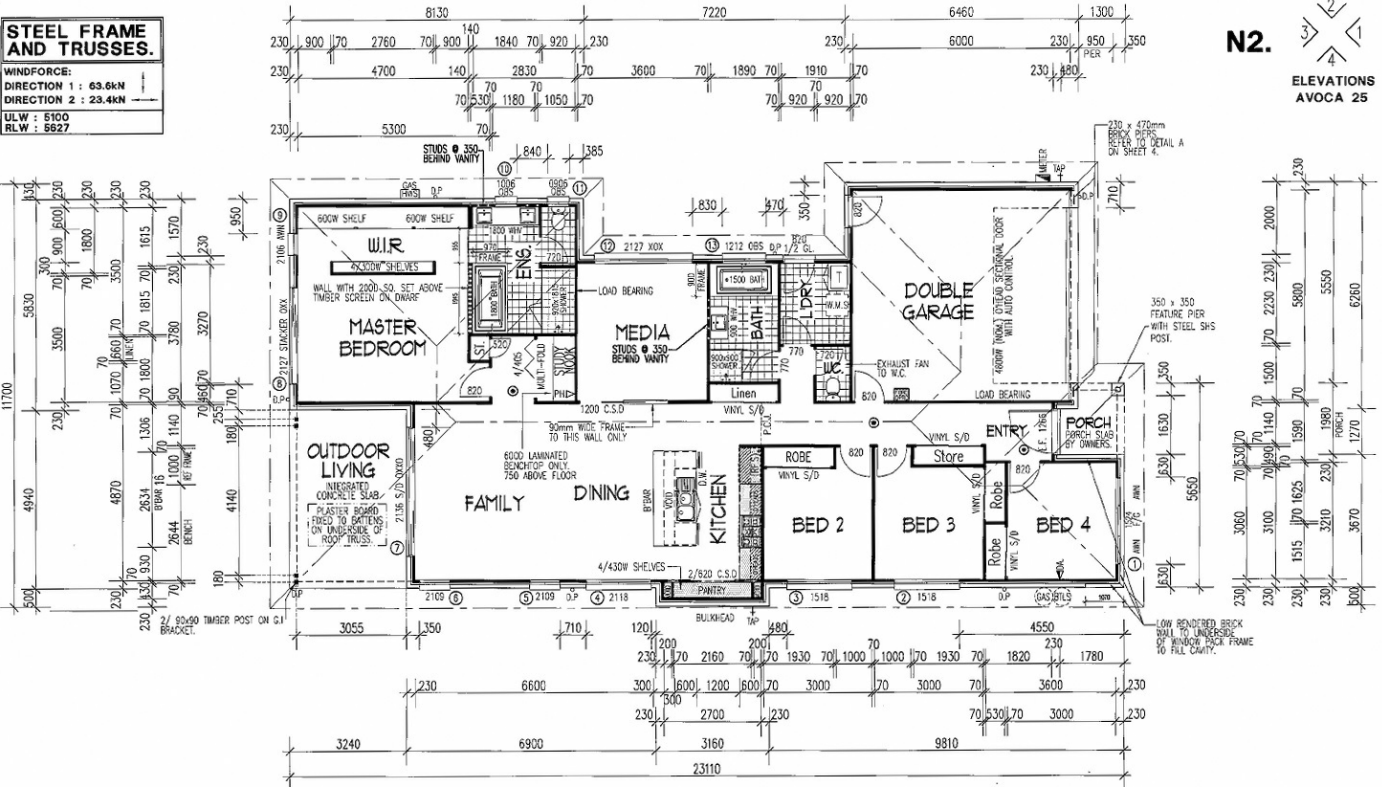

- LEGEND**
- REF. FRIDGE PROVISION
 - W.D. WALL OVER TOP
 - MW. MICROWAVE PROVISION
 - D.W. DISHWASHER PROVISION
 - B.B.H.R. BREAKFAST BAR
 - M.W. WASHING MACHINE PROVISION
 - D.P. DOWNPIPE
 - G.S. GLASSING
 - ANN. ANNEX WINDOW
 - F/C. FIXED GLASS TO ALL PANELS
 - D/G. DOUBLE GLAZED WINDOW
 - P.S. SET WINDOW REVEAL (SUITS TILING)
 - S. CLASS SLIDING PANEL
 - S/D. CLASS SLIDING DOOR (EXTERNAL)
 - I.D. INTERNAL CHAITY SLIDING DOOR
 - S.S. SET 3000 SQUARE SET PIRBOARD BULKHEAD
 - S.D. SIZE OF TIMBER DOOR (M27H)

NOTES

WRITTEN DIMENSIONS WILL TAKE PRECEDENCE OVER SCALE.
 ALL INTERNAL DIMENSIONS STATED ARE FRAME SIZE - EXCLUDING LININGS.
 ALL WINDOWS TO BE SLIDING UNITS.
 FREE OPTIC NETWORK TO HOUSE.
 QUEEN INSTANT GAS H.W.S.
 GAS CONNECTION TO H.W.S. & OWNER COOKER

FLOOR PLAN LAYOUT.

AREA:-

- LIVING:- 177.86m²
- GARAGE:- 35.21m²
- PORCH:- 3.18m²
- OUTDOOR:- 16.01m²

TOTAL AREA:- 235.26m²
PER LENGTH:- 73.72m
ROOF AREA:- 274.35m²
PER LENGTH:- 76.18m

VENTURA FACADE



JOINERY DETAILS REFER SHEET 5
KITCHEN DETAILS REFER SHEET 6
WET AREA DETAILS REFER SHEET 7

THE COPYRIGHT IN THIS SET OF DRAWINGS IS OWNED BY THE CORAL HOMES GROUP. THESE DRAWINGS MAY NOT BE REPRODUCED, COPIED, / SCANS WITH IN ANY MANNER WITHOUT WRITING THE EXCLUSIVE RIGHTS OF THE CORAL HOMES GROUP IS PRESERVED BY THE COPYRIGHT ACT 1969. BY THE EXPRESS WRITING AUTHORIZATION OF THE CORAL HOMES GROUP.

FINAL SIGNED COPY

I/WE ACCEPT THAT THESE PLANS ARE THE FINAL WORKING DRAWINGS THAT SUPERSEDE PRELIM PLANS & I/WE HAVE CHECKED FOR ANY ALTERATIONS OR ADDITIONS ARE SHOWN.

THESE PLANS ALSO FORM PART OF OUR CONTRACT BETWEEN THE PROPRIETOR & CORAL HOMES.

PROPRIETOR SIGNATURE: _____ PROPRIETOR SIGNATURE: _____
 BUILDERS SIGNATURE: _____ THESE PLANS REMAIN COPYRIGHT OF THE CORAL HOMES GROUP

CLIENTS

TENDER LETTER: 10-9 FEB 2016

DRAWING: FLOOR PLAN LAYOUT REFERENCE NO. J25147

SCALE: 1:100 DATE: 02/02/16 DP

DRAMA: 1/16

EXPRESS: 1 OF 7

© THE CORAL HOMES GROUP ALL RIGHTS RESERVED.

Disclaimer: Please note this floor plan is for marketing purposes and is to be used as a guide only. All dimensions are estimates only and may not be exact measurements.

Kris Sutcliffe
 0437338665
 kris.sutcliffe@atrealty.com.au
 www.atrealty.com.au

