

**SOLD**

## STYLISH AND SPACIOUS FAMILY HOME IN HIGHLY DESIRABLE SEASIDE TOWN

Located in the heart of Woolgoolga, only minutes to the CBD and under 2 minutes drive to some of the East Coast's best beaches sits 30 Strawberry Close, a stylish and spacious family home in a quiet cul-de-sac location.

Experience this custom-designed, one of a kind home that features generous bedrooms, multiple living areas and extended entertaining zones - whether you're indoor or outdoor there's room to entertain.

From the downstairs games room and fully-functional bar, to the intelligently designed and well-appointed bedrooms this home has something that everyone will love.

Be spoilt by the beautifully crafted Koi Fish Pond and Bridge in the entrance, to the carefully manicured, tiered garden, you will be amazed by every inch of this property and how stunning style has been incorporated into this relatively low maintenance block set on 987 perfectly utilised square metres.

This lovely home boasts:

- Modern and stylish home with clever design and minimal maintenance
- Grand entrance well-lit and guarded by mature Palm Trees
- Five separate yet generous bedrooms with built-ins - sparsely separated for a family that likes privacy
- King-sized master-suite features walk-in robe and sleek and modern En-suite
- DLUG with turning bay for easy access and adequate built-in storage plus internal access
- Undercover carport leads to fully-secure storeroom ideal for tools and valuables
- Solid-built brick home with some parts Colorbond offer modern style
- Double-head shower and vanity to match with working spa bath
- Modern kitchen with ageless island Granite bench-top
- Plenty of pantry space and storage for a large family
- Fans throughout and Reverse-Cycle Air-con available upstairs allow for an ideal temperate environment
- 2.2kw Solar allows for great savings on electricity - further panels could be installed to use this feature to its fullest potential

5 BED | 3 BATH | 3 CAR

PRICE:  
\$770,000

OPEN FOR INSPECTION:  
N/A



**Jack Anderson**  
**0447099106**  
jackanderson@atrealty.com.au  
[www.atrealty.com.au](http://www.atrealty.com.au)

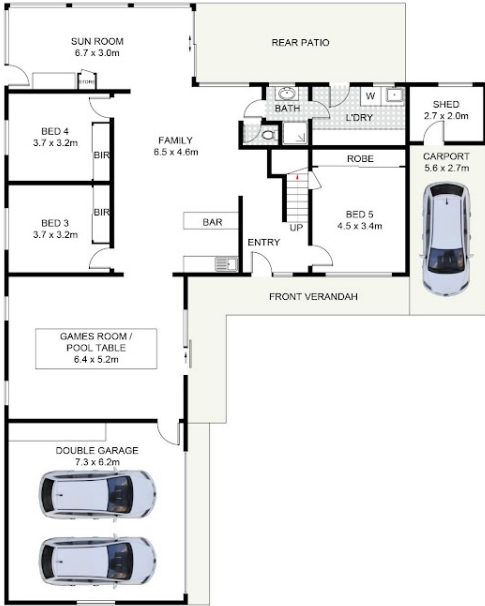

GROUND FLOOR



FIRST FLOOR

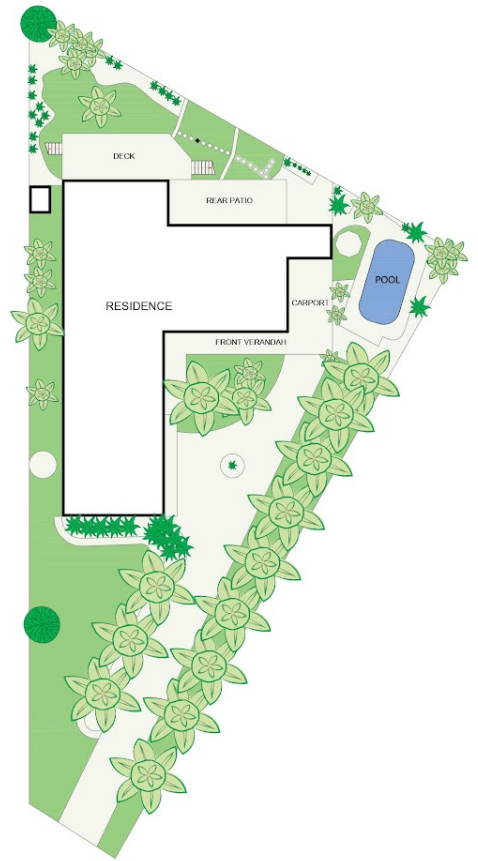

SITE PLAN  
(NOT TO SCALE)



## 30 Strawberry Close, Woolgoolga, NSW 2456

DISCLAIMER: PLANS SHOWN ARE FOR PRESENTATION PURPOSES AND ARE NOT PART OF ANY LEGAL DOCUMENT. ALL MEASUREMENTS AND FIGURES ARE APPROXIMATE.

Disclaimer: Please note this floor plan is for marketing purposes and is to be used as a guide only. All dimensions are estimates only and may not be exact measurements.