

SOLD

AFFORDABLE FAMILY HOME

CHECK OUT THIS PERFECT FAMILY HOME AT AN AFFORDABLE PRICE. LOCATED IN A GREAT LOCATION CLOSE TO MCDONALD PARK PRIMARY AND SPORTING OVALS. THE HOME IS SOLID STONE AND BRICK HOME CONSTRUCTION AND HAS SLOW COMBUSTION HEATING AND SPLIT SYSTEM AIR-CONDITIONING TO KEEP THE HOME THE RIGHT TEMPERATURE ALL YEAR ROUND. THERE IS THREE LARGE BEDROOMS UPSTAIRS' ALL WITH BUILT IN ROBES. LARGE LOUNGE ROOM WITH CEILING FAN WHICH EXTENDS INTO AN OPEN AND BRIGHT KITCHEN MEALS AREA. MODERN KITCHEN INCLUDING DISHWASHER. A SMALL FAMILY ROOM OFF THE MEALS IS GREAT AS A KIDS PLAY AREA. DOWNSTAIRS IS A 4TH BEDROOM OR GAMES ROOM IDEAL FOR THE TEENAGER. THERE IS HEAPS OF UNDER HOUSE STORAGE. A LARGE COVERED ALFRESCO AREA WITH CAFÉ BLINDS PLUS FIRE PIT AREA AND LARGE YARD IS GREAT FOR KIDS AND ENTERTAINING FAMILY AND FRIENDS. CARPORT PLUS SINGLE GARAGE KEEPS YOUR VEHICLES OUT OF THE WEATHER. JUST WALK IN AND ENJOY THIS LOVELY HOME. RLA 269823

4 BED | 1 BATH | 2 CAR

PRICE:
\$267,000

OPEN FOR INSPECTION:
N/A



Peter Dempsey
0418854393
peterdempsey@atrealty.com.au
peterdempseyatrealty.com
RLA: 269823

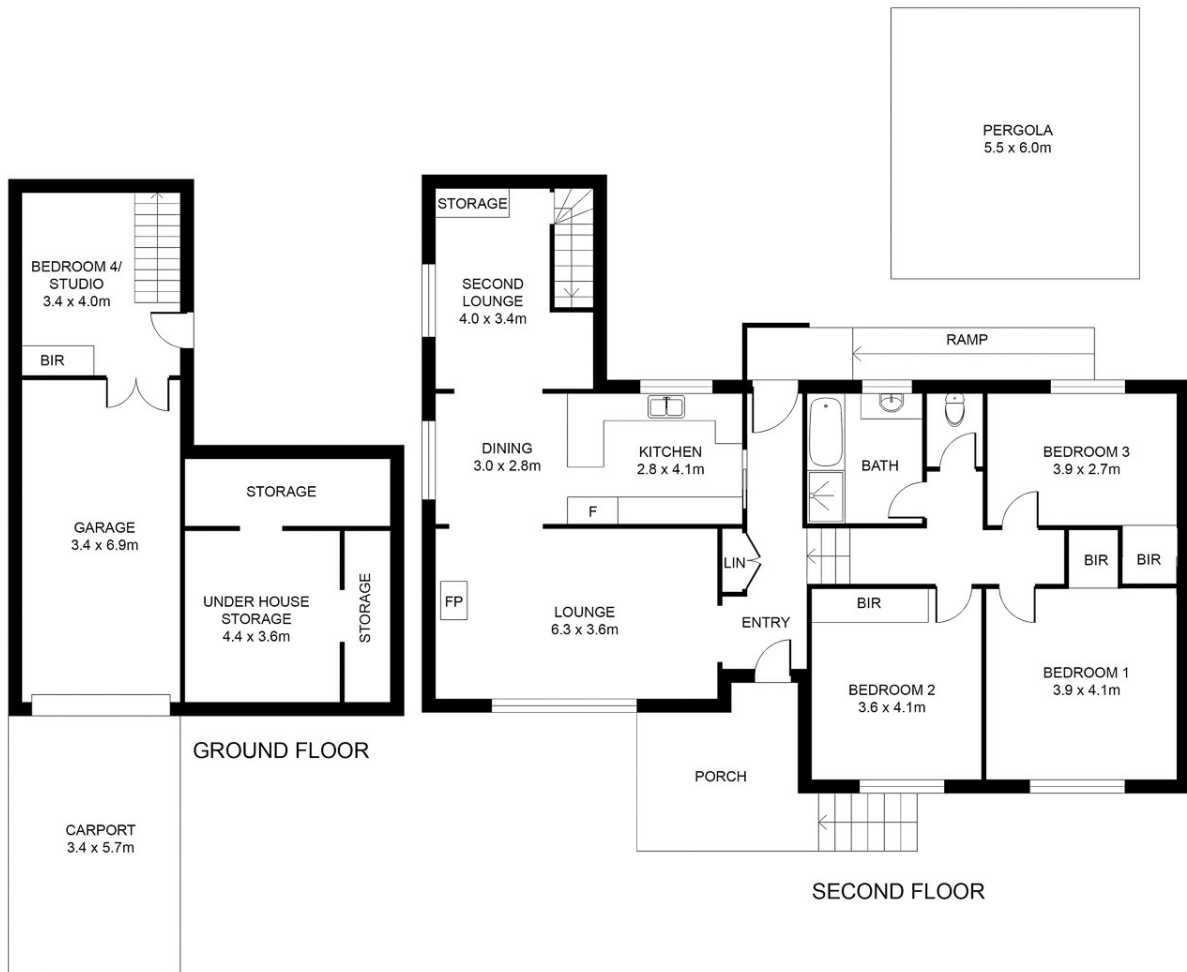

Disclaimer: Floor Plan measurements are approximate and are for illustrative purposes only. While we do not doubt the floor plans accuracy, we make no guarantee, warranty or representation as to the accuracy and completeness of the floor plan

Disclaimer: Please note this floor plan is for marketing purposes and is to be used as a guide only. All dimensions are estimates only and may not be exact measurements.