

SOLD

PICTURE PERFECT VIEWS!

Perfectly positioned on the third floor of Deep Blue 1, this stunning 2 bedroom, 2 bathroom apartment is walk in ready.

Overlooking the waters of Moreton Bay, you can see as far north as the Sunshine Coast to South of Brisbane. Just kick back and watch the most beautiful sun sets while the dolphins are being fed directly out the front!

Featuring spacious bedrooms, modern kitchen and bathrooms, large open plan living/dining area and balcony with uninterrupted views over Moreton Bay, it's hard to want more! This premium apartment has been built to the highest quality and comes fully furnished and fully self-contained.

There is a private pool for Deep Blue guests and owners only, and a single garage for each apartment with secure access.

As an owner you can also enjoy all the facilities the Resort has on offer. Two pools, (1 heated), Tennis Court, Bars, Restaurants and so much more.

Featuring –

- * Large Open Plan Living
- * Gourmet Kitchen with Stone Benches
- * 2 Large Bedrooms
- * Master has En - Suite with spa bath
- * Family Bathroom
- * Big Balcony
- * Built in BBQ with Sink & Fridge
- * Laundry
- * Ducted Air
- * 11mt x 3mt Lock up Garage with Storage

And much much more ...

Contact Juliet Ireland today to book your inspection or discuss your options!

2 BED | 2 BATH | 1 CAR

PRICE:
\$400,000

OPEN FOR INSPECTION:
N/A



Juliet Ireland
0421606878
julietireland@atrealty.com.au
Selling By The Bay

UNIT 11 - TANGALOOMA RESORT, MORETON ISLAND

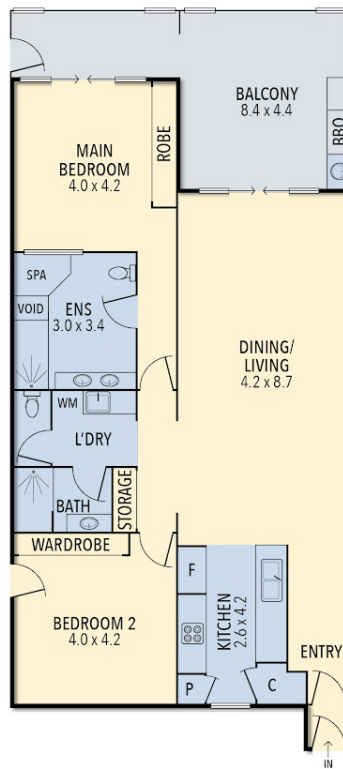

TOTAL APPROX. FLOOR AREA 142 SQ.M.

Whilst every attempt has been made to ensure accuracy of the floor plan contained here, measurements of doors, windows, rooms, and any other items are approximate and no responsibility is taken for any error, omission, or mis-statement.
This plan is for illustrative purposes only and should be used as such by any prospective purchaser. The services, systems and appliances shown have not been tested and no guarantee as to this operability or efficiency can be given.

Disclaimer: Please note this floor plan is for marketing purposes and is to be used as a guide only. All dimensions are estimates only and may not be exact measurements.