



SOLD

ATTENTION ALL INVESTORS - THIS MODERN TOWNHOUSE IS AN AMAZING BUY - PRICED TO SELL SO GET IN QUICK

CALL JACKIE TAYLOR-FOX 0411236823 OR JANINE REDWOOD 0419534436 TODAY

PULSE VILLAS are Located in a MODERN TOWNHOUSE COMPLEX in the SOUTH of BRISBANE.

PROFESSIONAL PHOTOGRAPHY COMING SOON

- * Modern and Immaculate 2 bedroom Townhouse set in Leafy Surrounds
- * Huge modern Kitchen with plenty of work space and granite topped island bench
- * European Appliances including dishwasher and 2 PAC Cabinetry
- * Large Living Dining and Lounge flows out to the balcony overlooking bushland
- * Ideal location which is Close to public transport & walking distance to train station.
- * Easy access to Logan Motorway and M1 to the GOLD COAST or Brisbane City
- * 2 bedrooms, main with modern ensuite and Air Conditioning for your comfort
- * Great size courtyard out the back plenty of room for a vege garden.
- * Complex has Half basket ball court and communal BBQ and Complex is fully gated for security.
- * Tandem car accommodation with automatic garage door with large laundry and downstairs toilet
- * Tenanted with great returns - THIS IS A MUST SEE

CALL JACKIE TAYLOR-FOX 0411236823 OR JANINE REDWOOD 0419534436 TODAY

Disclaimer: We have in preparing this information used our best endeavors to ensure that the information contained herein is true and accurate, but accept no responsibility and disclaim all liability in respect of any errors, omissions, inaccuracies or misstatements that may occur. Prospective purchasers should make their own enquiries to verify the information contained herein.

2 BED | 2 BATH | 2 CAR

PRICE:
\$210,000

OPEN FOR INSPECTION:
N/A



Jackie Taylor-Fox
0411236823
jackietaylorfox@atrealty.com.au
www.atrealty.com.au

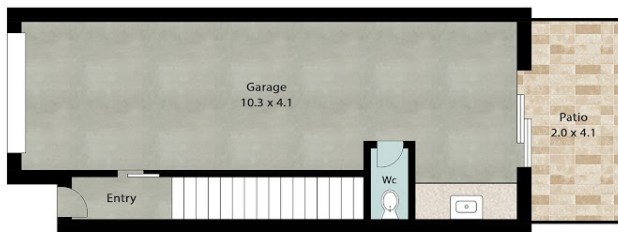

Ground Floor



First Floor



Second Floor

Unit 22 : 63 Mary St, Kingston
 INTERNAL FLOOR AREA 124m²
 EXTERNAL FLOOR AREA 16m²
 TOTAL AREA 140m²



jackie Taylor-Fox 0411 236 823

Whilst every attempt has been to ensure the accuracy of the floor plan contained here, measurements of doors, windows, rooms, and any other items are approximate and no responsibility is taken for any error, omission, or mis-statement. This is for illustrative purposes only and should be used as such by any prospective purchaser. www.picsandmortar.com

Disclaimer: Please note this floor plan is for marketing purposes and is to be used as a guide only. All dimensions are estimates only and may not be exact measurements.

Jackie Taylor-Fox
 0411236823
jackietaylorfox@atrealty.com.au
www.atrealty.com.au

