



**SOLD**

## IMMACULATELY PRESENTED PRIVATE FAMILY HOME WITH DUAL LIVING POTENTIAL

This meticulous and beautifully presented four-bedroom family home is one of only 7 backing onto a natural reserve and the beautiful weir on Windaroo Creek; this is a unique property and an opportunity not to be missed.

This home has the potential to expand and create the ultimate dual living space with ample height under the home for a second private dwelling with all plumbing and electrical services readily available making possibilities endless.

This home features:

- Double door entry
- Open plan kitchen with gas cooktop
- Quality fittings and air-conditioning throughout
- Security system
- Large timber deck for entertaining
- Double lock up garage with remote and internal access
- Room for 3 additional off-street parking spaces

Situated half-way between Brisbane and the Gold Coast this home combines indoor-outdoor living with a modern and contemporary feel. Freshly painted with new carpet in all bedrooms, you can move into this home ready for Christmas.

**4 BED | 2 BATH | 2 CAR**

**PRICE:**  
\$568,000

**OPEN FOR INSPECTION:**  
N/A



**Trent Mark**  
**0404980878**  
trent@atrealty.com.au  
[www.atrealty.com.au](http://www.atrealty.com.au)

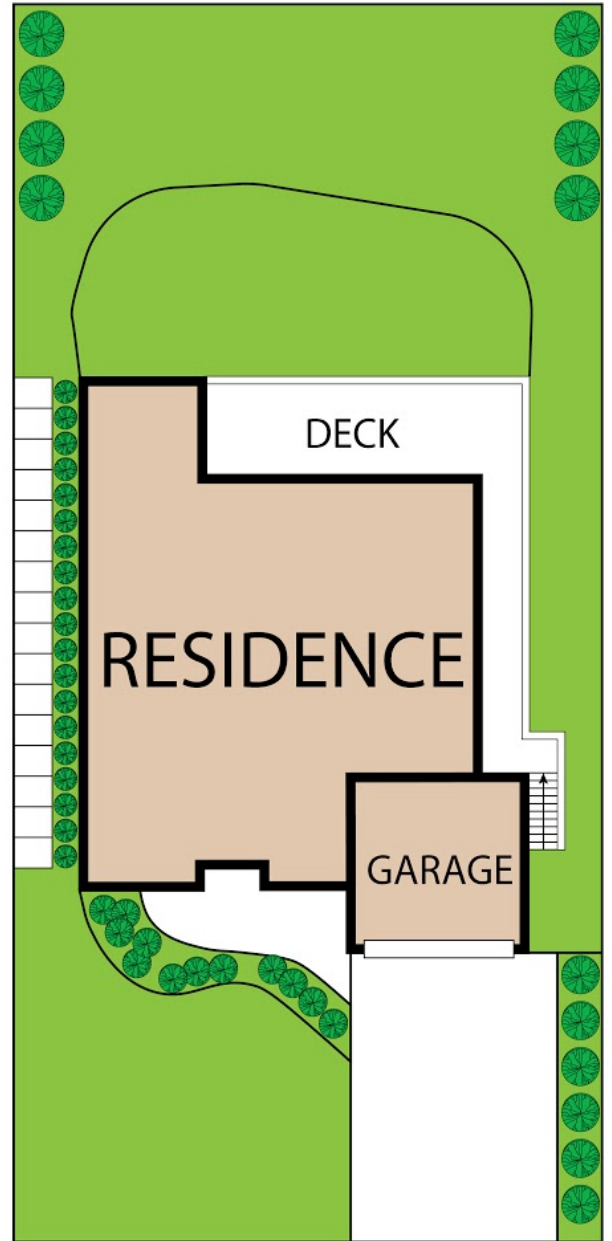

Disclaimer: Please note this floor plan is for marketing purposes and is to be used as a guide only. All dimensions are estimates only and may not be exact measurements.