



**SOLD**

## LOCATION, PRESENTATION AND PRICE... TICK TICK TICK!

Presenting to the market this meticulously maintained lowset owner occupied four bedroom steel frame home ideally located directly opposite a very tranquil greenspace/parkland. Whether you are a first homebuyer, downsizer or investor this property is a must see with two living spaces and an inviting outdoor alfresco area this one will tick the boxes for sure!

As soon as you enter this fabulous home, you will be impressed with every aspect of the design which has been put together with functionality in mind. The open plan style ensures the air-conditioned living area is the hub of the home, while the kitchen remains a real focal point with waterfall stone benchtops and stainless appliances including a dishwasher. The family cook can indulge their culinary flair, while still being a part of the action. The breakfast bar is the perfect spot for friends and family to gather for a chat and some nibbles!

This home boasts four bedrooms all with built in robes, a massive master with walk in robe and superb light filled ensuite and sliding door to the covered alfresco entertaining area.

With so much on offer this property will not last long, don't delay call Natalie today on 0419 689 309 to organise an inspection.

- At a glance:
- Fully Fenced 450m2 Block
  - Low Maintenance
  - Two Living Areas
  - Air-Conditioning
  - Stone Bench Tops
  - Steel Frame
  - Solar – 1.5kw
  - Water Tank x 3
  - New Hot Water System
  - NBN
  - Parkland Outlook

**4 BED | 2 BATH | 2 CAR**

**PRICE:**  
\$535,000

**OPEN FOR INSPECTION:**  
N/A



**Natalie Johnston**  
**0419689309**  
natalie@atrealty.com.au  
[Natalieatrealty](https://www.atrealty.com.au)

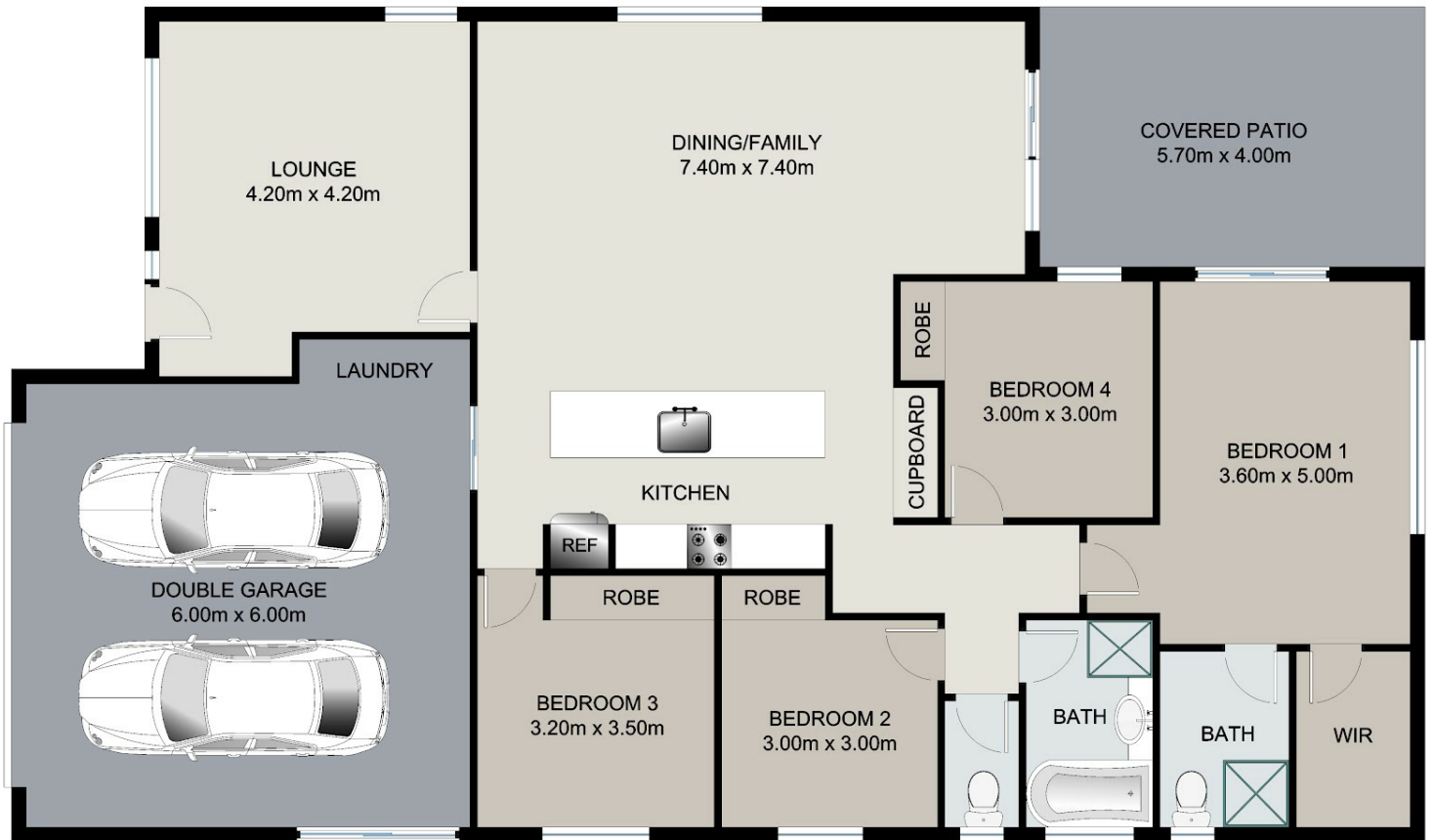

APPROXIMATE TOTAL SURFACE AREA = 172.85 SQ M

Disclaimer: Please note this floor plan is for marketing purposes and is to be used as a guide only. All dimensions are estimates only and may not be exact measurements.